

**NEW MEXICO OIL CONSERVATION COMMISSION
WELL LOCATION AND ACREAGE DEDICATION PLAT**

All distances must be from the center line of the Section

Operator H.W. PACE			Lease			Florida PG State			Well No. 1		
First Letter L	Section 35	Township 7 South	Range 35 East	County Roosevelt							
Actual Footage Location of Well:											
1980 feet from the		South		line and		660 feet from the		West		line	
Ground Level Elev. 4193.0		Producing Formation San Andres				Pool Todd				Dedicated Acreage 160	

1. Outline the acreage dedicated to the subject well by colored pencil or hatchure marks on the plat below.
2. If more than one lease is dedicated to the well, outline each and identify the ownership thereof (both as to working interest and royalty).
3. If more than one lease of different ownership is dedicated to the well, have the interests of all owners been consolidated by communitization, unitization, force-pooling, etc?

☐ Yes ☐ No If answer is "yes," type of consolidation _____

If answer is "no," list the owners and tract descriptions which have actually been consolidated. (Use reverse side of this form if necessary.) _____

No allowable will be assigned to the well until all interests have been consolidated (by communitization, unitization, forced-pooling, or otherwise) or until a non-standard unit, eliminating such interests, has been approved by the Commission.

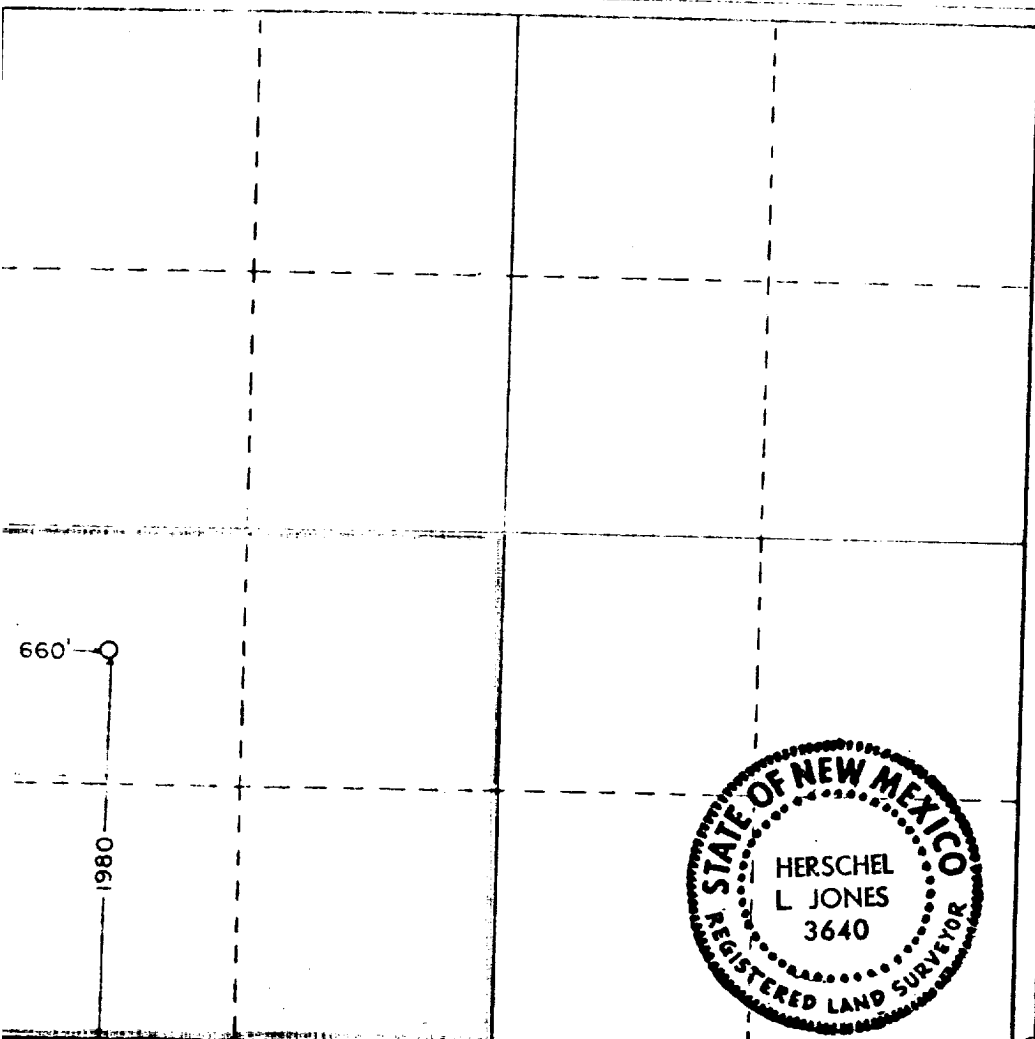

CERTIFICATION

I hereby certify that the information contained herein is true and complete to the best of my knowledge and belief.

Name _____

Operator
Position _____

H. W. Pace

Company _____

8/24/81

Date _____

I hereby certify that the well location shown on this plat was plotted from field notes of actual surveys made by me or under my supervision, and that the same is true and correct to the best of my knowledge and belief.

Date Surveyed _____

August 18, 1981

Registered Professional Engineer
and/or Land Surveyor

Herschel L. Jones

Certificate No. _____

330 660 990 1320 1680 1980 2310 2640 2970 3300 3630 3960 4290 4620 4950 5280 5610 5940 6270 6600