

30-041-20627

NO. OF COPIES RECEIVED	
DISTRIBUTION	
SANTA FE	
FILE	
U.S.G.S.	
LAND OFFICE	
OPERATOR	

NEW MEXICO OIL CONSERVATION COMMISSION

Form C-101
Revised 1-1-65

5A. Indicate Type of Lease
STATE ☐ FEE ☒

5. State Oil & Gas Lease No.

APPLICATION FOR PERMIT TO DRILL, DEEPEN, OR PLUG BACK

a. Type of Work

b. Type of Well
 DRILL ☒ DEEPEN ☐ PLUG BACK ☐
 OIL WELL ☐ GAS WELL ☐ OTHER ☐ SINGLE ZONE ☐ MULTIPLE ZONE ☐

c. Name of Operator

Harper Oil Company

d. Address of Operator

904 Hightower Bldg., Oklahoma City, Oklahoma 73102

e. Location of Well

UNIT LETTER F LOCATED 1980 FEET FROM THE North LINE
 AND 660 FEET FROM THE West LINE 19 8 South 34 East 660

7. Unit Agreement Name

8. Name of Lease Name

Cady

9. Well No.

1

10. Section, Township, or Range

Undesignated

12. County

Roosevelt

21. Elevations (Show whether DP, RI, etc.)

4319.2 Ground

21A. Estimated Reservoir Pressure

\$50,000 Blanket

21B. Proposed Depth

9300

21C. Formation

Bough

21D. Rotary or C.T.T.

Rotary

21E. Drilling Contractor

Worton Drilling Co.

22. Approx. Date Work will start

11-19-81

PROPOSED CASING AND CEMENT PROGRAM

SIZE OF HOLE	SIZE OF CASING	WEIGHT PER FOOT	SETTING DEPTH	SACKS OF CEMENT	EST. TOP
17 1/2	13 3/8	48#	400	375	Circulate
12 1/4	8 5/8	24 and 28	3900	2500	Circulate
7 7/8	5 1/2	15.5 & 17	9300	500	To 7000

The following B O P equipment will be used on this well:

1. 3000# W P double ram preventer.
2. 2" Choke and kill manifold.
3. Remote closing valves for B O P.

IN ABOVE SPACE DESCRIBE PROPOSED PROGRAM IF PROPOSAL IS TO DEEPEN OR PLUG BACK, GIVE DATA ON PRESENT PRODUCTIVE ZONE AND PROPOSED NEW PRODUCTIVE ZONE. GIVE BLOWOUT PREVENTER PROGRAM, IF ANY.

I hereby certify that the information above is true and complete to the best of my knowledge and belief.

Signed John W. West Title Agent Date November 19, 1981

(This space for State Use)

APPROVED BY Lee Clench TITLE Agent DATE November 19, 1981

CONDITIONS OF APPROVAL, IF ANY:

NEW MEXICO OIL CONSERVATION COMMISSION
WELL LOCATION AND ACREAGE DEDICATION PLAT

Form C-102
Supersedes C-128
Effective 1-1-65

All distances must be from the outer boundaries of the Section

Operator Harper Oil Company			Lease Cady		Well No. 1
Unit Letter F	Section 19	Township 8 South	Range 34 East	County Roosevelt	
Actual Footage Location of Well: 1980 feet from the north line and 660 feet from the west line					
Ground Level Elev. 4319.2'	Producing Formation Bough		Pool J. Milnes and Hunt		Dedicated Acreage: 50.26 Acres

1. Outline the acreage dedicated to the subject well by colored pencil or hachure marks on the plat below.
2. If more than one lease is dedicated to the well, outline each and identify the ownership thereof (both as to working interest and royalty).
3. If more than one lease of different ownership is dedicated to the well, have the interests of all owners been consolidated by communitization, unitization, force-pooling, etc?

☐ Yes ☐ No If answer is "yes," type of consolidation _____

If answer is "no," list the owners and tract descriptions which have actually been consolidated. (Use reverse side of this form if necessary.) _____

No allowable will be assigned to the well until all interests have been consolidated (by communitization, unitization, forced-pooling, or otherwise) or until a non-standard unit, eliminating such interests, has been approved by the Commission.

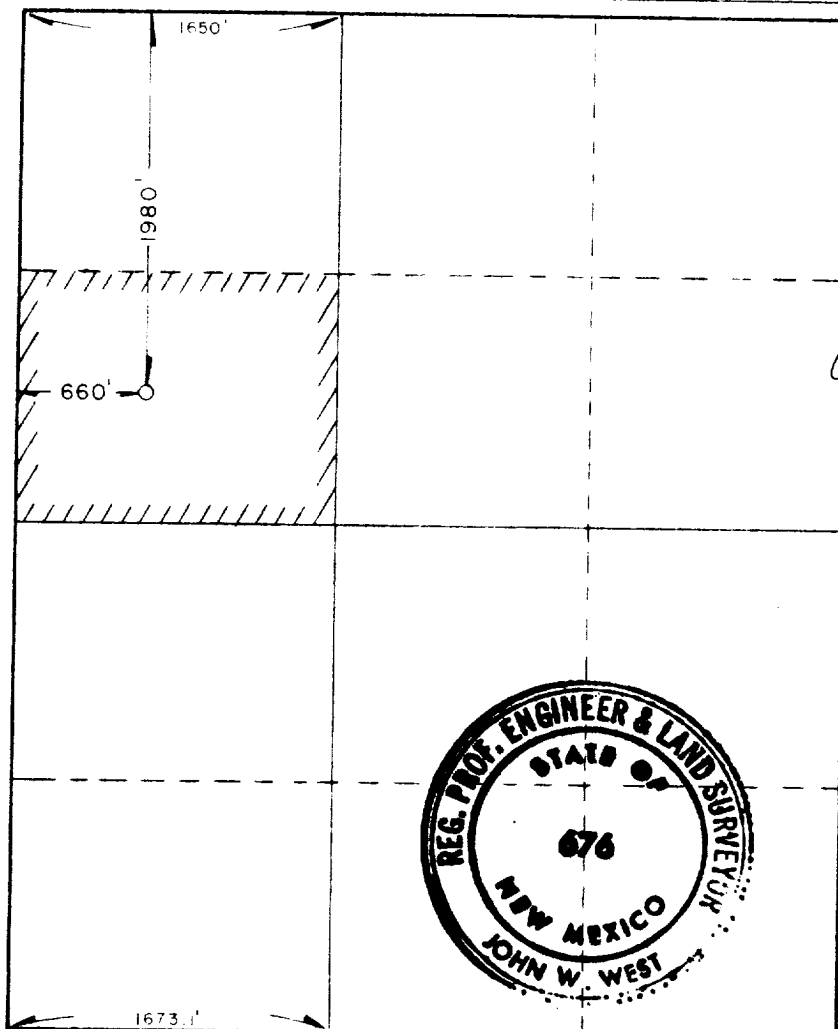

CERTIFICATION

I hereby certify that the information contained herein is true and complete to the best of my knowledge and belief.

Name *John W. West*

Position
Agent

Company
Harper Oil Company

Date
11-19-81

I hereby certify that the well location shown on this plat was plotted from field notes of actual surveys made by me or under my supervision, and that the same is true and correct to the best of my knowledge and belief.

Date Surveyed
11-18-81

Registered Professional Engineer and/or Land Surveyor

John W. West
Certificate No. **JOHN W. WEST 676**
PATRICK A. ROMERO 6865
Ronald J. Eidson 3230

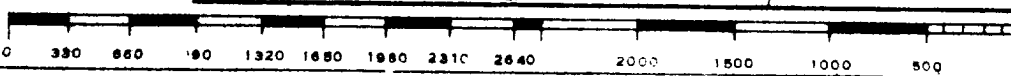

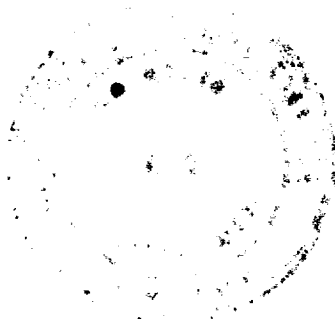

ELF

Amount Band Log
3/10/82