

N. M. GEOL. SURV. COMMISSION
P. O. BOX 1980
HOBBS, NEW MEXICO 88240SUBMIT IN TRIP
(Other instructive
reverse side)Form approved.
Budget Bureau No. 42-R1425.UNITED STATES
DEPARTMENT OF THE INTERIOR
GEOLOGICAL SURVEY

APPLICATION FOR PERMIT TO DRILL, DEEPEN, OR PLUG BACK

1a. TYPE OF WORK
DRILL ☒ DEEPEN ☐ PLUG BACK ☐b. TYPE OF WELL
OIL WELL ☐ GAS WELL ☒ OTHER ☐
SINGLE ZONE ☒ MULTIPLE ZONE ☐

2. NAME OF OPERATOR

H. L. BROWN, JR.

3. ADDRESS OF OPERATOR

P. O. BOX 2237 MIDLAND, TEXAS 79702

4. LOCATION OF WELL (Report location clearly and in accordance with any State requirements.*)

At surface
UNIT O, 330' FSL & 2310' FEL, SEC 34, T-7S, R-37E

At proposed prod. zone

UNIT O, 330' FSL & 2310' FEL, SEC 34, T-7S, R-37E

14. DISTANCE IN MILES AND DIRECTION FROM NEAREST TOWN OR POST OFFICE*

12 MILES EAST OF MILNESAN, NEW MEXICO

15. DISTANCE FROM PROPOSED*
LOCATION TO NEAREST
PROPERTY OR LEASE LINE, FT.
(Also to nearest drlg. unit line, if any)

16. NO. OF ACRES IN LEASE

800

17. NO. OF ACRES ASSIGNED
TO THIS WELL

320

18. DISTANCE FROM PROPOSED LOCATION*
TO NEAREST WELL, DRILLING, COMPLETED,
OR APPLIED FOR, ON THIS LEASE, FT.

19. PROPOSED DEPTH

8300'

20. ROTARY OR CABLE TOOLS

ROTARY

21. ELEVATIONS (Show whether DF, RT, GR, etc.)

4058.3 GL

22. APPROX. DATE WORK WILL START*

FEBRUARY 20, 1982

23. PROPOSED CASING AND CEMENTING PROGRAM

SIZE OF HOLE	SIZE OF CASING	WEIGHT PER FOOT	SETTING DEPTH	QUANTITY OF CEMENT
17-1/2"	13-3/8"	48#	500'	CIRC TO SURFACE
12-1/4"	8-5/8"	24 & 32#	3800'	CIRC TO SURFACE
7-7/8"	4-1/2"	10.5#	8300'	EST TOP @ 5400'

PROPOSE TO DRILL TO WOLFCAMP USING ROTARY TOOLS TO APPROXIMATELY 8300'
CEMENT WILL BE CIRCULATED ON 13-3/8" & 8-5/8" CASING STRINGS. A
COMPLETION WILL BE MADE IN THE BLUITT (WOLFCAMP) GAS-CONDENSATE POOL @
APPROXIMATELY 8100'. COMPLETION OR ABANDONMENT WILL BE PERFORMED IN
ACCORDANCE WITH PRODDENT PRACTICES AND REGULATORY REQUIREMENTS. A DOUBLE
RAM SERIES 900 BOP AND CHOKE MANIFOLD WILL BE USED FROM 8-5/8" CASING TO
TOTAL DEPTH.

HAVE RECEIVED APPROVAL FOR UNORTHODOX LOCATION. REF: CASE NO. 7381

GAS IS DEDICATED.

RECEIVED

ORDER NO. R-6828

JAN 20 1982

IN ABOVE SPACE DESCRIBE PROPOSED PROGRAM: If proposal is to deepen or plug back, give data on present productive zone and proposed new productive zone. If proposal is to drill or deepen directionally, give pertinent data on direction, location and measured and true vertical depths. Give blowout preventer program, if any.

24.

SIGNED

C. Englem

TITLE

DRILLING SUPERINTENDANT DATE JANUARY 10, 1982

(This space for Federal or State office use)

APPROVED

PERMIT NO.

APPROVED BY

FEB 26 1982

CONDITIONS OF APPROVAL

JAMES A. GILHAM
DISTRICT SUPERVISORAPPROVAL SUBJECT TO
GENERAL REQUIREMENTS AND
SPECIAL STIPULATIONS
ATTACHED

APPROVAL DATE JAN 21 1982

DATE

*See Instructions On Reverse Side

NEW MEXICO OIL CONSERVATION COMMISSION
WELL LOCATION AND ACREAGE DEDICATION PLAT

Form 1-7-79
Supersedes C-128
Effective 1-1-80

All distances must be from the outer boundaries of the Section

Operator H.L. Brown Jr.		Lease Federal K		Well No. 1	
Section 0	Section 34	Township 7 South	Range 37 East	County Roosevelt	
Distance from Section Center to Well: 330 feet from the South line and 2310 feet from the East line					
Ground Level Elev. 4058.3	Producing Formation Wolfcamp	Pool Bluitt (Wolfcamp)	Dedicated Acreage 320		

1. Outline the acreage dedicated to the subject well by colored pencil or hatchure marks on the plat below.
2. If more than one lease is dedicated to the well, outline each and identify the ownership thereof (both as to working interest and royalty).
3. If more than one lease of different ownership is dedicated to the well, have the interests of all owners been consolidated by communitization, unitization, force-pooling, etc?

☐ Yes ☐ No If answer is "yes," type of consolidation _____

If answer is "no," list the owners and tract descriptions which have actually been consolidated. (Use reverse side of this form if necessary.) _____

No allowable will be assigned to the well until all interests have been consolidated (by communitization, unitization, forced-pooling, or otherwise) or until a non-standard unit, eliminating such interests, has been approved by the Commission.

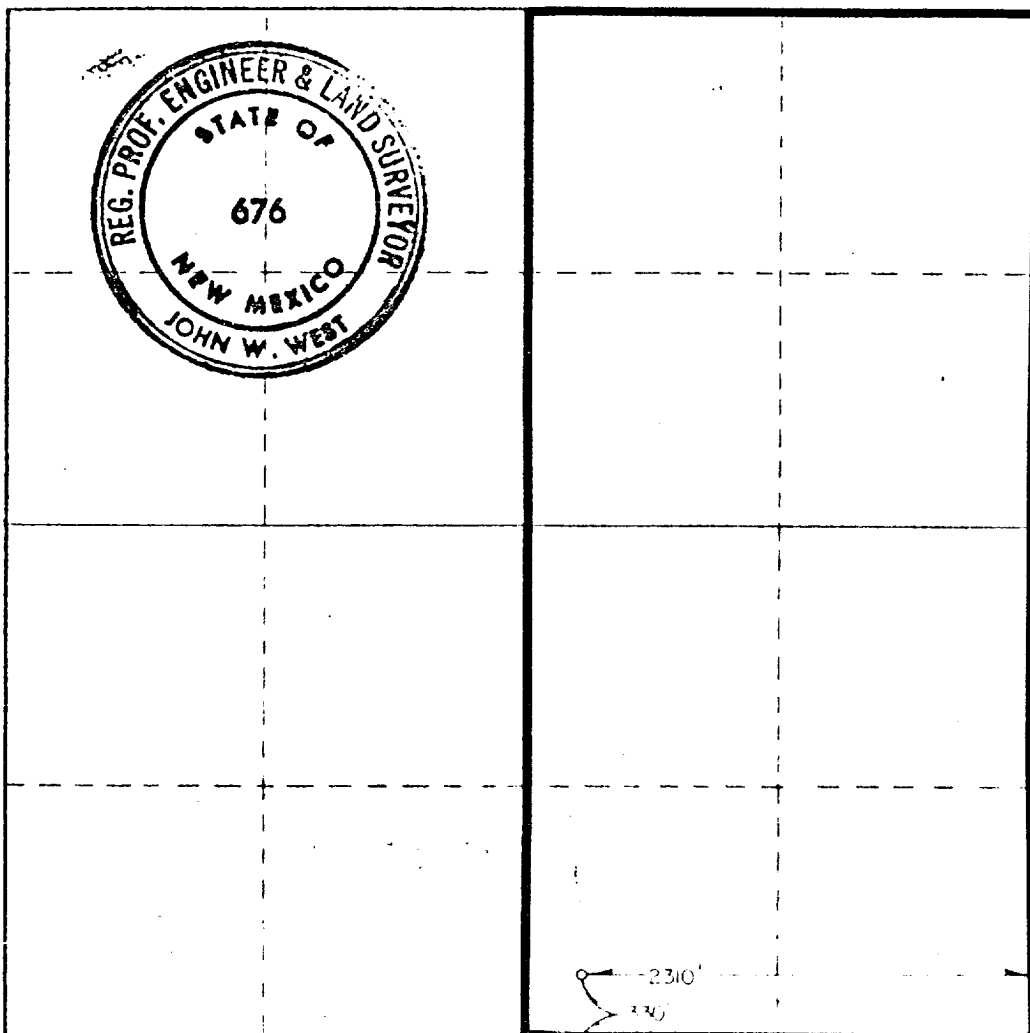
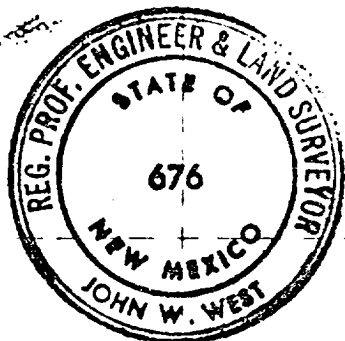

CERTIFICATION

I hereby certify that the information contained herein is true and complete to the best of my knowledge and belief.

R. E. Frailey
Name

R. E. Frailey

Position

Drilling Superintendent

Company

H. L. Brown, Jr.

Date

1-6-82

I hereby certify that the well location shown on this plat was plotted from field notes of actual surveys made by me or under my supervision, and that the same is true and correct to the best of my knowledge and belief.

Date Surveyed

12/9/81

Registration of plat and location of well in public records

John W. West

Certified by: JOHN W. WEST 676
PATRICK A. ROMERO 6885
Ronald J. Eidson 3232

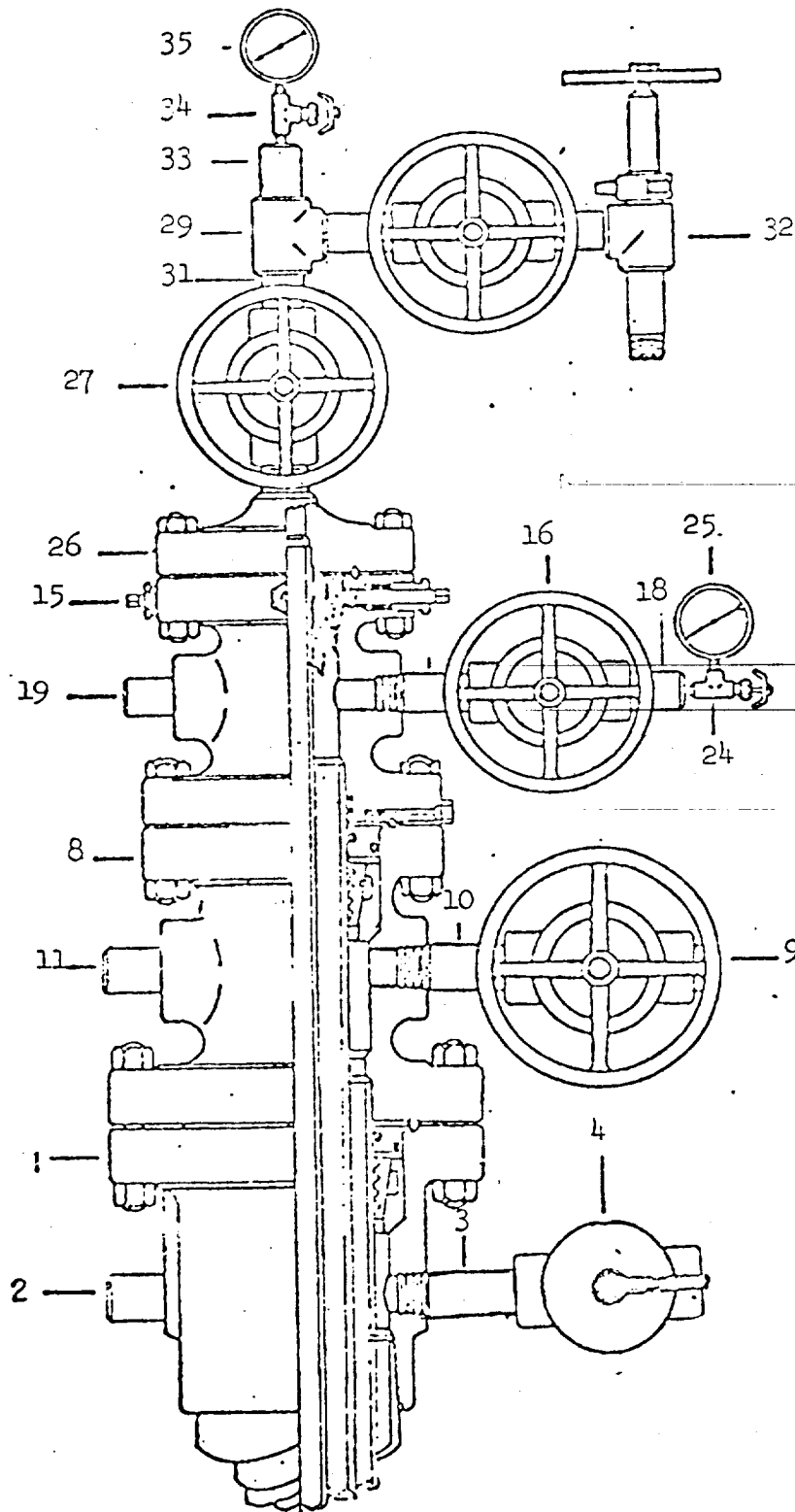

PROPOSED WELLHEAD PLAN FOR THE FEDERAL "K" #1

PROPERTY
OF



FMC Corporation
Petroleum Equipment Division
Wellhead Equipment Operation

C.C.T
Houston, Texas

DATE

DRG.

FILE NO.

PART NO.

H.L. BROWN JR.

RECEIVED

MAR 11 1962

O. C. O.
HOBBS OFFICE

173