

30-041-20676

NO. OF COPIES RECEIVED	
DISTRIBUTION	
SANTA FE	
FILE	
U.S.G.S.	
LAND OFFICE	
OPERATOR	

NEW MEXICO OIL CONSERVATION COMMISSION

Form C-101
Revised 1-1-65

5A. Indicate Type of Lease
STATE ☐ FEE ☒

5. State Oil & Gas Lease No.

APPLICATION FOR PERMIT TO DRILL, DEEPEN, OR PLUG BACK

1a. Type of Work		7. Unit Agreement Name	
b. Type of Well OIL WELL <input checked="" type="checkbox"/> GAS WELL <input type="checkbox"/> OTHER <input type="checkbox"/> DRILL <input checked="" type="checkbox"/> DEEPEN <input type="checkbox"/> PLUG BACK <input type="checkbox"/> SINGLE ZONE <input checked="" type="checkbox"/> MULTIPLE ZONE <input type="checkbox"/>		8. Farm or Lease Name Twin A	
2. Name of Operator Cities Service Oil and Gas Corporation		9. Well No. 1	
3. Address of Operator P.O. Box 1919 - Midland, Texas 79702		10. Field and Pool, or Wildcat Wildcat	
4. Location of Well UNIT LETTER A LOCATED 660 FEET FROM THE North LINE AND 990 FEET FROM THE East LINE OF SEC. 3 TWP. 8S RGE. 34E NMPM		12. County Roosevelt	
19. Proposed Depth 10,940'		19A. Formation Siluro-Dev.	20. Rotary or C.T. Rotary
21. Elevations (Show whether DF, RT, etc.) 4283' GR	21A. Kind & Status Plug. Bond Required/Approved	21B. Drilling Contractor Warton Drilling Co.	22. Approx. Date Work will start May 5, 1983

23.

PROPOSED CASING AND CEMENT PROGRAM

SIZE OF HOLE	SIZE OF CASING	WEIGHT PER FOOT	SETTING DEPTH	SACKS OF CEMENT	EST. TOP
17-1/2"	13-3/8"	48#	350'	350	Circulated
12-1/4"	8-5/8"	32#	3850'	1750	Circulated
7-7/8"	5-1/2"	17 & 20#	10940'	700	6500'

It is proposed to drill this well to a T.D. of 10940' and test the Siluro-Devonian Formation. The blowout prevention program is as follows:

1. One set of blind rams.
2. One set of drill pipe rams.
3. One Hydril.
4. One rotating head.

The acreage assigned to this well is not dedicated to any gas purchaser.

APPROVAL VALID FOR 180 DAYS
PERMIT EXPIRES 1/3/83
UNLESS DRILLING UNDERWAY

IN ABOVE SPACE DESCRIBE PROPOSED PROGRAM: IF PROPOSAL IS TO DEEPEN OR PLUG BACK, GIVE DATA ON PRESENT PRODUCTIVE ZONE AND PROPOSED NEW PRODUCTIVE ZONE. GIVE BLOWOUT PREVENTER PROGRAM, IF ANY.

I hereby certify that the information above is true and complete to the best of my knowledge and belief.

Signed Elmer Startz Title Region Operations Mgr. - Prod. Date May 2, 1983

ORIGINAL SIGNED BY JERRY SEXTON
DISTRICT I SUPERVISOR

APPROVED BY _____ TITLE _____ DATE MAY 4 1983

CONDITIONS OF APPROVAL, IF ANY:

RECEIVED
MAY 2 1983
C.C.D.
HOBBS OFFICE

NEW MEXICO OIL CONSERVATION COMMISSION
WELL LOCATION AND ACREAGE DEDICATION PLAT

Form C-102
Supersedes C-128
Effective 1-1-65

All distances must be from the outer boundaries of the Section.

Operator <i>Cities Service Oil & Gas Corp.</i>		Lease Twin A		Well No. 1
Unit Letter A	Section 3	Township 8 South	Range 34 East	County Roosevelt
Actual Footage Location of Well: 660 feet from the North line and 990 feet from the East line				
Ground Level Elev. 4283.1'	Producing Formation Siluro-Devonian	Pool Wildcat	Dedicated Acreage: 40 Acres	

1. Outline the acreage dedicated to the subject well by colored pencil or hachure marks on the plat below.
2. If more than one lease is dedicated to the well, outline each and identify the ownership thereof (both as to working interest and royalty).
3. If more than one lease of different ownership is dedicated to the well, have the interests of all owners been consolidated by communitization, unitization, force-pooling, etc?

☐ Yes ☐ No If answer is "yes," type of consolidation _____

If answer is "no," list the owners and tract descriptions which have actually been consolidated. (Use reverse side of this form if necessary.) _____

No allowable will be assigned to the well until all interests have been consolidated (by communitization, unitization, forced-pooling, or otherwise) or until a non-standard unit, eliminating such interests, has been approved by the Commission.

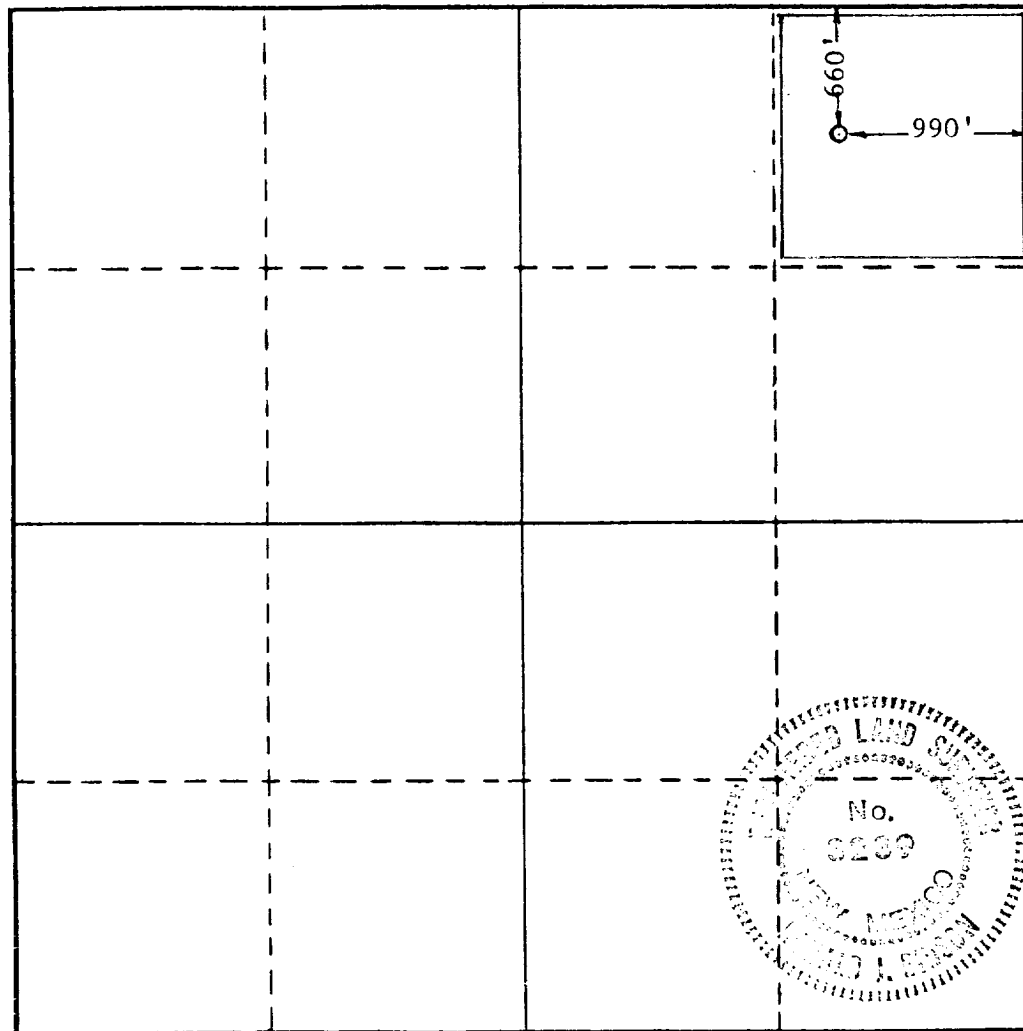

CERTIFICATION

I hereby certify that the information contained herein is true and complete to the best of my knowledge and belief.

Name *Elmer Stutz*
Position
Reg. Opr. Mgr. - Prod.
Company *Cities Service Oil & Gas Corp.*
Date
May 2, 1983

I hereby certify that the well location shown on this plat was plotted from field notes of actual surveys made by me or under my supervision, and that the same is true and correct to the best of my knowledge and belief.

Date Surveyed
April 29, 1983
Registered Professional Engineer and/or Land Surveyor
Ronald J. Eidson
Certificate No. JOHN W. WEST 878
PATRICK A. ROMERO 6563
Ronald J. Eidson 3239

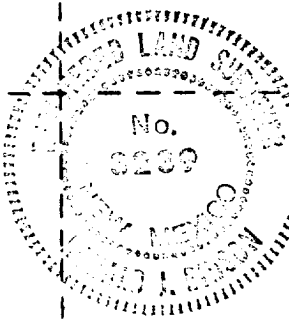

173

RECEIVED
MAY 2 1983
HARRIS W. HICE