

UNITED STATES  
DEPARTMENT OF THE INTERIOR  
GEOLOGICAL SURVEY

30-041-20678

## APPLICATION FOR PERMIT TO DRILL, DEEPEN, OR PLUG BACK

1a. TYPE OF WORK DRILL <input checked="" type="checkbox"/> DEEPEN <input type="checkbox"/> PLUG BACK <input type="checkbox"/>			5. LEASE DESIGNATION AND SERIAL NO. NM 18518		
b. TYPE OF WELL OIL WELL <input checked="" type="checkbox"/> GAS WELL <input type="checkbox"/> OTHER <input type="checkbox"/>			6. IF INDIAN, ALLOTTEE OR TRIBE NAME		
2. NAME OF OPERATOR Hillin Production Company			7. UNIT AGREEMENT NAME		
3. ADDRESS OF OPERATOR P.O. Box 152, Odessa, Texas 79760			8. FARM OR LEASE NAME Kochergen		
4. LOCATION OF WELL (Report location clearly and in accordance with any State requirements*) At surface 1980' FSL & 660' FEL At proposed prod. zone San Andres			9. WELL NO. 1		
14. DISTANCE IN MILES AND DIRECTION FROM NEAREST TOWN OR POST OFFICE* 4 miles east of Milnesand, New Mexico			10. FIELD AND POOL, OR WILDCAT UNDESIGNATED		
15. DISTANCE FROM PROPOSED* LOCATION TO NEAREST PROPERTY OR LEASE LINE, FT. (Also to nearest drlg. unit line, if any) 660'			11. SEC., T., R., M., OR BLK. AND SURVEY OR AREA Unit I, Sec. 8, T-8-S, R-36-E		
16. NO. OF ACRES IN LEASE 1,157.90			12. COUNTY OR PARISH Roosevelt		
17. NO. OF ACRES ASSIGNED TO THIS WELL 40			13. STATE N.M.		
18. DISTANCE FROM PROPOSED LOCATION* TO NEAREST WELL, DRILLING, COMPLETED, OR APPLIED FOR, ON THIS LEASE, FT. Approx. 2640'			20. ROTARY OR CABLE TOOLS Rotary		
21. ELEVATIONS (Show whether DF, RT, GR, etc.) 4119.4 GR			22. APPROX. DATE WORK WILL START* 5-31-83		

## 23. PROPOSED CASING AND CEMENTING PROGRAM

SIZE OF HOLE	SIZE OF CASING	WEIGHT PER FOOT	SETTING DEPTH	QUANTITY OF CEMENT
12 1/4"	8 5/8"	24#	± 400'	Circ. to surface
7 7/8"	4 1/2 or 5 1/2	9.5 or 15.5	5100'	250 sx.

1. Spud mud to ±400', set and cement 8 5/8" surface casing.
2. Install 10"-900 Series Hydraulic BOP's with pipe and blind rams.
3. Drill well to 5100', log and run casing and cement same for completion.

RECEIVED

MAY 16 1983

OIL &amp; GAS

IN ABOVE SPACE DESCRIBE PROPOSED PROGRAM: If proposal is to deepen or plug back, give data on present production and proposed new productive zone. If proposal is to drill or deepen directionally, give pertinent data on subsurface locations and measured and true vertical depths. Give blowout preventer program, if any.

24. SIGNED John D. Boyell TITLE Production Engineer DATE 5-12-83  
(This space for Federal or State office use)

PERMIT NO. \_\_\_\_\_ APPROVAL DATE \_\_\_\_\_

APPROVED BY A. A. Boyer TITLE Acting Asst. District Engineer for Operations DATE 5/24/83  
CONDITIONS OF APPROVAL, IF ANY: \_\_\_\_\_

**NEW MEXICO OIL CONSERVATION COMMISSION  
WELL LOCATION AND ACREAGE DEDICATION PLAT**

Form C-102  
Supersedes C-128  
Effective 1-4-65

All distances must be from the outer boundaries of the Section.

Operator <b>HILLIN PRODUCTION COMPANY</b>			Lease <b>KOCHERGEN</b>		Well No. <b>1</b>
Unit Letter <b>I</b>	Section <b>8</b>	Township <b>8 South</b>	Range <b>36 East</b>	County <b>Roosevelt</b>	
Actual Footage Location of Well:					
<b>1980</b> feet from the <b>South</b> line and <b>660</b> feet from the <b>East</b> line					
Ground Level Elev. <b>4119.4</b>	Producing Formation <b>San Andres</b>	Pool <b>UNDESIGNATED</b>		Dedicated Acreage: <b>40</b> Acres	

1. Outline the acreage dedicated to the subject well by colored pencil or hachure marks on the plat below.
2. If more than one lease is dedicated to the well, outline each and identify the ownership thereof (both as to working interest and royalty).
3. If more than one lease of different ownership is dedicated to the well, have the interests of all owners been consolidated by communitization, unitization, force-pooling, etc?

☐ Yes    ☒ No    If answer is "yes," type of consolidation \_\_\_\_\_

If answer is "no," list the owners and tract descriptions which have actually been consolidated. (Use reverse side of this form if necessary.) \_\_\_\_\_ N/A

No allowable will be assigned to the well until all interests have been consolidated (by communitization, unitization, forced-pooling, or otherwise) or until a non-standard unit, eliminating such interests, has been approved by the Commission.

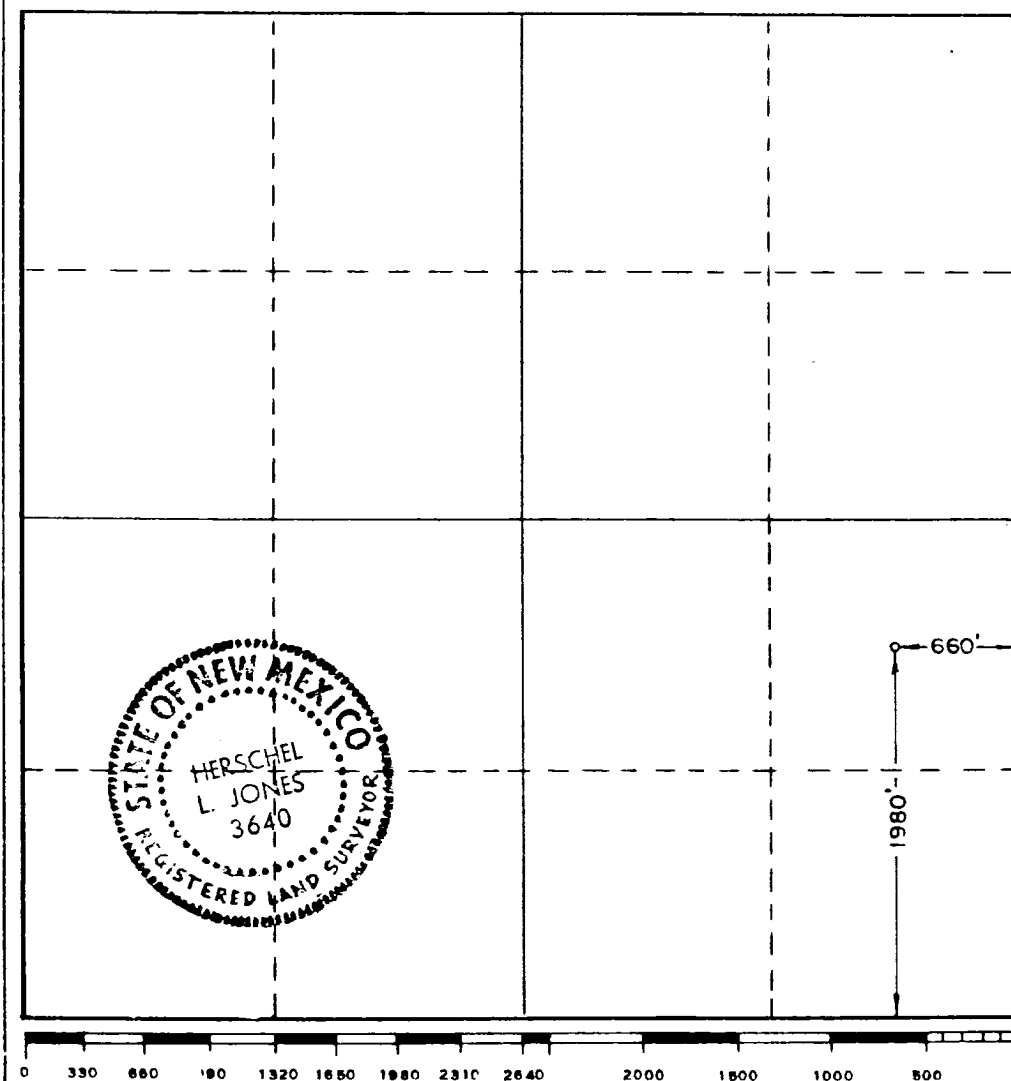

**CERTIFICATION**

*I hereby certify that the information contained herein is true and complete to the best of my knowledge and belief.*

Name  
**John D. Boxell**

Position  
**Production Engineer**

Company  
**Hillin Production Co.**

Date  
**May 9, 1983**

*I hereby certify that the well location shown on this plat was plotted from field notes of actual surveys made by me or under my supervision, and that the same is true and correct to the best of my knowledge and belief.*

Date Surveyed  
**4/28/83**

Registered Professional Engineer and/or Land Surveyor  
*Herschel L. Jones*

Certificate No. **3640**