

NO. OF COPIES RECEIVED	
DISTRIBUTION	
SANTA FE	
FILE	
U.S.G.S.	
LAND OFFICE	
OPERATOR	

5A. Indicate Type of Lease	
STATE <input type="checkbox"/>	FEE <input checked="" type="checkbox"/>

5. State Oil &amp; Gas Lease No.

## APPLICATION FOR PERMIT TO DRILL, DEEPEN, OR PLUG BACK

1a. Type of Work DRILL <input checked="" type="checkbox"/> DEEPEN <input type="checkbox"/> PLUG BACK <input type="checkbox"/>		7. Unit Agreement Name
b. Type of Well OIL WELL <input checked="" type="checkbox"/> GAS WELL <input type="checkbox"/> OTHER <input type="checkbox"/> SINGLE ZONE <input checked="" type="checkbox"/> MULTIPLE ZONE <input type="checkbox"/>		8. Farm or Lease Name Hefflefinger
2. Name of Operator Brazos Petroleum Company		9. Well No. 2
3. Address of Operator P. O. Box 1782, Midland, Texas 79702		10. Field and Pool, or Wildcat Chaveroo-San Andres
4. Location of Well UNIT LETTER <u>D</u> LOCATED <u>860</u> FEET FROM THE <u>North</u> LINE AND <u>660</u> FEET FROM THE <u>West</u> LINE OF SEC. <u>35</u> TWP. <u>7-S</u> RGE. <u>32-E</u> NMPM		12. County Roosevelt
19. Proposed Depth 4500'		19A. Formation San Andres
20. Rotary or C.T. Rotary		
21. Elevations (show whether DF, KI, etc.) 4472.9' GR	21A. Kind & Status Plug. Bond Blanket	21B. Drilling Contractor Norton Drilling Co.
22. Approx. Date Work will start January 7, 1984		

23.

## PROPOSED CASING AND CEMENT PROGRAM

SIZE OF HOLE	SIZE OF CASING	WEIGHT PER FOOT	SETTING DEPTH	SACKS OF CEMENT	EST. TOP
12-1/4"	8-5/8"	24	500'	325	circ to surface
7-7/8"	4-1/2"	10.5	4500'	750	circ to surface

Drill 12-1/4" hole to 500', circulate, POH, run 500' 8-5/8" 24# J55 ST&C casing w/Texas pattern casing shoe and 3 centralizers, pump 325 sx Class 'C' cement w/2% cal chlorides circulating cement to surface, WOC 12 hrs, cut off 8-5/8" casing, weld on 8-5/8" casinghead, NU 3000 psi BOP, pressure test BOP and 8-5/8" casing to 1000 psi prior to drilling out cement plug. Drill 7-7/8" hole to 4500' or less, run Dual Guard Forxo, Compensated Density, Gamma Ray, Caliper, Dual-Spaced Neutron log, run 4-1/2" 10.5# J55 ST&C casing w/guide shoe, float collar and 10 centralizers, pump 350 sx 3% Econolite 'C' followed by Class 'C' cement, circulating cement to surface, set slips, cut off 4-1/2" casing, release rig for completion

APPROVAL VALID FOR 180 DAYS  
PERMIT EXPIRES 6/19/84  
UNLESS DRILLING UNDERWAY

IN ABOVE SPACE DESCRIBE PROPOSED PROGRAM; IF PROPOSAL IS TO DEEPEN OR PLUG BACK, GIVE DATA ON PRESENT PRODUCTIVE ZONE AND PROPOSED NEW PRODUCTIVE ZONE. GIVE BLOWOUT PREVENTER PROGRAM, IF ANY.

I hereby certify that the information above is true and complete to the best of my knowledge and belief.

Signed James R. Sutherland Title Vice-President, Operations Date December 6, 1983

(This space for State Use)

ORIGINAL SIGNED BY EDDIE SEAY

APPROVED BY OIL & GAS INSPECTOR TITLE \_\_\_\_\_

DATE \_\_\_\_\_

CONDITIONS OF APPROVAL, IF ANY:

DEC 19 1983

100-67-131

RECEIVED  
DEC 16 1983

NEW MEXICO OIL CONSERVATION COMMISSION  
WELL LOCATION AND ACREAGE DEDICATION PLAT

Form C-102  
Supersedes C-128  
Effective 1-1-65

All distances must be from the outer boundaries of the Section.

Operator <b>BRAZOS PETROLEUM COMPANY</b>		Lease <b>Hefflefinger</b>		Well No. <b>2</b>
Unit Letter <b>D</b>	Section <b>35</b>	Township <b>7 South</b>	Range <b>32 East</b>	County <b>Roosevelt</b>
Actual Footage Location of Well: <b>860</b> feet from the <b>north</b> line and <b>660</b> feet from the <b>west</b> line				
Ground Level Elev. <b>4472.9'</b>	Producing Formation <b>San Andres</b>	Pool <b>Chaveroo-San Andres</b>	Dedicated Acreage: <b>40</b> Acres	

1. Outline the acreage dedicated to the subject well by colored pencil or hachure marks on the plat below.
2. If more than one lease is dedicated to the well, outline each and identify the ownership thereof (both as to working interest and royalty).
3. If more than one lease of different ownership is dedicated to the well, have the interests of all owners been consolidated by communitization, unitization, force-pooling, etc?

☐ Yes ☐ No If answer is "yes," type of consolidation \_\_\_\_\_

If answer is "no," list the owners and tract descriptions which have actually been consolidated. (Use reverse side of this form if necessary.) \_\_\_\_\_

No allowable will be assigned to the well until all interests have been consolidated (by communitization, unitization, forced-pooling, or otherwise) or until a non-standard unit, eliminating such interests, has been approved by the Commission.

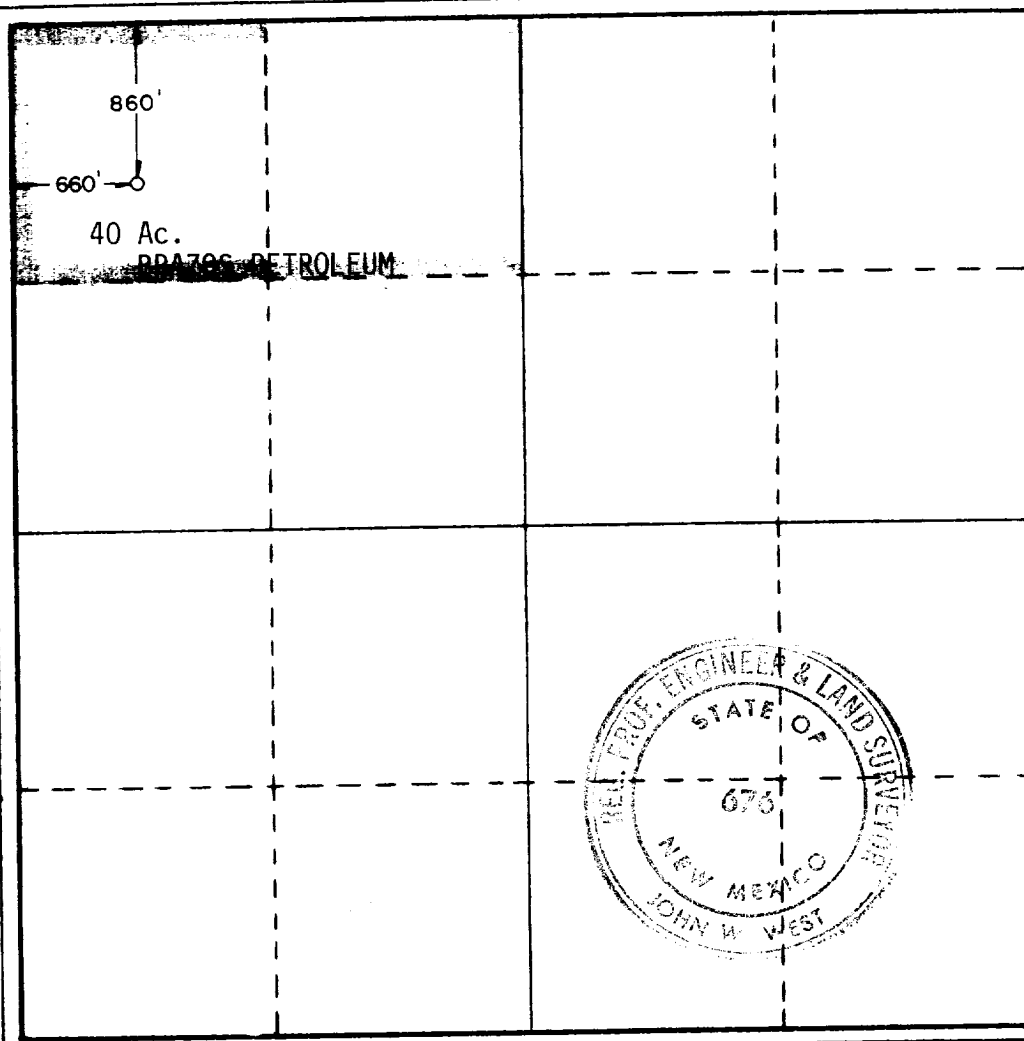

CERTIFICATION

I hereby certify that the information contained herein is true and complete to the best of my knowledge and belief.

*James R. Sutherland*  
Name

James R. Sutherland

Position

Vice-President, Operations

Company

Brazos Petroleum Company

Date

December 6, 1983

I hereby certify that the well location shown on this plat was plotted from field notes of actual surveys made by me or under my supervision, and that the same is true and correct to the best of my knowledge and belief.

Date Surveyed

Feb. 8, 1983

Registered Professional Engineer and/or Land Surveyor

*John W. West*  
Certificate No.

John W. West, NM P.L.S. 676

0 320 640 960 1280 1600 1920 2240 2560 2880 3200 3520 3840 4160 4480 4800 5120 5440 5760 6080 6400

DEC 16 1983  
FBI  
RECORDS OFFICE