

NEW MEXICO OIL CONSERVATION COMMISSION
WELL LOCATION AND ACREAGE DEDICATION AT

Form C-102
 Supersedes C-128
 Effective 1-1-65

All distances must be from the outer boundaries of the Section.

Operator YATES PETROLEUM CORPORATION			Lease Bluestem "ZL" Federal		Well No. 1
Unit Letter G	Section 20	Township 8-South	Range 38-East	County Roosevelt	
Actual Footage Location of Well: 1650 feet from the North line and 2310 feet from the East line					
Ground Level Elev. 3976'	Producing Formation San Andres		Pool Bluitt San Andres Associated		Dedicated Acreage: 80 Acres

1. Outline the acreage dedicated to the subject well by colored pencil or hachure marks on the plat below.
2. If more than one lease is dedicated to the well, outline each and identify the ownership thereof (both as to working interest and royalty).
3. If more than one lease of different ownership is dedicated to the well, have the interests of all owners been consolidated by communitization, unitization, force-pooling, etc?

☐ Yes ☐ No If answer is "yes," type of consolidation _____

If answer is "no," list the owners and tract descriptions which have actually been consolidated. (Use reverse side of this form if necessary.) _____

No allowable will be assigned to the well until all interests have been consolidated (by communitization, unitization, forced-pooling, or otherwise) or until a non-standard unit, eliminating such interests, has been approved by the Commission.

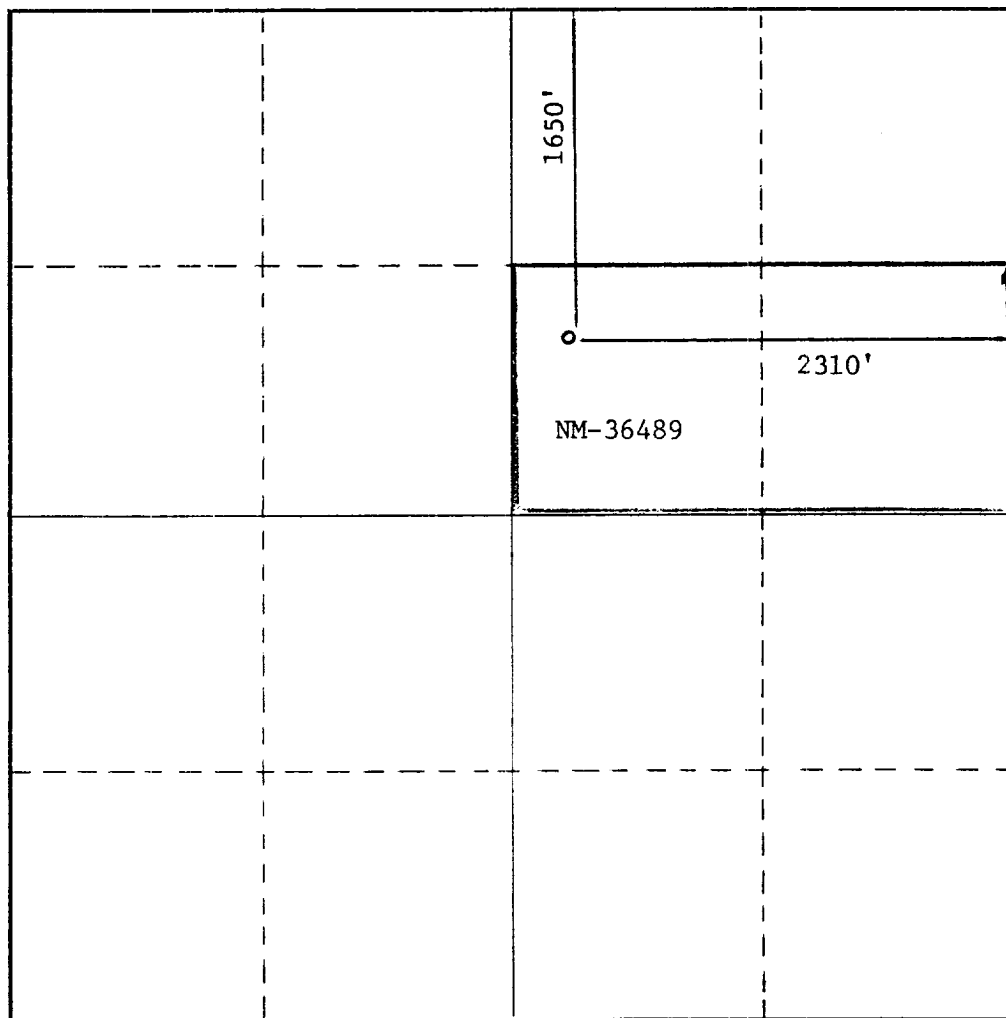

CERTIFICATION

I hereby certify that the information contained herein is true and complete to the best of my knowledge and belief.

Juanita Goodlett
 Name

Juanita Goodlett
 Position

Production Supervisor

Company

Yates Petroleum Corporation

Date

March 13, 1986

I hereby certify that the well location shown on this plat was plotted from field notes of actual surveys made by me or under my supervision, and that the same is true and correct to the best of my knowledge and belief.

REFER TO ORIGINAL PLAT

Date Surveyed **dated 4-9-84**

Registered Professional Engineer
 and/or Land Surveyor

Certificate No.

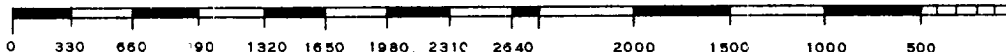

RECEIVED
MAR 14 1986
C. C. HOBBS
HOBBS OFFICE