

UNITED STATES DEPARTMENT OF THE INTERIOR
BUREAU OF LAND MANAGEMENT

APPLICATION FOR PERMIT TO DRILL, DEEPEN, OR PLUG BACK

1a. TYPE OF WORK

DRILL ☒

DEEPEN ☐

PLUG BACK ☐

b. TYPE OF WELL

OIL
WELL ☒

GAS
WELL ☐

OTHER ☐

SINGLE
ZONE ☒

MULTIPLE
ZONE ☐

2. NAME OF OPERATOR

MORRIS R. ANTWEIL

(Jerry Hillard)
(505-393-4111)

3. ADDRESS OF OPERATOR

P. O. Box 2010, Hobbs, New Mexico 88240

4. LOCATION OF WELL (Report location clearly and in accordance with any State requirements.)*

At surface

660' FSL & 660' FEL of Section 25.

At proposed prod. zone
same

(Unit P)
(SE $\frac{1}{4}$ SE $\frac{1}{4}$)

14. DISTANCE IN MILES AND DIRECTION FROM NEAREST TOWN OR POST OFFICE*

5 $\frac{1}{2}$ air miles north-northeast of Crossroads, New Mexico

15. DISTANCE FROM PROPOSED*

LOCATION TO NEAREST
PROPERTY OR LEASE LINE, FT.
(Also to nearest drlg. unit line, if any)

660'

(660')

16. NO. OF ACRES IN LEASE

240

17. NO. OF ACRES ASSIGNED
TO THIS WELL

160

18. DISTANCE FROM PROPOSED LOCATION*

TO NEAREST WELL, DRILLING, COMPLETED,
OR APPLIED FOR, ON THIS LEASE, FT.

N.A.

19. PROPOSED DEPTH

9900' Penn

20. ROTARY OR CABLE TOOLS

Rotary

21. ELEVATIONS (Show whether DF, RT, GR, etc.)

4141' G.L.

22. APPROX. DATE WORK WILL START*

December 26, 1984

23.

PROPOSED CASING AND CEMENTING PROGRAM

SIZE OF HOLE	SIZE OF CASING	WEIGHT PER FOOT	SETTING DEPTH	QUANTITY OF CEMENT
17 1/2"	13 3/8"	54.5#	400'	Sufficient to circulate
11 "	8 5/8"	24 & 32#	3200'	Sufficient to circulate
7 7/8"	5 1/2"	15.5 & 17#	9900'	265 sacks

Pay zone will be selectively perforated and stimulated as needed for optimum production.

Attached are: 1. Well Location & Acreage Dedication Plat
2. Supplemental Drilling Data
3. Surface Use Plan

IN ABOVE SPACE DESCRIBE PROPOSED PROGRAM: If proposal is to deepen or plug back, give data on present productive zone and proposed new productive zone. If proposal is to drill or deepen directionally, give pertinent data on subsurface locations and measured and true vertical depths. Give blowout preventer program, if any.

24.

SIGNED

James A. Knauf

TITLE

Agent

DATE

December 13, 1984

(This space for Federal or State office use)

PERMIT NO.

APPROVAL DATE

APPROVED BY

S/Phil Kirk

TITLE

Area Manager

DATE

1-2-85

CONDITIONS OF APPROVAL, IF ANY:

*See Instructions On Reverse Side

RECEIVED

JAN - 4 1935

G. C. H.
HOBBS OFFICE

**NEW MEXICO OIL CONSERVATION COMMISSION
WELL LOCATION AND ACREAGE DEDICATION PLAT**

Form C-102
Supersedes C-128
Effective 1-1-65

All distances must be from the outer boundaries of the Section

Operator MORRIS R. ANTWEIL		Lease CONQUEST FEDERAL		Well No. 1	
Tract Letter 0	Section 25	Township 8S	Range 35E	County ROOSEVELT	
Approximate Location of Well: 660 feet from the SOUTH line and 660 feet from the EAST line					
Ground Level Elev. 4141.0	Producing Formation Pennsylvanian	Pool Vada - Pennsylvanian		Dedicated Acreage: 160 Acres	

- Outline the acreage dedicated to the subject well by colored pencil or hatchure marks on the plat below.
- If more than one lease is dedicated to the well, outline each and identify the ownership thereof (both as to working interest and royalty). Federal lease NM-54437 is only lease involved.
- If more than one lease of different ownership is dedicated to the well, have the interests of all owners been consolidated by communitization, unitization, force-pooling, etc?

☐ Yes ☐ No If answer is "yes," type of consolidation _____

If answer is "no," list the owners and tract descriptions which have actually been consolidated. (Use reverse side of this form if necessary.) _____

No allowable will be assigned to the well until all interests have been consolidated (by communitization, unitization, forced-pooling, or otherwise) or until a non-standard unit, eliminating such interests, has been approved by the Commission.

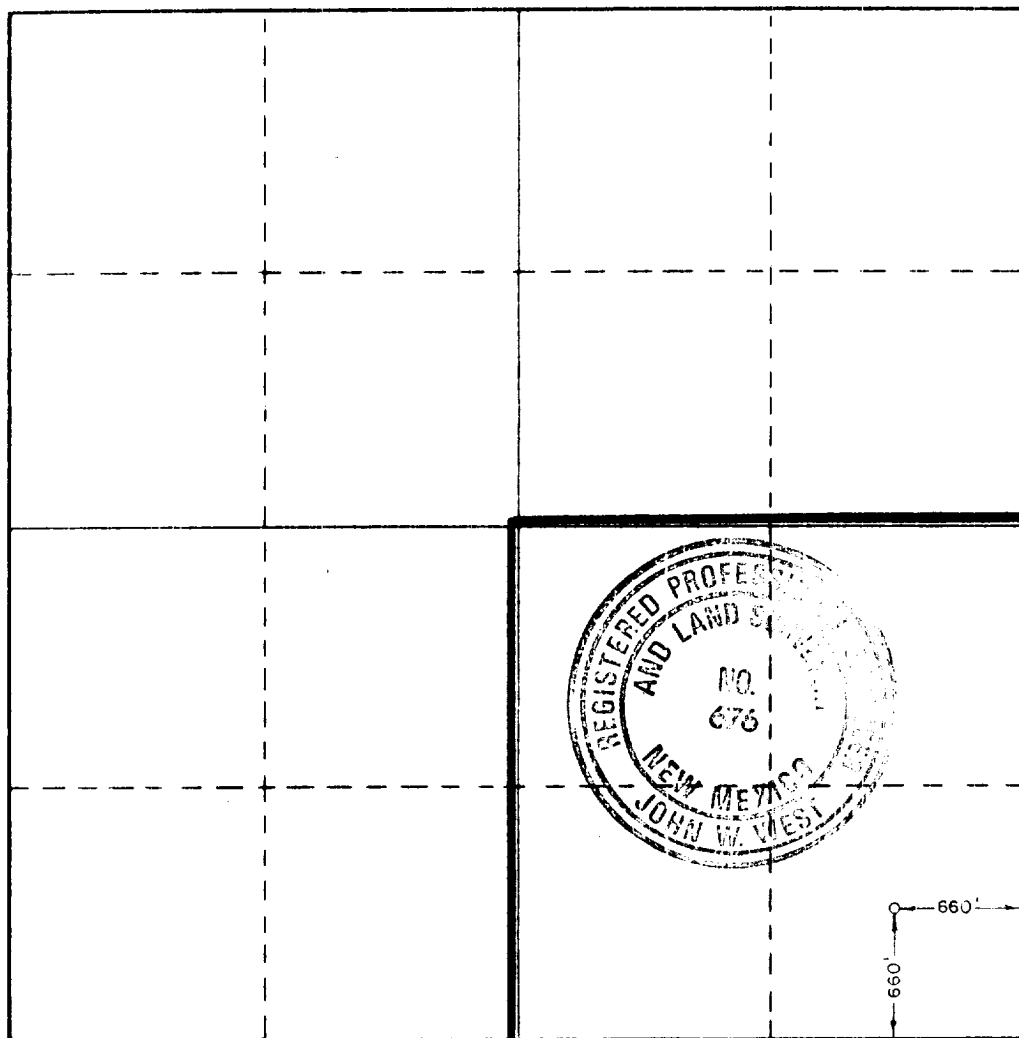

CERTIFICATION

I hereby certify that the information contained herein is true and complete to the best of my knowledge and belief.

James A. Knauf
Name

James A. Knauf

Position

Agent

Company

MORRIS R. ANTWEIL

Date

December 13, 1984

I hereby certify that the well location shown on this plat was plotted from field notes of actual surveys made by me or under my supervision, and that the same is true and correct to the best of my knowledge and belief.

Date Surveyed

12/8/84

Registered Professional Engineer and/or Land Surveyor

John W. West

Certificate No. **JOHN W. WEST, 676**

RONALD J. EIDSON, 3239

0 500 1000 1500 2000 2500 2640 2310 1980 1680 1320 960 600 330 0

RECEIVED

JAN - 2 1985

NOBIS OFFICE

BLOWOUT PREVENTER ARRANGEMENT

Morris R. Antweil
Well #1 Conquest Federal
660' FSL & 660' FEL Sec. 25-8S-35E

900 SERIES

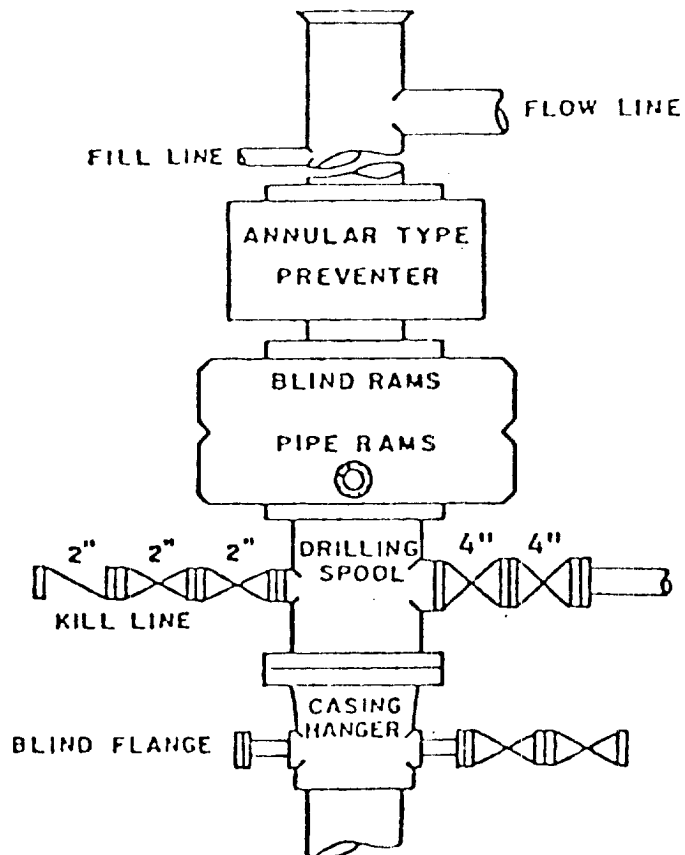

REC-10-13-87
173

RECEIVED
JAN - 4 1985
O.C.C.
HOBBS OFFICE