

UNITED STATES  
DEPARTMENT OF THE INTERIOR  
BUREAU OF LAND MANAGEMENTM. Oil Cons.  
1625 N. French Dr.  
Hobbs, NM 88240FORM APPROVED  
OMB No. 1004-0135  
Expires November 30, 2000**SUNDRY NOTICES AND REPORTS ON WELLS**  
*Do not use this form for proposals to drill or to re-enter an abandoned well. Use Form 3160-3 (APD) for such proposals.***SUBMIT IN TRIPLICATE - Other Instructions on reverse side**

## 1. Type of Well

☒ Oil Well ☐ Gas Well ☐ Other

## 2. Name of Operator

H. L. Brown, Jr.

## 3a. Address

P. O. Box 2237, Midland, TX 79702

## 3b. Phone No. (include area code)

915-683-5216

## 4. Location of Well (Footage, Sec., T., R., M., or Survey Description)

660 ft FNL & 1980 ft FWL  
Section 27, T-7-S, R-37-E

## 5. Lease Serial No.

NM-12852

## 6. If Indian, Allottee or Tribe Name

## 7. If Unit or CA/Agreement, Name and/or No.

NM 54449

## 8. Well Name and No.

Federal "27A" No. 1

## 9. API Well No.

30-041-20832

## 10. Field and Pool, or Exploratory Area

North Bluit (Siluro-Devonian)

## 11. County or Parish, State

Rosevelt County, NM

## 12. CHECK APPROPRIATE BOX(ES) TO INDICATE NATURE OF NOTICE, REPORT, OR OTHER DATA

TYPE OF SUBMISSION	TYPE OF ACTION			
<input checked="" type="checkbox"/> Notice of Intent	<input type="checkbox"/> Acidize	<input type="checkbox"/> Deepen	<input type="checkbox"/> Production (Start/Resume)	<input type="checkbox"/> Water Shut-Off
<input type="checkbox"/> Subsequent Report	<input type="checkbox"/> Alter Casing	<input type="checkbox"/> Fracture Treat	<input type="checkbox"/> Reclamation	<input type="checkbox"/> Well Integrity
<input type="checkbox"/> Final Abandonment Notice	<input type="checkbox"/> Casing Repair	<input type="checkbox"/> New Construction	<input checked="" type="checkbox"/> Recomplete	<input checked="" type="checkbox"/> Other Drill Horizontal
	<input type="checkbox"/> Change Plans	<input type="checkbox"/> Plug and Abandon	<input type="checkbox"/> Temporarily Abandon	Lateral in Wolfcamp
	<input type="checkbox"/> Convert to Injection	<input checked="" type="checkbox"/> Plug Back	<input type="checkbox"/> Water Disposal	

13. Describe Proposed or Completed Operation (clearly state all pertinent details, including estimated starting date of any proposed work and approximate duration thereof. If the proposal is to deepen directionally or recompleat horizontally, give subsurface locations and measured and true vertical depths of all pertinent markers and zones. Attach the Bond under which the work will be performed or provide the Bond No. on file with BLM/BIA. Required subsequent reports shall be filed within 30 days following completion of the involved operations. If the operation results in a multiple completion or recompleat in a new interval, a Form 3160-4 shall be filed once testing has been completed. Final Abandonment Notices shall be filed only after all requirements, including reclamation, have been completed, and the operator has determined that the site is ready for final inspection.)

The proposed operation is to plug back from the Devonian (Perfs: 8862'-8874'; 8876'-8881') and drill a Horizontal Lateral from the existing 5 1/2" casing for re-compleat in the Bluit-Wolfcamp (Gas) Pool. The estimated start date will be 4/12/00. The kick-off point for the Horizontal Lateral will be 7725 feet. The Horizontal Lateral will be drilled due south from the existing borehole with a 4 3/4" bit. The Wolfcamp entry point will be 908 ft FNL & 1980 ft FWL of Section 27. The end point of the lateral will be 2630 ft FNL and 1980 ft FWL of Section 27. Total depth will be 9836 ft MD & 7973 ft TVD.

A double ram, 3000 Psi WP BOP will be used from rig up thru completion.

The acreage to be dedicated to the Federal '27A' No. 1 will be 320 acres and is currently assigned to the Federal '27' Com No. 2 which is currently completed in the Bluit-Wolfcamp (Gas) Pool. Upon completion of the Federal '27A' No. 1, the Federal '27' Com No. 2 will be shut-in.

## 14. I hereby certify that the foregoing is true and correct

Name (Printed/Typed)

Jerry M. Jordan

Title Operations Manager

Signature

Date 3/31/00

## THIS SPACE FOR FEDERAL OR STATE OFFICE USE

Approved by

Title

Date

Conditions of approval, if any, are attached. Approval of this notice does not warrant or certify that the applicant holds legal or equitable title to those rights in the subject lease which would entitle the applicant to conduct operations thereon.

Office

Title 18 U.S.C. Section 1001 and Title 43 U.S.C. Section 1212, make it a crime for any person knowingly and willfully to make to any department or agency of the United States any false, fictitious or fraudulent statements or representations as to any matter within its jurisdiction.

J. M. Jordan

BUREAU OF LAND MANAGEMENT  
NORWELL OFFICE

2000 APR - 3 A 10:30

RECEIVED

2000 APR 3

RECEIVED  
NORWELL OFFICE

H. L. Brown, Jr.  
Federal '27A' No. 1 Unit C- 27-7s-37e  
Roosevelt County  
3/31/00

3D-041-20832

Well location and projected Horizontal Lateral in Wolfcamp

7264D

Bluitt Wolfcamp

R-37-E

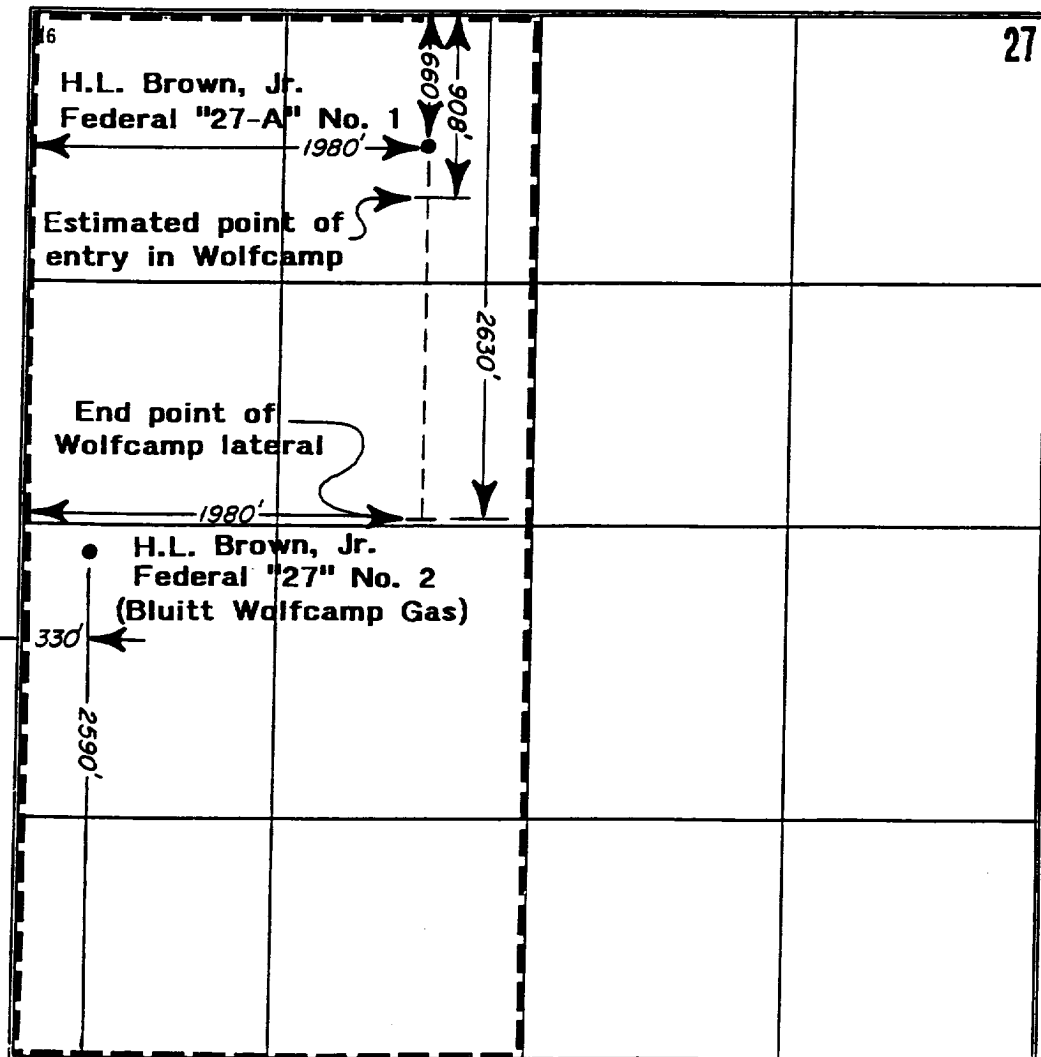

RECEIVED

2000 APR -3 A 10:29

DEPT OF L. & K. 100  
IN SMALL OFFICE

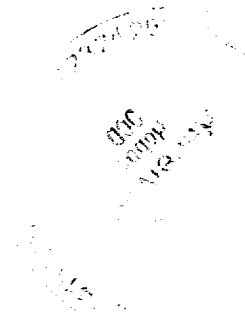

**District I**  
1625 N. Fresno Dr., Hobbs, NM 88240  
**District II**

811 South First, Artesia, NM 88210

**District III**

1000 Rio Brazos Rd., Aztec, NM 87410

**District IV**

2040 South Pacheco, Santa Fe, NM 87505

State of New Mexico  
Energy, Minerals & Natural Resources

OIL CONSERVATION DIVISION  
2040 South Pacheco  
Santa Fe, NM 87505

Form C-102  
Revised March 17, 1999

Submit to Appropriate District Office  
State Lease - 4 Copies  
Fee Lease - 3 Copies

☐ AMENDED REPORT

WELL LOCATION AND ACREAGE DEDICATION PLAT

<sup>1</sup> API Number 30-041-20832		<sup>2</sup> Pool Code 72640	<sup>3</sup> Pool Name Bluitt Wolfcamp (Gas)
<sup>4</sup> Property Code 002264	<sup>5</sup> Property Name Federal 27 A		<sup>6</sup> Well Number 1
<sup>7</sup> OGRID No. 009676	<sup>8</sup> Operator Name H.L. Brown, Jr.		<sup>9</sup> Elevation 4058' GL

<sup>10</sup> Surface Location

UL or lot no.	Section	Township	Range	Lot Idn	Feet from the	North/South line	Feet from the	East/West line	County
C	27	7S	37E		660	North	1980	West	Roosevelt

<sup>11</sup> Bottom Hole Location If Different From Surface

UL or lot no.	Section	Township	Range	Lot Idn	Feet from the	North/South line	Feet from the	East/West line	County
F	27	7S	37E		2630	North	1980	West	Roosevelt

<sup>12</sup> Dedicated Acres 320	<sup>13</sup> Joint or Infill	<sup>14</sup> Consolidation Code	<sup>15</sup> Order No.
--------------------------------------	-------------------------------	----------------------------------	-------------------------

NO ALLOWABLE WILL BE ASSIGNED TO THIS COMPLETION UNTIL ALL INTERESTS HAVE BEEN CONSOLIDATED OR A NON-STANDARD UNIT HAS BEEN APPROVED BY THE DIVISION

<div><p><sup>16</sup></p><p>H.L. Brown, Jr. Federal "27-A" No. 1</p><p>Estimated point of entry in Wolfcamp</p><p>End point of Wolfcamp lateral</p><p>H.L. Brown, Jr. Federal "27" No. 2 (Bluitt Wolfcamp Gas)</p></div>	<div><p>27</p><p><sup>17</sup> OPERATOR CERTIFICATION</p><p>I hereby certify that the information contained herein is true and complete to the best of my knowledge and belief</p><p>Signature </p><p>Printed Name Jerry M. Jordan</p><p>Title Operations Manager</p><p>Date 3/30/00</p></div>
	<div><p><sup>18</sup> SURVEYOR CERTIFICATION</p><p>I hereby certify that the well location shown on this plat was plotted from field notes of actual surveys made by me or under my supervision, and that the same is true and correct to the best of my belief.</p><p>Date of Survey</p><p>Signature and Seal of Professional Surveyer:</p><p>Certificate Number</p></div>