

N. M. OIL CONS. COMMISSION
Form 3160-3 (November 1988)
P.O. BOX 1980
HOBBS, NEW MEXICO 88240
DEPARTMENT OF THE INTERIOR
BUREAU OF LAND MANAGEMENT

SUBMIT IN TR DATE
(Other instructions on reverse side)

30-041-20348
Form approved.
Budget Bureau No. 1004-0136
Expires August 31, 1985

APPLICATION FOR PERMIT TO DRILL, DEEPEN, OR PLUG BACK

1A. TYPE OF WORK

DRILL ☒

DEEPEN ☐

PLUG BACK ☐

B. TYPE OF WELL

OIL WELL ☒

GAS WELL ☐

OTHER

SINGLE ZONE ☒

MULTIPLE ZONE ☐

2. NAME OF OPERATOR

PETROLEUM PRODUCTION MANAGEMENT, INC.

3. ADDRESS OF OPERATOR

P.O. BOX 957

Crossroads, New Mexico 88114

4. LOCATION OF WELL (Report location clearly and in accordance with any State requirements.)*

At surface

1830'FSL, 1900'FEL, Sec.34-8S-35E

At proposed prod. zone Same

14. DISTANCE IN MILES AND DIRECTION FROM NEAREST TOWN OR POST OFFICE*

4.2 Miles NNW of Crossroads, New Mexico

15. DISTANCE FROM PROPOSED*

LOCATION TO NEAREST PROPERTY OR LEASE LINE, FT. 1097'

(Also to nearest drilg. unit line, if any)

16. NO. OF ACRES IN LEASE

480 Ac.

18. DISTANCE FROM PROPOSED LOCATION* TO NEAREST WELL, DRILLING, COMPLETED, OR APPLIED FOR, ON THIS LEASE, FT.

1750'

19. PROPOSED DEPTH

9850'

17. NO. OF ACRES ASSIGNED TO THIS WELL

160

20. ROTARY OR CABLE TOOLS

Rotary

21. ELEVATIONS (Show whether DF, RT, GR, etc.)

4174.6 GL

22. APPROX. DATE WORK WILL START*

Upon Approval

23.

PROPOSED CASING AND CEMENTING PROGRAM

SIZE OF HOLE	SIZE OF CASING	WEIGHT PER FOOT	SETTING DEPTH	QUANTITY OF CEMENT
17-1/2"	13-3/8"	48# H-40	400' ±	400± sx Circulated
11"	8-5/8"	28# H-40	4050' ±	400± sx
7-7/8"	5-1/2"	17# N-80	9850' ±	400± sx

Propose to drill to about 9850' to test Pennsylvanian and intermediate formations. Principal objective will be the Bough "C". This will be a replacement for the No.1 Will 693 Ltd.

See "Supplemental Drilling Data" for casing and BOP details.

Selectively perforate 5½" production casing in favorable zones.

Run tubing and stimulate as necessary.

Produce to test tank.

IN ABOVE SPACE DESCRIBE PROPOSED PROGRAM: If proposal is to deepen or plug back, give data on present productive zone and proposed new productive zone. If proposal is to drill or deepen directionally, give pertinent data on subsurface locations and measured and true vertical depths. Give blowout preventer program, if any.

24.

SIGNED

JERRY W. LONG

TITLE Agent

DATE November 10, 1989

(This space for Federal or State office use)

PERMIT NO.

APPROVAL DATE

APPROVED BY

S/Phil Kirk

TITLE

Area Manager

DATE

DEC 4 1989

CONDITIONS OF APPROVAL, IF ANY:

APPROVAL OF THIS APPLICATION DOES NOT WARRANT OR CERTIFY THAT THE APPLICANT HOLDS LEGAL OR EQUITABLE TITLE TO THOSE RIGHTS IN THE LAND NOT LEASE WHICH WOULD ENTITLE THE APPLICANT TO CONDUCT OPERATIONS THEREON.

PLEASE BE ADVISED THAT THERE WILL BE NO EXCAVATION OF FEDERALLY OWNED MINERAL MATERIAL FOR CONSTRUCTION OF THE ACCESS ROAD OR PAD WITHOUT PERMIT. U.S.C. Section 1001, makes it a crime for any person knowingly and willfully to make to any department or agency of the United States any false, fictitious or fraudulent statements or representations as to any matter within its jurisdiction.

RECEIVED
DEC 17 1944
U.S. AIR FORCE
HONOLULU, HAWAII

Submit to Appropriate
District Office
State Lease - 4 copies
Fee Lease - 3 copies

State of New Mexico
Energy, Minerals and Natural Resources Department

Form C-102
Revised 1-1-89

OIL CONSERVATION DIVISION

P.O. Box 2088

Santa Fe, New Mexico 87504-2088

DISTRICT I

P.O. Box 1980, Hobbs, NM 88240

DISTRICT II

P.O. Drawer DD, Artesia, NM 88210

DISTRICT III

1000 Rio Brazos Rd., Aztec, NM 87410

WELL LOCATION AND ACREAGE DEDICATION PLAT

All Distances must be from the outer boundaries of the section

Operator Petroleum Production Management, Inc.			Lease Will 693 Ltd.		Well No. 4
Unit Letter J	Section 34	Township 8 South	Range 35 East	County NMPM Roosevelt	

Actual Footage Location of Well:

1900 feet from the East line and 1830 feet from the South line		
Ground level Elev. 4174.6	Producing Formation Pennsylvanian	Pool Vada-Penn
		Dedicated Acreage: 160 Acres

1. Outline the acreage dedicated to the subject well by colored pencil or hatchure marks on the plat below.

2. If more than one lease is dedicated to the well, outline each and identify the ownership thereof (both as to working interest and royalty). single Lease

3. If more than one lease of different ownership is dedicated to the well, have the interest of all owners been consolidated by communitization, unitization, force-pooling, etc.?

☐ Yes ☐ No If answer is "yes" type of consolidation _____

If answer is "no" list the owners and tract descriptions which have actually been consolidated. (Use reverse side of this form if necessary.) _____

No allowable will be assigned to the well until all interests have been consolidated (by communitization, unitization, forced-pooling, or otherwise) or until a non-standard unit, eliminating such interest, has been approved by the Division.

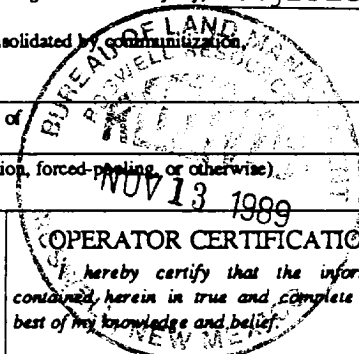

OPERATOR CERTIFICATION

I hereby certify that the information contained herein is true and complete to the best of my knowledge and belief.

Signature

Gerry W. Long

Printed Name

JERRY W. LONG

Position

Agent

Company

PETROLEUM PRODUCTION MANAGEMENT, INC.

Date

November 10, 1989

SURVEYOR CERTIFICATION

I hereby certify that the well location shown on this plat was plotted from field notes of actual surveys made by me or under my supervision, and that the same is true and correct to the best of my knowledge and belief.

Date Surveyed

October 5, 1989

Signature & Seal of Professional Surveyor

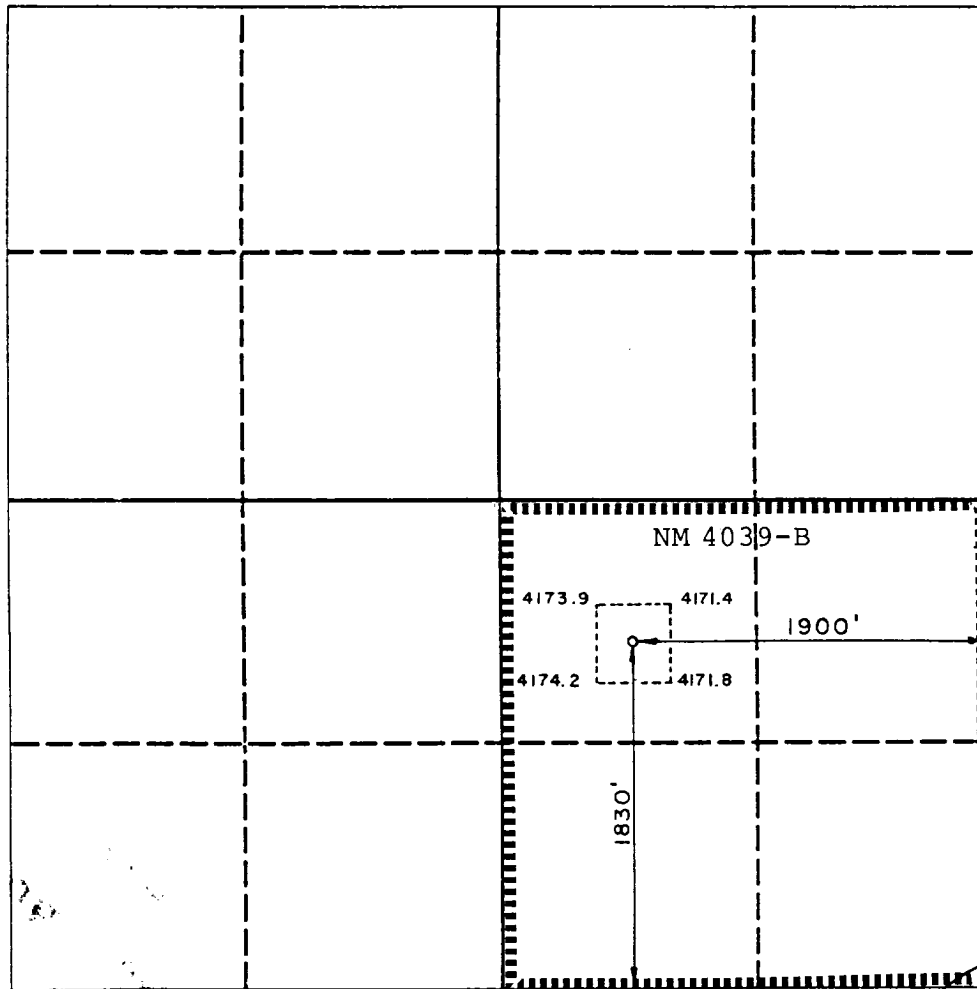
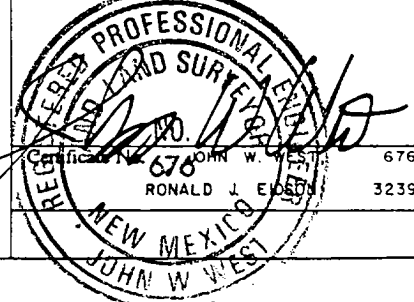

125630

PETROLEUM PRODUCTION MANAGEMENT, INC.
 No.4 Will 693 Ltd.
 1830'FSL 1900'FEL Sec.34-8S-35E
 Roosevelt County, New Mexico
 Lease NM 4039-B

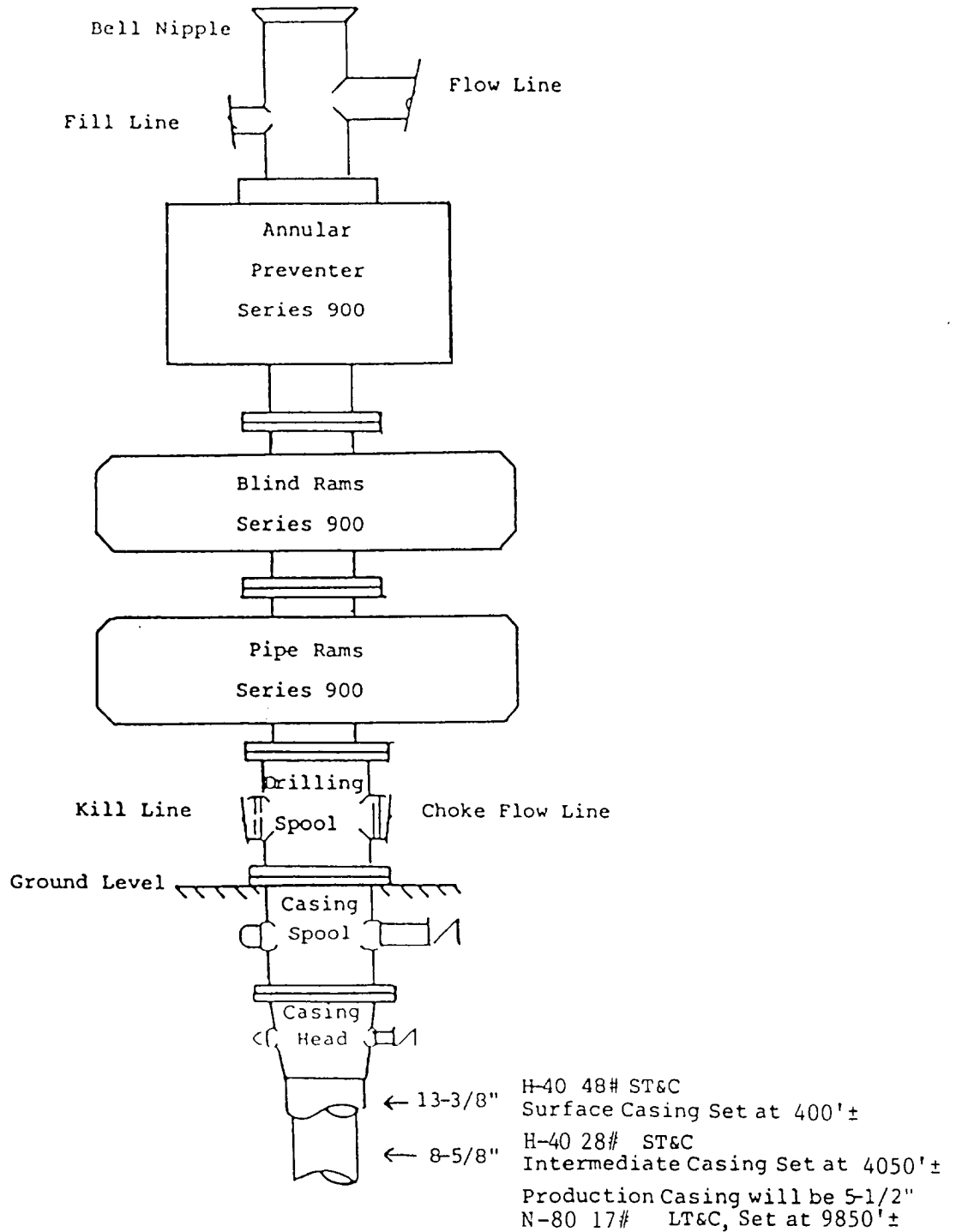

BLOWOUT PREVENTER STACK

5000#WP

Rams Operated Daily

EXHIBIT D

Rec'd 11-6-90
173

RECEIVED
DEC 7 1989
OCD
HOBBS OFFICE