

**NEW MEXICO OIL CONSERVATION COMMISSION
WELL LOCATION AND ACREAGE DEDICATION PLAT**

Form C-102
Supersedes C-128
Effective 1-1-65

All distances must be from the outer boundaries of the Section

Operator EUGENE E. NEARBURG			Lease JENNINGS		Well No. 1
Unit Letter M	Section 5	Township 8 SOUTH	Range 30 EAST	County CHAVES	
Actual Footage Location of Well: <div style="display: flex; justify-content: space-between;"> 657 feet from the SOUTH line and 666 feet from the WEST line </div>					
Ground Level Elev. 4036.8	Producing Formation Pennsylvanian	Pool Wildcat		Dedicated Acreage: 40 Acres	

1. Outline the acreage dedicated to the subject well by colored pencil or hachure marks on the plat below.
2. If more than one lease is dedicated to the well, outline each and identify the ownership thereof (both as to working interest and royalty). **Not applicable**
3. If more than one lease of different ownership is dedicated to the well, have the interests of all owners been consolidated by communitization, unitization, force-pooling, etc? **Not applicable**

☐ Yes ☐ No If answer is "yes," type of consolidation _____

If answer is "no," list the owners and tract descriptions which have actually been consolidated. (Use reverse side of this form if necessary.) _____

No allowable will be assigned to the well until all interests have been consolidated (by communitization, unitization, forced-pooling, or otherwise) or until a non-standard unit, eliminating such interests, has been approved by the Commission.

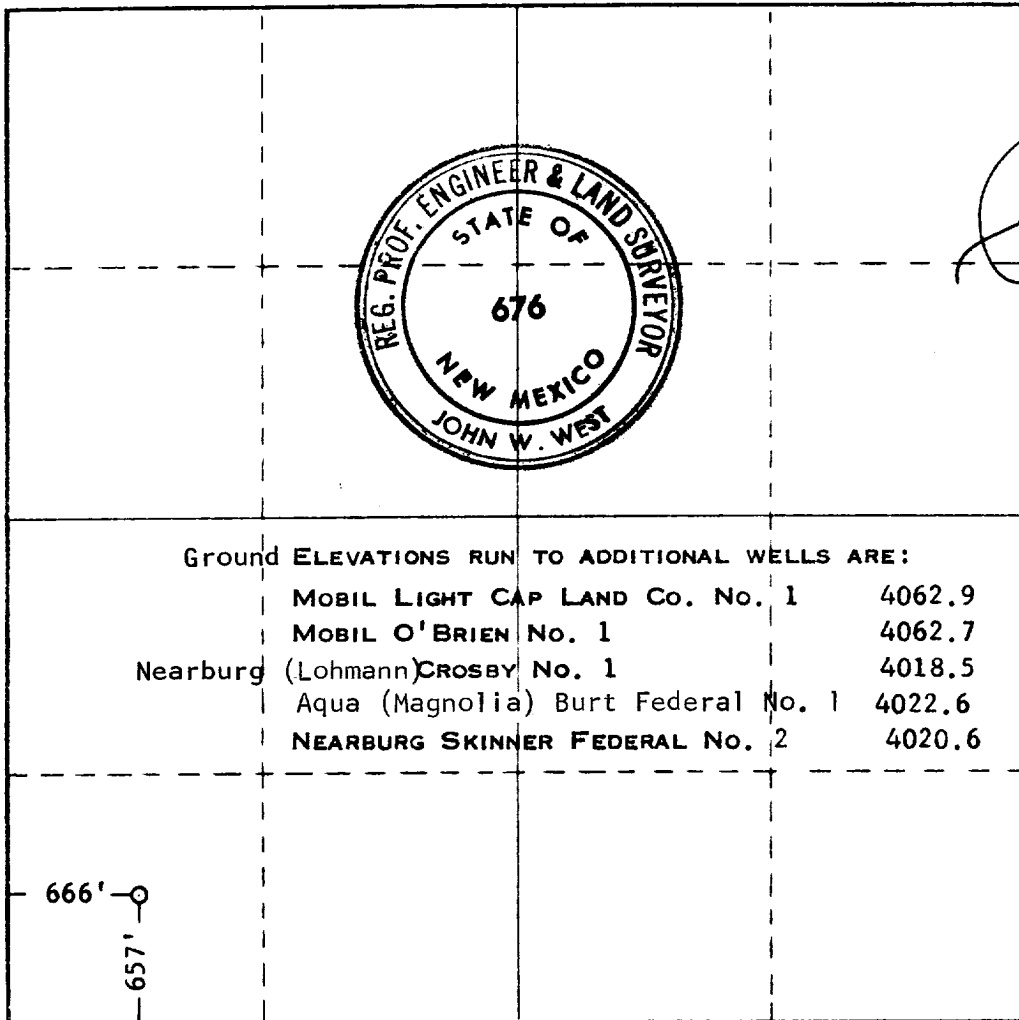

Ground ELEVATIONS RUN TO ADDITIONAL WELLS ARE:

	MOBIL LIGHT CAP LAND Co. No. 1	4062.9
	MOBIL O'BRIEN No. 1	4062.7
Nearburg	(Lohmann) CROSBY No. 1	4018.5
	Aqua (Magnolia) Burt Federal No. 1	4022.6
	NEARBURG SKINNER FEDERAL No. 2	4020.6

CERTIFICATION

I hereby certify that the information contained herein is true and complete to the best of my knowledge and belief.

Patrick J. F. Gratton
Name: **Patrick J. F. Gratton**

Position: **Exploration Manager**

Company: **EUGENE E. NEARBURG**

Date: **3 March 1969**

I hereby certify that the well location shown on this plat was plotted from field notes of actual surveys made by me or under my supervision, and that the same is true and correct to the best of my knowledge and belief.

Date Surveyed: **SEPT. 27, 1968**

Registered Professional Engineer and/or Land Surveyor

John W. West
Certificate No. **676**

