

NE EXICO OIL CONSERVATION COMMISS.

Well Location and Acreage Dedication Plat

Section A.

Date January 14, 1959

Operator The Texas Co. Lease Peery-Federal
Well No. 2 Unit Letter "O" Section 29 Township 15-South Range 30-East NMPM
Located 1980 Feet From East Line, 660 Feet From South Line
County Chaves G. L. Elevation 3954.6 Dedicated Acreage 40 Acres
Name of Producing Formation Ellenburger & Devonian Pool Undesignated Devonian

1. Is the Operator the only owner* in the dedicated acreage outlined on the plat below?
Yes X No .
2. If the answer to question one is "no," have the interests of all the owners been consolidated by communitization agreement or otherwise? Yes If answer is "yes," Type of Consolidation
3. If the answer to question two is "no," list all the owners and their respective interests below:

Owner

Land Description

Section B

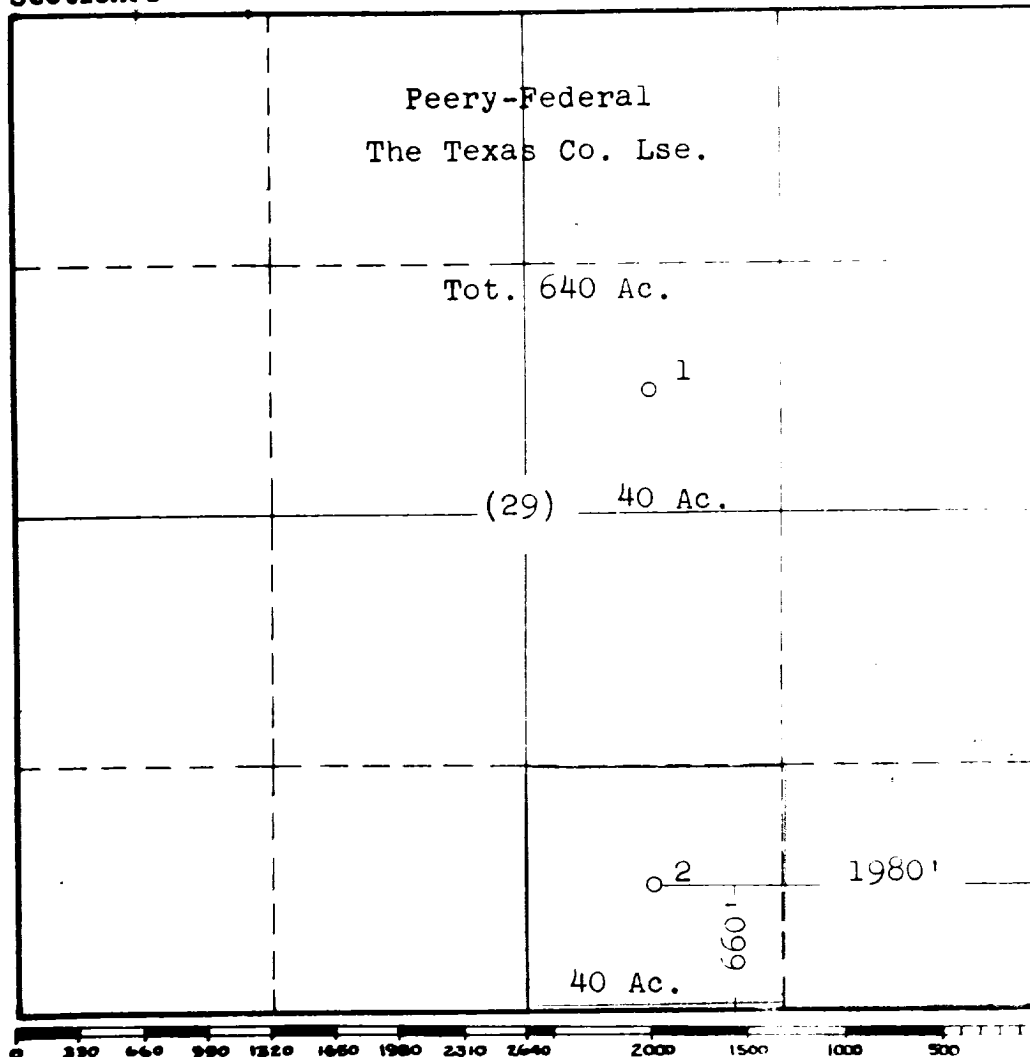

Marker

This is to certify that the information in Section A is true and complete to the best of my knowledge and belief.

The Texas Company

(Representative)

Division Civil Engineer
Box 1720, Ft. Worth, Tex.

Address

This is to certify that the well location shown on the plat in Section B was plotted from field notes of actual surveys made by me or under my supervision and that the size is true and correct to the best of my knowledge and belief.

Date Surveyed

Registered Professional
Engineer and/or Land Surveyor.

Certificate No.

(See instructions for completing this form on the reverse side)