

COPY TO O. C. C.

Budget Bureau No. 42-R158.4
Approval expires 12-31-60.

Form 9-531a
(Feb. 1951)

(SUBMIT IN TRIPLICATE)

UNITED STATES
DEPARTMENT OF THE INTERIOR
GEOLOGICAL SURVEY

Land Office **NM-0338-A**

Lease No.

Unit

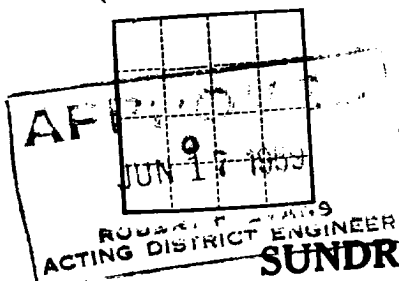

SUNDRY NOTICES AND REPORTS ON WELLS

NOTICE OF INTENTION TO DRILL		SUBSEQUENT REPORT OF WATER SHUT-OFF	
NOTICE OF INTENTION TO CHANGE PLANS		SUBSEQUENT REPORT OF SHOOTING OR ACIDIZING	
NOTICE OF INTENTION TO TEST WATER SHUT-OFF		SUBSEQUENT REPORT OF ALTERING CASING	
NOTICE OF INTENTION TO RE-DRILL OR REPAIR WELL		SUBSEQUENT REPORT OF RE-DRILLING OR REPAIR	
NOTICE OF INTENTION TO SHOOT OR ACIDIZE		SUBSEQUENT REPORT OF ABANDONMENT	
NOTICE OF INTENTION TO PULL OR ALTER CASING		SUPPLEMENTARY WELL HISTORY	
NOTICE OF INTENTION TO ABANDON WELL	X		

Change of Location

(INDICATE ABOVE BY CHECK MARK NATURE OF REPORT, NOTICE, OR OTHER DATA)

Lease No. **163728**
Peery-Federal Lease

Midland, Texas, June 15, 1959

Well No. **3** is located **1820** ft. from **N** line and **2140** ft. from **W** line of sec. **29**

NE/4 SW/4 Sec. 29 (1/4 Sec. and Sec. No.) **15-S** (Twp.) **30-E** (Range) **NMPM** (Meridian)
Little Lucky Lake (Field) **Devonian** (County or Subdivision) **New Mexico** (State or Territory)

The elevation of the derrick floor above sea level is **3964** ft.

DETAILS OF WORK

(State names of and expected depths to objective sands; show sizes, weights, and lengths of proposed casings; indicate mudding jobs, cementing points, and all other important proposed work)

FORMATIONS EXPECTED	SIZE HOLE	SIZE CASING	CASING PROGRAM (Approx)	
			Set at	Cement
Top of Yates 1460'		13-3/8" 48# New	470'	500 ex.
" " Glorieta 4350'	17-1/2"	9-5/8" 32.3 & 30# New	2940'	1700 ex.
" " Tubb 5650'	12-1/4"	5-1/2" 17 & 20# New	11400'	500 ex.
" " Abo 6465'	8-3/4"			
" " Wolfcamp 7740'				
" " Penn. 8400'				
" " Miss. 10125'				
" " Devonian 10980'				
Total Depth 11400'				

I understand that this plan of work must receive approval in writing by the Geological Survey before operations may be commenced.

Company **TEXACO Inc.**
Address **P.O. Box 3109**
Midland, Texas

TEXACO Inc.
By **J. J. Velten**
Title **Division Civil Engineer**

NEW MEXICO OIL CONSERVATION COMMISSION
Well Location and Acreage Dedication Plat

Section A.

Date 6-15-59

Operator TEXACO Inc. Lease Peery-Federal
Well No. 3 Unit Letter K Section 29 Township 15 South Range 30 East NMPM
Located 1820 Feet From South Line, 2140 Feet From West Line
County Chaves G. L. Elevation 3953' Dedicated Acreage 40 Acres
Name of Producing Formation Devonian Pool Little Lucky Lake Devonian

1. Is the Operator the only owner* in the dedicated acreage outlined on the plat below?
Yes Y No _____.
2. If the answer to question one is "no," have the interests of all the owners been consolidated by communitization agreement or otherwise? Yes _____ No _____. If answer is "yes," Type of Consolidation _____
3. If the answer to question two is "no," list all the owners and their respective interests below:

Owner

Land Description

RECEIVED
JUN 17 1959

NEW MEXICO

Section B

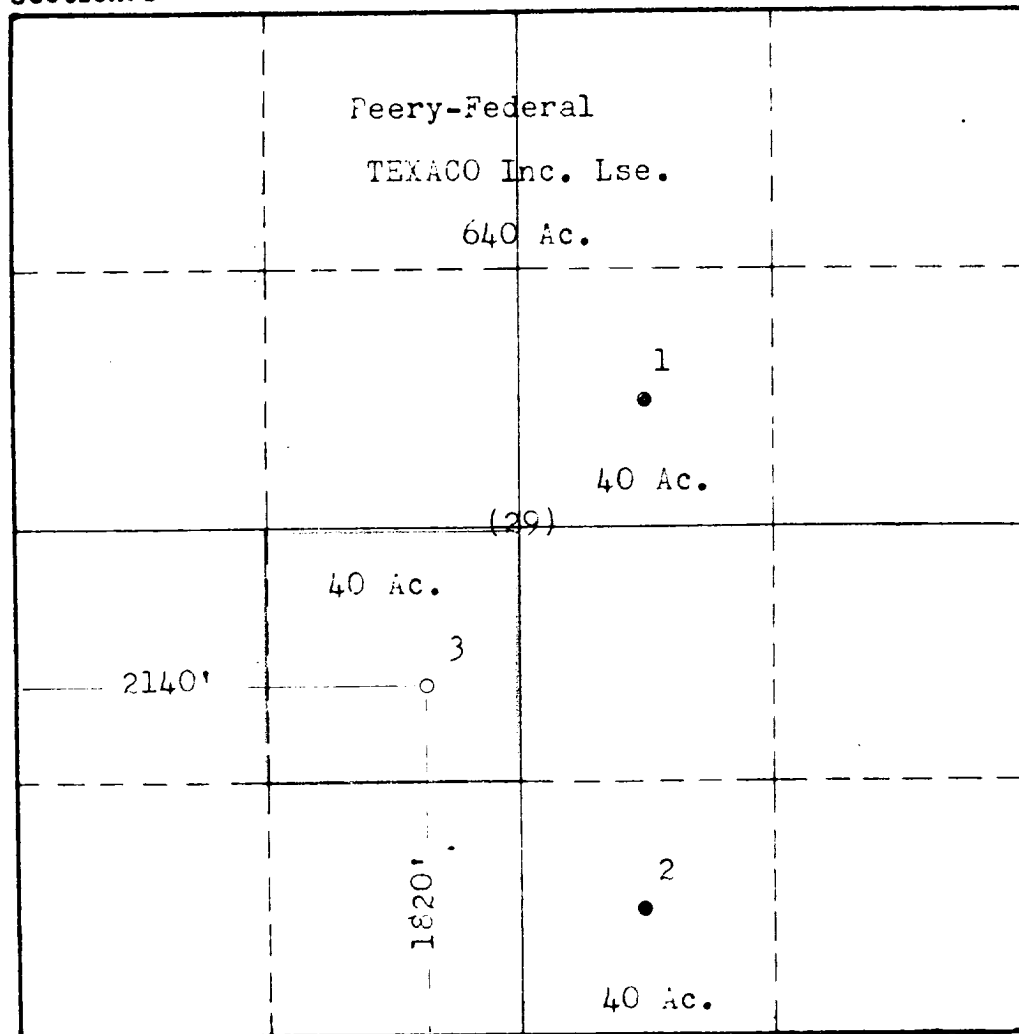

This is to certify that the information in Section A above is true and complete to the best of my knowledge and belief.

TEXACO Inc.

(Operator)

J. J. Elton

(Representative)

Division Civil Engineer
P.O. Box 3109, Midland, Texas
Address

This is to certify that the well location shown on the plat in Section B was plotted from field notes of actual surveys made by me or under my supervision and that the same is true and correct to the best of my knowledge and belief.

Date Surveyed 6/13/59

J. J. Elton

Registered Professional
Engineer and/or Land Surveyor.

Certificate No. 817X