

NEW MEXICO OIL CONSERVATION COMMISSION

Well Location and Acreage Dedication Plat

Section A.

Date 4-2-59

Operator The Texas Company Lease Peery-Federal
Well No. 3 Unit Letter "M" Section 29 Township 15 South Range 30 East N.M.P.M.
Located 660 Feet From South Line, 660 Feet From West Line
County Chaves G. L. Elevation 3937' Dedicated Acreage 40 acres
Name of Producing Formation Allenburger Pool Undesignated Allenburger

1. Is the Operator the only owner* in the dedicated acreage outlined on the plat below?
Yes X No .
2. If the answer to question one is "no," have the interests of all the owners been consolidated by communitization agreement or otherwise? Yes No . If answer is "yes," Type of Consolidation
3. If the answer to question two is "no," list all the owners and their respective interests below:

Owner

Land Description

RECEIVED

APR 2 2 1959

LOGICAL SURVEY
ARTESIA, NEW MEXICO

Section B

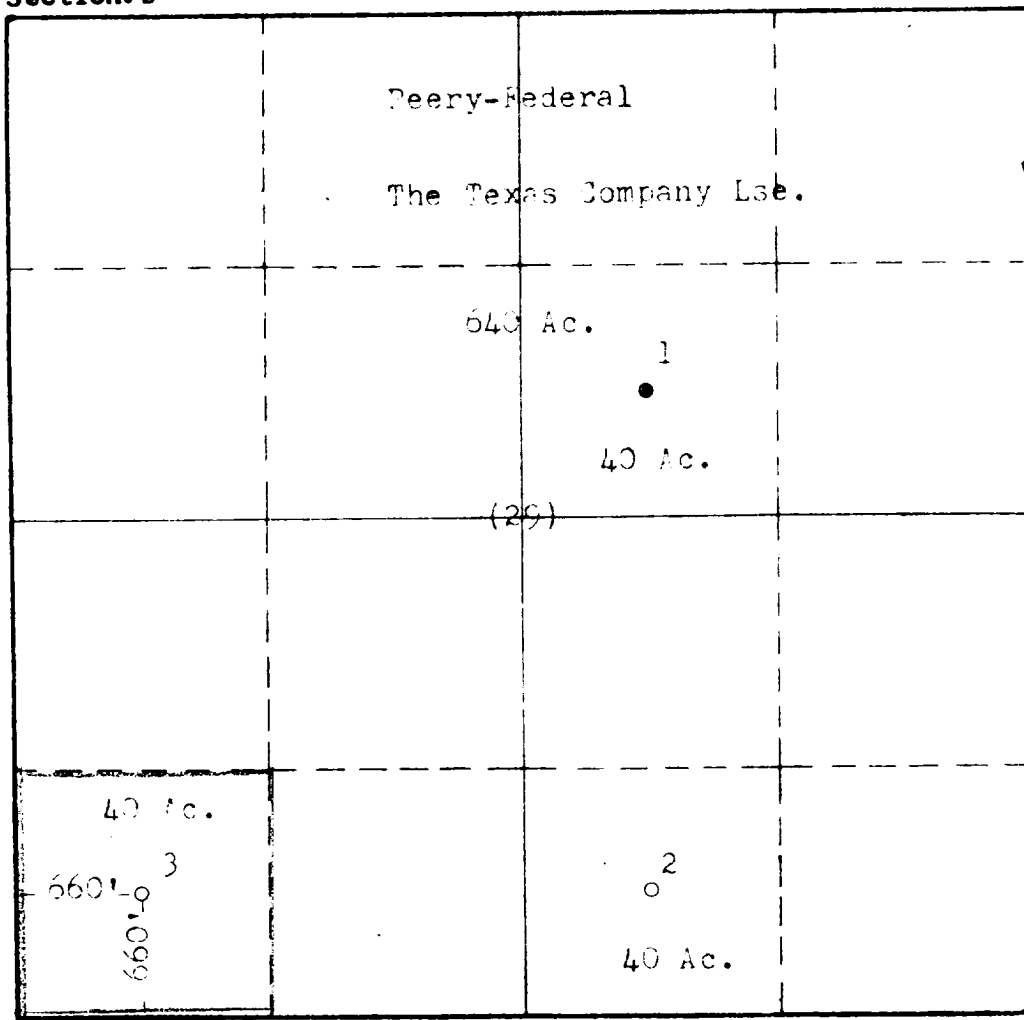

This is to certify that the information in Section A above is true and complete to the best of my knowledge and belief.

THE TEXAS COMPANY

(Operator)

J. J. Tilton

(Representative)

Division Civil Engineer
Box 1720, Fort Worth, Tex.
Address

This is to certify that the well location shown on the plat in Section B was plotted from field notes of actual surveys made by me or under my supervision and that the same is true and correct to the best of my knowledge and belief.

Date Surveyed 4-2-59

J. J. Tilton
Registered Professional
Engineer and/or Land Surveyor.

Certificate No. 8174

(See instructions for completing this form on the reverse side)

Robert Adams
March 9-8-88