

UNITED STATES
DEPARTMENT OF THE INTERIOR
GEOLOGICAL SURVEY

APPLICATION FOR PERMIT TO DRILL, DEEPEN, OR PLUG BACK

1a. TYPE OF WORK
DRILL ☐ RE-ENTRY ☐ DEEPEN ☐ PLUG BACK ☐b. TYPE OF WELL
OIL WELL ☒ GAS WELL ☐ OTHER ☐ SINGLE ZONE ☐ MULTIPLE ZONE ☐2. NAME OF OPERATOR
McClellan Oil Corporation3. ADDRESS OF OPERATOR
P. O. Box 848, Roswell, NM 882014. LOCATION OF WELL (Report location clearly and in accordance with any State requirements.)*
At surface1980' FSL & 660' FEL
At proposed prod. zone

14. DISTANCE IN MILES AND DIRECTION FROM NEAREST TOWN OR POST OFFICE*

15 miles North of Loco Hills, N.M.

15. DISTANCE FROM PROPOSED*
LOCATION TO NEAREST
PROPERTY OR LEASE LINE, FT.
(Also to nearest drig. unit line, if any) 660'16. NO. OF ACRES IN LEASE
64018. DISTANCE FROM PROPOSED LOCATION*
TO NEAREST WELL, DRILLING, COMPLETED,
OR APPLIED FOR, ON THIS LEASE, FT.

Re-entry

19. PROPOSED DEPTH
Clean-out 3600'

21. ELEVATIONS (Show whether DF, RT, GR, etc.)

3945' G.L.

23. PROPOSED CASING AND CEMENTING PROGRAM

SIZE OF HOLE	SIZE OF CASING	WEIGHT PER FOOT	SETTING DEPTH	QUANTITY OF CEMENT
* 20"	18"		80'	Conductor casing
* 15"	13 3/8"	48 lb.	460'	350 sx. Circulated
* 10"	9 5/8"	36 lb.	2929'	600 sx. Circulated
8"	4 1/2"	9 1/2 lb.	3600'	200 sx.

This is a re-entry of the Texaco No. 1 Elliott Federal Shell, P & A 5/29/59. Propose to clean out and test the San Andres formation at an approximate depth of 3600'. If production is indicated will run casing and attempt completion. Cortez Drilling Company, P. O. Box 848, Roswell, NM 88201 will be the contractor. All original roads and location are intact and will be utilized. A small cable tool pit will be opened on the existing pad.

* Casing now in hole.

IN ABOVE SPACE DESCRIBE PROPOSED PROGRAM: If proposal is to deepen or plug back, give data on present productive zone and proposed new productive zone. If proposal is to drill or deepen directionally, give pertinent data on subsurface locations and measured and true vertical depths. Give blowout preventer program, if any.

SIGNED

TITLE Operator

DATE 4/20/79

(This space for Federal or State office use)

PERMIT NO.

APPROVAL DATE

APPROVED BY

TITLE ACTING DISTRICT ENGINEER

DATE APR 24 1979

CONDITIONS OF APPROVAL, IF ANY:

RECEIVED

APR 3 0 1979

OIL CONSERVATION COMM.
HOBBS, N. M.

NEW MEXICO OIL CONSERVATION COMMISSION
WELL LOCATION AND ACREAGE DEDICATION PLAT

Form C-102
Supersedes C-128
Effective 1-1-65

All distances must be from the outer boundaries of the Section.

Operator McClellan Oil Corporation		Lease Federal "5"		Well No. 1
Unit Letter I	Section 30	Township 15-S	Range 30-E	County Chaves
Actual Footage Location of Well: 1980' feet from the South line and 660' feet from the East line				
Ground Level Elev. 3945'	Producing Formation San Andres	Pool Wildcat - re-entry	Dedicated Acreage: 40 Acres	

1. Outline the acreage dedicated to the subject well by colored pencil or hatchure marks on the plat below.
2. If more than one lease is dedicated to the well, outline each and identify the ownership thereof (both as to working interest and royalty).
3. If more than one lease of different ownership is dedicated to the well, have the interests of all owners been consolidated by communitization, unitization, force-pooling, etc?

☐ Yes ☐ No If answer is "yes," type of consolidation _____

If answer is "no," list the owners and tract descriptions which have actually been consolidated. (Use reverse side of this form if necessary.) _____

No allowable will be assigned to the well until all interests have been consolidated (by communitization, unitization, forced-pooling, or otherwise) or until a non-standard unit, eliminating such interests, has been approved by the Commission.

RECEIVED

APR 20 1979

U.S. GEOLOGICAL SURVEY
ALBUQUERQUE, NEW MEXICO

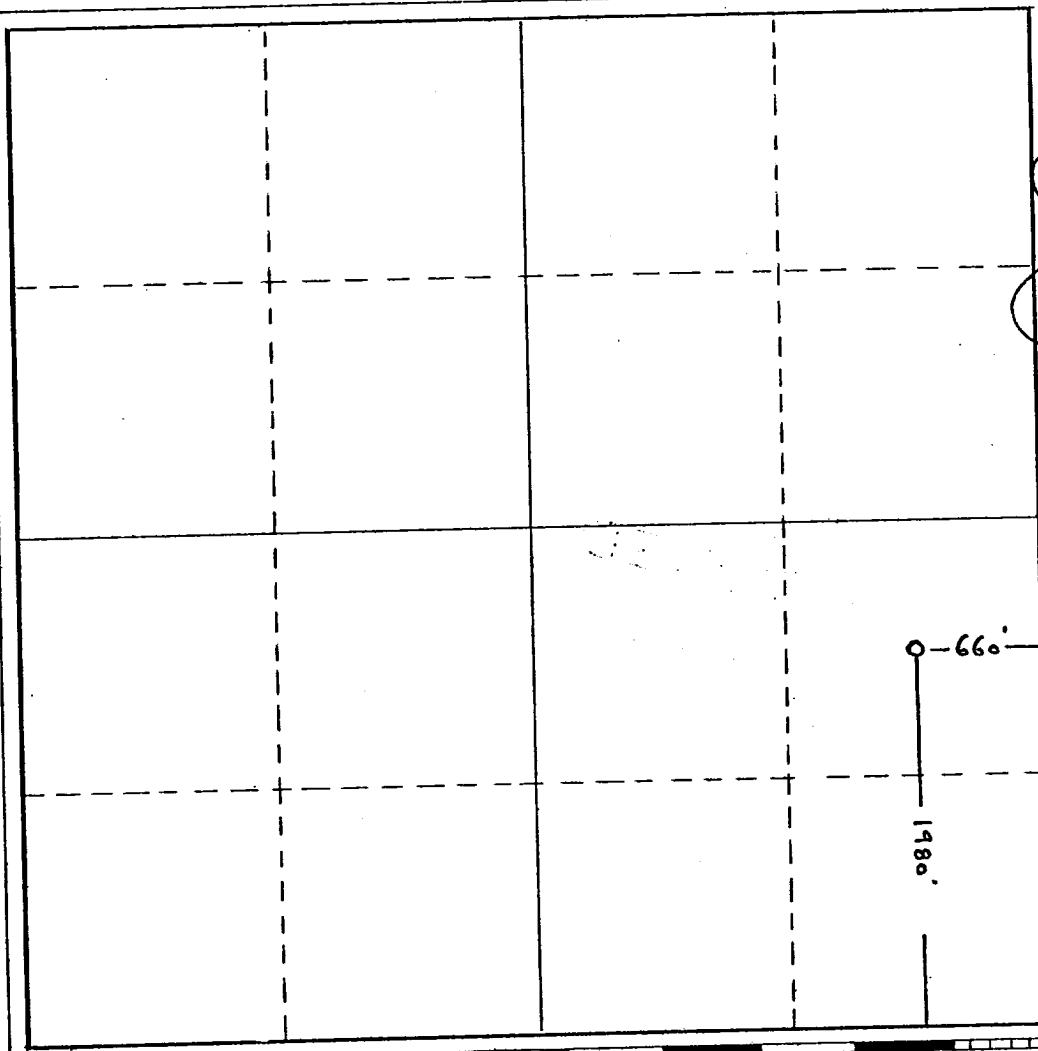

CERTIFICATION

I hereby certify that the information contained herein is true and complete to the best of my knowledge and belief.

Jack L. McClellan
Name
Jack L. McClellan
Position
President

Company
McClellan Oil Corporation

Date
4/20/79

I hereby certify that the well location shown on this plat was plotted from field notes of actual surveys made by me or under my supervision, and that the same is true and correct to the best of my knowledge and belief.

See attached original

Date Surveyed
1/27/59

Registered Professional Engineer and/or Land Surveyor

See attached original

Certificate No.

1467

RECEIVED

APR 30 1979

OIL CONSERVATION COMMISSION
HOUSTON, TEXAS

NEW MEXICO OIL CONSERVATION COMMISSION

Well Location and Acreage Dedication Plat

Section A.

Date January 29, 1959

Operator Shell Oil Company Lease Elliott-Federal
Well No. 1 Unit Letter I Section 30 Township 15S Range 30E NMPM
Located 1980 Feet From south Line, 660 Feet From east Line
County Chaves G. L. Elevation 3920 (est.) Dedicated Acreage 160 Acres
Name of Producing Formation Devonian (Ellenburger) Pool Little Lucky Lake

1. Is the Operator the only owner* in the dedicated acreage outlined on the plat below?
Yes _____ No X.
2. If the answer to question one is "no," have the interests of all the owners been consolidated by communitization agreement or otherwise? Yes X No _____. If answer is "yes," Type of Consolidation Federal Unit
3. If the answer to question two is "no," list all the owners and their respective interests below:

Owner

Land Description

Section B

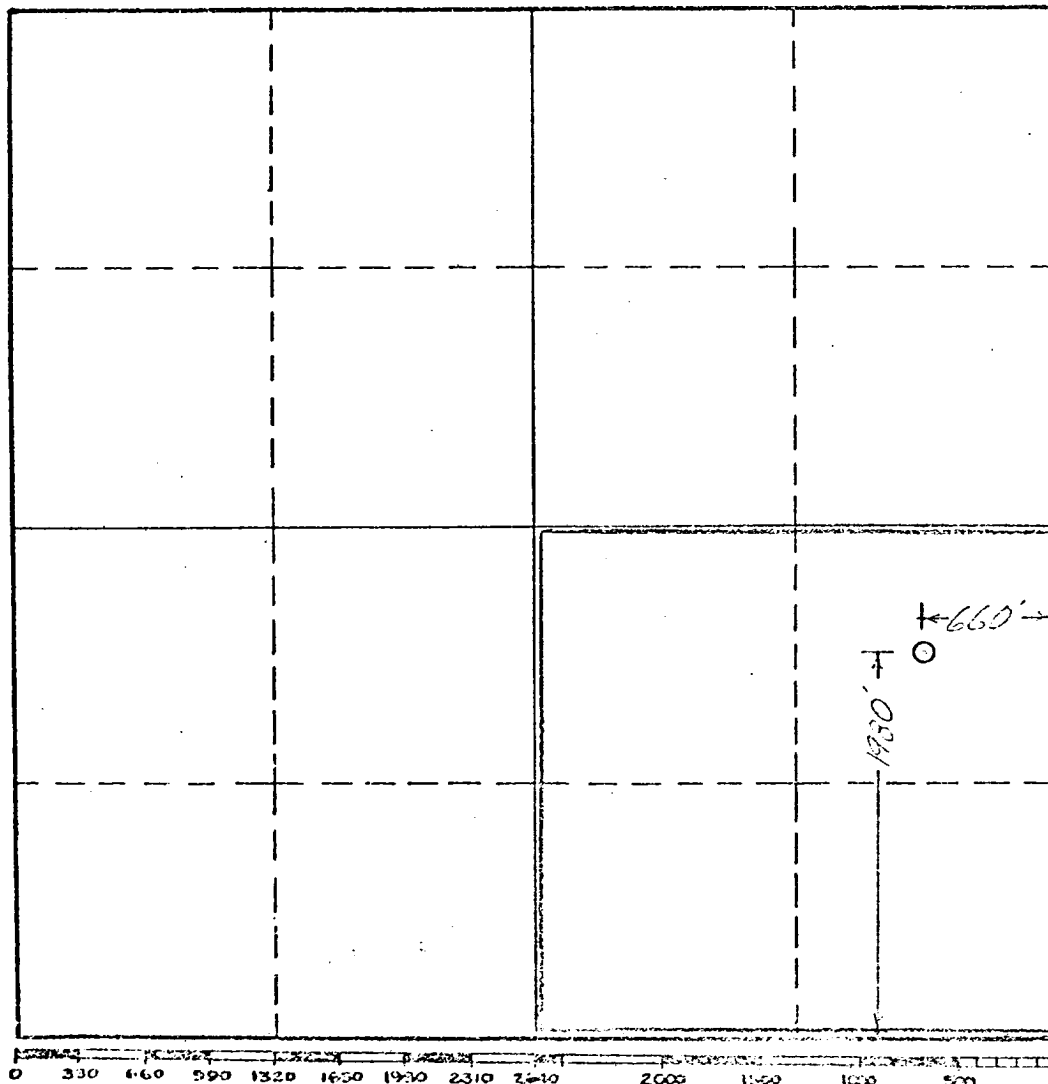

This is to certify that the information in Section A above is true and complete to the best of my knowledge and belief.

The Texas Company

Unit (Operator) by Shell Oil Company, Agent

/ Rex C. Cabaniss
(Representative) *[Signature]*

Box 845, Roswell, New Mexico
Address

This is to certify that the well location shown on the plat in Section B was plotted from field notes of actual surveys ~~made~~ ^{witnessed} by me or under my supervision and that the same is true and correct to the best of my knowledge and belief.

Date Surveyed 1-27-59

[Signature]
Registered Professional
Engineer and/or Land Surveyor.
SHELL OIL COMPANY

RECEIVED

APR 25 1979

O.C.C.
ARTERIA, OFFICE

RECEIVED

APR 30 1979

OIL COMPANY, INC. COPIES
HOURS: 9:00 AM