

(SUBMIT IN TRIPLICATE)

Land Office

Lease No. **NM-01171**

Unit **RECEIVED**

APR 18 1961

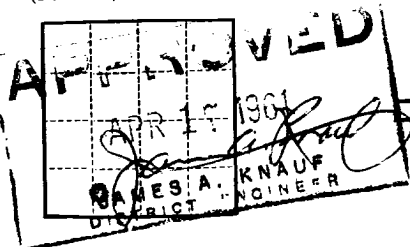

UNITED STATES
DEPARTMENT OF THE INTERIOR
GEOLOGICAL SURVEY

SUNDRY NOTICES AND REPORTS ON WELLS

NOTICE OF INTENTION TO DRILL	XX	SUBSEQUENT REPORT OF WATER SHUT-OFF	
NOTICE OF INTENTION TO CHANGE PLANS		SUBSEQUENT REPORT OF SHOOTING OR ACIDIZING	
NOTICE OF INTENTION TO TEST WATER SHUT-OFF		SUBSEQUENT REPORT OF ALTERING CASING	
NOTICE OF INTENTION TO RE-DRILL OR REPAIR WELL		SUBSEQUENT REPORT OF RE-DRILLING OR REPAIR	
NOTICE OF INTENTION TO SHOOT OR ACIDIZE		SUBSEQUENT REPORT OF ABANDONMENT	
NOTICE OF INTENTION TO PULL OR ALTER CASING		SUPPLEMENTARY WELL HISTORY	
NOTICE OF INTENTION TO ABANDON WELL			

(INDICATE ABOVE BY CHECK MARK NATURE OF REPORT, NOTICE, OR OTHER DATA)

Lease No. **205289**
K. McIntosh Federal

April 13, 19**61**

Well No. **2** is located **330** ft. from **S** line and **1980** ft. from **W** line of sec. **34**

SE/4 SW/4 Sec. 34 **T-15-S R-30-E** **NMPM**
(1/4 Sec. and Sec. No.) (Twp.) (Range) (Meridian)
Undesignated **Chaves** **New Mexico**
(Field) (County or Subdivision) (State or Territory)

The elevation of the derrick floor above sea level is **4008** ft.

DETAILS OF WORK

(State names of and expected depths to objective sands; show sizes, weights, and lengths of proposed casings; indicate mudding jobs, cementing points, and all other important proposed work)

OBJECTIVE FORMATIONS: (TOPS)	SIZE CASING	CASING PROGRAM (APPROX.)
Anhydrite 600'		Set at Cement
Salt 1505'	7-5/8" 24# New	640' 300 sz 45 gel*
Yates 1673'	4-1/2" 9.5# New	3385' 200 sz 45 gel
Queen 2462'		
Grayburg 2829'		
Premier 3147'		
San Andres 3169'		
Total Depth 3385'		

*100 sz reg.

RECEIVED

APR 17 1961

U. S. GEOLOGICAL SURVEY
ARTESIA, NEW MEXICO

I understand that this plan of work must receive approval in writing by the Geological Survey before operations may be commenced.

Company **TEXACO Inc.**

Address **P. O. Box 3109**

Midland, Texas

TEXACO Inc.

By **J. J. Velten**
Title **Division Civil Engineer**

Lse. No. 205289

NEW MEXICO OIL CONSERVATION COMMISSION

FORM C-128
Revised 5/1/57

WELL LOCATION AND ACREAGE DEDICATION PLAT RECEIVED

SEE INSTRUCTIONS FOR COMPLETING THIS FORM ON THE REVERSE SIDE

SECTION A

APR 18 1961

Operator TEXACO Inc.		Lease K. McIntosh Federal		Well No. O. C. C. 2
Unit Letter N	Section 34	Township 15 South	Range 30 East	County ARTESIA, OFFICE Chaves
Actual Footage Location of Well: 330 feet from the South line and 1980 feet from the West line Sec. 34				
Ground Level Elev. 3997	Producing Formation Premier Sand		Pool Undesignated	Dedicated Acreage: 40 Acres

1. Is the Operator the only owner in the dedicated acreage outlined on the plat below? YES ☒ NO ____ . ("Owner" means the person who has the right to drill into and to produce from any pool and to appropriate the production either for himself or for himself and another. (65-3-29 (e) NMSA 1935 Comp.)
2. If the answer to question one is "no," have the interests of all the owners been consolidated by communitization agreement or otherwise? YES ____ NO ____ . If answer is "yes," Type of Consolidation ____
3. If the answer to question two is "no," list all the owners and their respective interests below:

Owner	Land Description

SECTION B

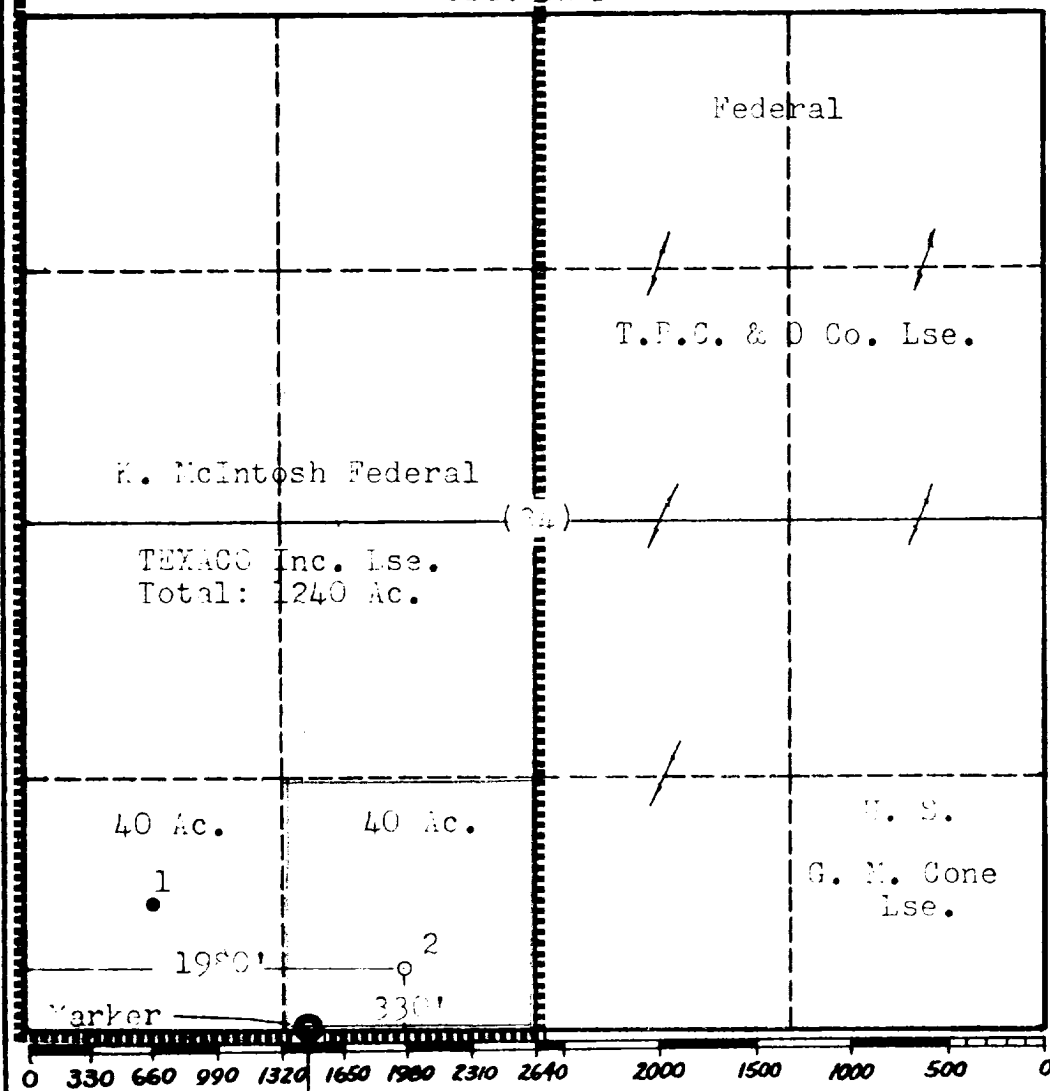

CERTIFICATION

I hereby certify that the information in SECTION A above is true and complete to the best of my knowledge and belief.

Name **J. J. Velten**
Position **Division Civil Engineer**
Company **TEXACO Inc.**
Date **4/12/61**

I hereby certify that the well location shown on the plat in SECTION B was plotted from field notes of actual surveys made by me or under my supervision, and that the same is true and correct to the best of my knowledge and belief.

Date Surveyed **4/11/61**
Registered Professional Engineer and/or Land Surveyor **J. J. Velten**
Certificate No. **8174**