

(SUBMIT IN TRIPLICATE)
HOODS OFFICE O. C. C.
UNITED STATES
DEPARTMENT OF THE INTERIOR
GEOLOGICAL SURVEY

Office New Mexico
Lease No. RM 02983
Unit _____

SUNDRY NOTICES AND REPORTS ON WELLS

NOTICE OF INTENTION TO DRILL.....	<input checked="" type="checkbox"/>	SUBSEQUENT REPORT OF WATER SHUT-OFF.....	
NOTICE OF INTENTION TO CHANGE PLANS.....		SUBSEQUENT REPORT OF SHOOTING OR ACIDIZING.....	
NOTICE OF INTENTION TO TEST WATER SHUT-OFF.....		SUBSEQUENT REPORT OF ALTERING CASING.....	
NOTICE OF INTENTION TO RE-DRILL OR REPAIR WELL.....		SUBSEQUENT REPORT OF RE-DRILLING OR REPAIR.....	
NOTICE OF INTENTION TO SHOOT OR ACIDIZE.....		SUBSEQUENT REPORT OF ABANDONMENT.....	
NOTICE OF INTENTION TO PULL OR ALTER CASING.....		SUPPLEMENTARY WELL HISTORY.....	
NOTICE OF INTENTION TO ABANDON WELL.....			

(INDICATE ABOVE BY CHECK MARK NATURE OF REPORT, NOTICE, OR OTHER DATA)

December 16, 1957

Well No. 1 Getty/ is located 660 ft. from [S] line and 2140 ft. from [W] line of sec. 6

Center SE 1/4, Sec. 6 7 South - 31 East NPM
(1/4 Sec. and Sec. No.) (Twp.) (Range) (Meridian)

Lease Wolfcamp Chaves New Mexico
(Field) (County or Subdivision) (State or Territory)

The elevation of the derrick floor above sea level is 4320 ft. Will advise later

DETAILS OF WORK

(State names of and expected depths to objective sands; show sizes, weights, and lengths of proposed casings; indicate mudding jobs, cementing points, and all other important proposed work)

Will drill with rotary tool to T.D.

Top San Andres	2800'
Top Glorieta	4015'
Top Tubbs	5620'
Top Abo	6315'
Top Hanco	7060'
Top Mississippian	8285'
Top Devonian	8870'
T. D.	9000'

Will set 225' 13 3/8" 40# cementless API. will circulate cement and wait 24 hrs.

Will set 610' 8 5/8" 32# J-55

2540' 8 5/8" 24# J-55

2150' with 600 max - 36 hrs. wait, test with 1000# pressure

I understand that this plan of work must receive approval in writing by the Geological Survey before operations may be commenced.

Company Central Leduc Oils Inc.

Address Box 805

Roswell, New Mexico

By James T. [Signature]
Title Attorney & Agent

NEW MEXICO OIL CONSERVATION COMMISSION
Well Location and Acreage Dedication Plat

Section A.

JUN 28 11 33 AM '66

Date December 18, 1957

Operator Central Lumber Co., Inc. Lease Oil & Gas
Well No. 1 Unit Letter W Section 8 Township 27 South Range 22 East NMPM
Located 2140 Feet From West Line, 660 Feet From South Line
County Chaves G. L. Elevation 4530 Dedicated Acreage _____ Acres
Name of Producing Formation Wolfcamp Pool Wolfcamp

1. Is the Operator the only owner* in the dedicated acreage outlined on the plat below?
Yes X No _____.
2. If the answer to question one is "no," have the interests of all the owners been consolidated by communitization agreement or otherwise? Yes _____ No _____. If answer is "yes," Type of Consolidation _____
3. If the answer to question two is "no," list all the owners and their respective interests below:

Owner

Land Description

Central Lumber Co., Inc.

Section 8

Section B

R31E

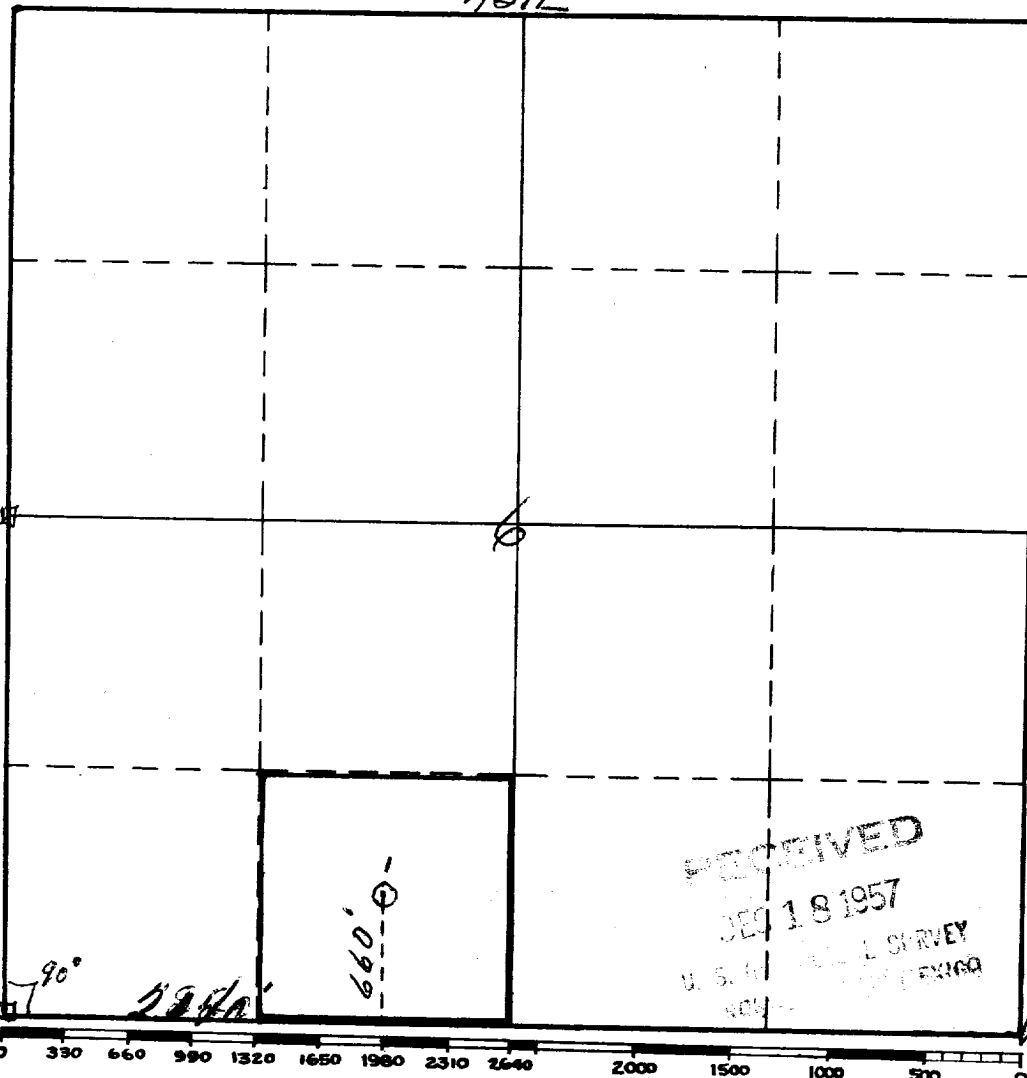

This is to certify that the information in Section A above is true and complete to the best of my knowledge and belief.

Central Lumber Co., Inc.
(Operator)

By James H. Brown
(Representative)

Box 512, Roswell, New Mexico
Address

This is to certify that the well location shown on the plat in Section B was plotted from field notes of actual surveys made by me or under my supervision and that the same is true and correct to the best of my knowledge and belief.

Date Surveyed Dec 16, 1957
James H. Brown
Registered Professional
Engineer and/or Land Surveyor.

Certificate No. 542

(See instructions for completing this form on the reverse side)

INSTRUCTIONS FOR COMPLETION:

1. Operator shall furnish and certify to the information called for in Section A.
2. Operator shall outline the dedicated acreage for both oil and gas wells on the plat in Section B.
3. A registered professional engineer or land surveyor registered in the State of New Mexico or approved by the Commission shall show on the plat the location of the well and certify this information in the space provided.
4. All distances shown on the plat must be from the outer boundaries of Section.
5. If additional space is needed for listing owners and their respective interests as required in question 3, Section A, please use space below

* "Owner" means the person who has the right to drill into and to produce from any pool and to appropriate the production either for himself or for himself and another. (65-3-29 (e) NMSA 1953 Comp.)