

(SUBMIT IN TRIPLICATE)

UNITED STATES
DEPARTMENT OF THE INTERIOR
GEOLOGICAL SURVEY

Land Office _____
Lease No. **12 06890**
Unit _____

SUNDRY NOTICES AND REPORTS ON WELLS

NOTICE OF INTENTION TO DRILL	<input checked="" type="checkbox"/>	SUBSEQUENT REPORT OF WATER SHUT-OFF	
NOTICE OF INTENTION TO CHANGE PLANS		SUBSEQUENT REPORT OF SHOOTING OR ACIDIZING	
NOTICE OF INTENTION TO TEST WATER SHUT-OFF		SUBSEQUENT REPORT OF ALTERING CASING	
NOTICE OF INTENTION TO RE-DRILL OR REPAIR WELL		SUBSEQUENT REPORT OF RE-DRILLING OR REPAIR	
NOTICE OF INTENTION TO SHOOT OR ACIDIZE		SUBSEQUENT REPORT OF ABANDONMENT	
NOTICE OF INTENTION TO PULL OR ALTER CASING		SUPPLEMENTARY WELL HISTORY	
NOTICE OF INTENTION TO ABANDON WELL			

(INDICATE ABOVE BY CHECK MARK NATURE OF REPORT, NOTICE, OR OTHER DATA)

October 25, 1956

Well No. **3-3** is located **1650** ft. from **[N]** line and **1900** ft. from **[W]** line of sec. **3**

1 (1/4 Sec. and Sec. No.) **15-6** (Twp.) **31-6** (Range) **N.M.P.M.** (Meridian)
Cogswell Green (Field) **Green** (County or Subdivision) **New Mexico** (State or Territory)

The elevation of **ground level** above sea level is **4415.9** ft.

DETAILS OF WORK

(State names of and expected depths to objective sands; show sizes, weights, and lengths of proposed casings; indicate mudding jobs, cementing points, and all other important proposed work)

Drill 11" hole to approximately 320' and cement 8-5/8" casing with 175 sacks.

Drill 7-7/8" hole to 3130'.

Core Green sand to check possible production.

If production is indicated, cement 3-1/2" casing at approximately 3130' with 225 sacks cement plus 1/2 gal and 225 sacks of Stacks-Crete.

ILLEGIBLE

I understand that this plan of work must receive approval in writing by the Geological Survey before operations may be commenced.

Company **Union Oil Company of California**

Address **619 West Texas Avenue**

Midland, Texas

By **K.W. Gardner**

Title **Drilling Supt.**

NEW MEXICO
L CONSERVATION COMMISSI

Form C-128

Well Location and/or Gas Proration Plat

Date 10-22-56

Operator UNION OIL CO. OF CALIFORNIA

Lease FEDERAL STEVENS

Well No. 3-3 Section 3 Township 15-5 Range 31 E NMPM

Located 1650 Feet From NORTH Line, 1980 Feet From WEST Line,

CHAVES

County, New Mexico. G. L. Elevation 4415.9

Name of Producing Formation _____ Pool _____ Dedicated Acreage _____

(Note: All distances must be from outer boundaries of Section)

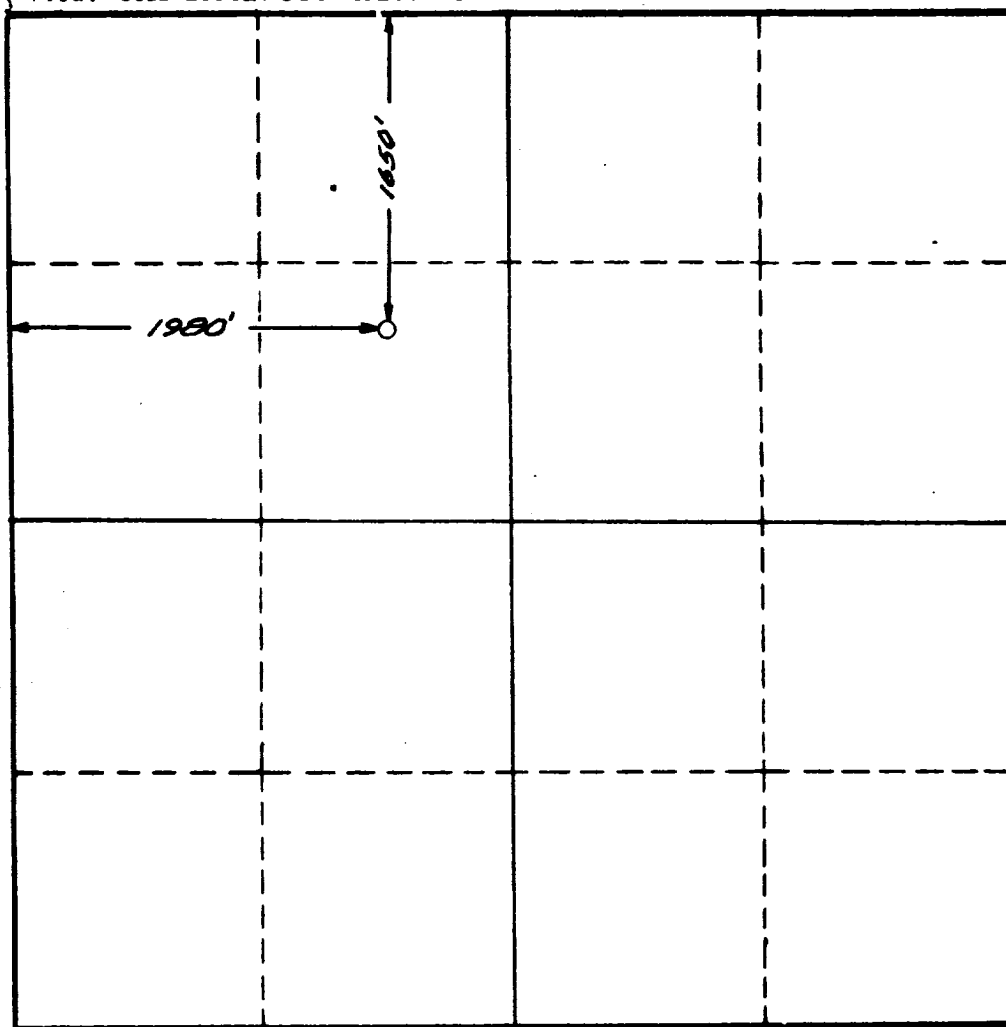

1. Is this Well a Dual Comp. ? Yes ___ No ___.

2. If the answer to Question 1 is yes, are there any other dually completed wells within the dedicated acreage? Yes ___ No ___.

Name _____
Position _____
Representing _____
Address _____

This is to certify that the above plat was prepared from field notes of actual surveys made by me or under my supervision and that the same are true and correct to the best of my knowledge and belief.

Date Surveyed 10-22-56

John H. Watt
Registered Professional Engineer and/or
Land Surveyor

