

(SUBMIT IN TRIPLICATE)

UNITED STATES
DEPARTMENT OF THE INTERIOR
GEOLOGICAL SURVEY

Land Office

Lease No.

Unit 600 J

NOV 13 AM 9:51

SUNDRY NOTICES AND REPORTS ON WELLS

NOTICE OF INTENTION TO DRILL	<input checked="" type="checkbox"/>	SUBSEQUENT REPORT OF WATER SHUT-OFF	
NOTICE OF INTENTION TO CHANGE PLANS		SUBSEQUENT REPORT OF SHOOTING OR ACIDIZING	
NOTICE OF INTENTION TO TEST WATER SHUT-OFF		SUBSEQUENT REPORT OF ALTERING CASING	
NOTICE OF INTENTION TO RE-DRILL OR REPAIR WELL		SUBSEQUENT REPORT OF RE-DRILLING OR REPAIR	
NOTICE OF INTENTION TO SHOOT OR ACIDIZE		SUBSEQUENT REPORT OF ABANDONMENT	
NOTICE OF INTENTION TO PULL OR ALTER CASING		SUPPLEMENTARY WELL HISTORY	
NOTICE OF INTENTION TO ABANDON WELL			

(INDICATE ABOVE BY CHECK MARK NATURE OF REPORT, NOTICE, OR OTHER DATA)

November 12, 1956

Well No. 11-17 is located 2310 ft. from {N} line and 2310 ft. from {E} line of sec. 17

NW of SE 15S 31E NMPM
(1/4 Sec. and Sec. No.) (Twp.) (Range) (Meridian)
Caprock Queen Chaves New Mexico
(Field) (County or Subdivision) (State or Territory)

The elevation of the derrick floor above sea level is ft.

DETAILS OF WORK

(State names of and expected depths to objective sands; show sizes, weights, and lengths of proposed casings; indicate mudding jobs, cementing points, and all other important proposed work)

Objective: Queen sand, 3150'
Casing: 8-5/8" - 300'
5 1/2" - 3150'

I understand that this plan of work must receive approval in writing by the Geological Survey before operations may be commenced.

Company Union Oil Company of California

Address 619 West Texas

Midland, Texas

By A. Mannon

Title District Engineer

NEW MEXICO
OIL CONSERVATION COMMISSION

Form C-128

Well Location and/or Gas Formation Plat

Date 11-10-56

Operator Union Oil Co. of California 1531 Nov 15 AM 9:51 Federal Medlin

Well No. 11-17 Section 17 Township 15 South Range 31 East NMPM

Located 2310 Feet From East Line, 2310 Feet From South Line,

Chaves County, New Mexico. G. L. Elevation _____

Name of Producing Formation _____ Pool _____ Dedicated Acreage _____

(Note: All distances must be from outer boundaries of Section)

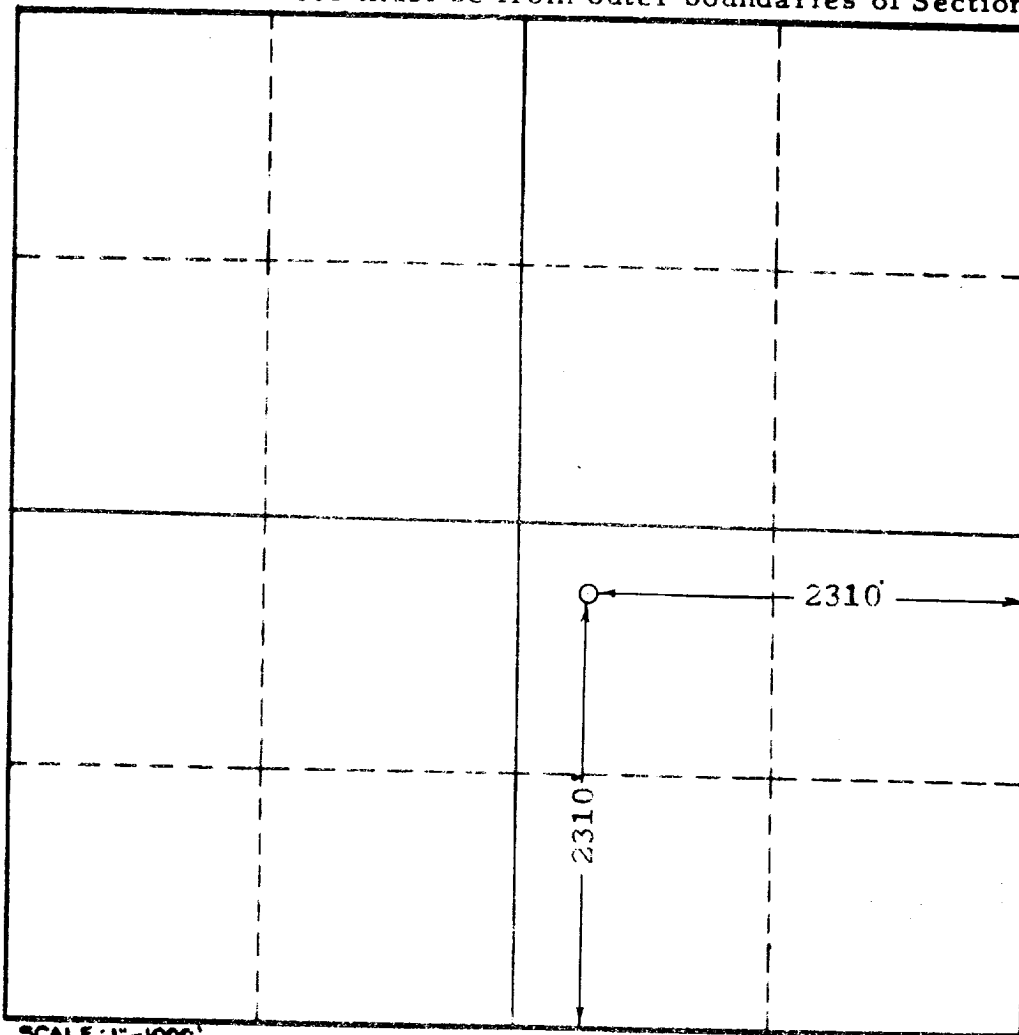

SCALE: 1" = 1000'

1. Is this Well a Dual Comp. ? Yes No
2. If the answer to Question 1 is yes, are there any other dually completed wells within the dedicated acreage? Yes No

This is to certify that the above plat was prepared from field notes of actual surveys made by me or under my supervision and that the same are true and correct to the best of my knowledge and belief.

Name _____
Position _____
Representing _____
Address _____

Date Surveyed 11-10-56
John A. West
Registered Professional Engineer and/or
Land Surveyor