

NEW MEXICO OIL CONSERVATION COMMISSION  
Santa Fe, New Mexico

Form C-101  
Revised (12/1/55)

NOTICE OF INTENTION TO DRILL

(RE-ENTRY)

Notice must be given to the District Office of the Oil Conservation Commission and approval obtained before drilling or recompletion begins. If changes in the proposed plan are considered advisable, a copy of this notice showing such changes will be returned to the sender. Submit this notice in QUINTUPLICATE. One copy will be returned following approval. See additional instructions in Rules and Regulations of the Commission. If State Land submit 6 Copies Attach Form C-128 in triplicate to first 3 copies of form C-101

Lovington, New Mexico

(Place)

3-22-63

(Date)

OIL CONSERVATION COMMISSION  
SANTA FE, NEW MEXICO

Gentlemen:

You are hereby notified that it is our intention to commence the Drilling of a well to be known as

Union Oil Company of California, Operator of the South Caprock Queen Unit

(Company or Operator)

Tract 25

(Lease)

Well No. 3-25

in

C

(Unit)

The well is

located 661 feet from the North line and 1985 feet from the

West

Line of Section 20

T. 15-S

R. 31-E

NMPM.

(GIVE LOCATION FROM SECTION LINE)

Caprock Queen

Pool,

Chaves

County

If State Land the Oil and Gas Lease is No.

D-10419

If patented land the owner is

Address

We propose to drill well with drilling equipment as follows:

Rotary

The status of plugging bond is

J.S. Ward and Sons

Artesia N.M.

Drilling Contractor

Pioneer Well Services, Ltd.

Midland, Texas

We intend to complete this well in the Queen Sand

formation at an approximate depth of 3200

feet.

CASING PROGRAM

We propose to use the following strings of Casing and to cement them as indicated:

Size of Hole	Size of Casing	Weight per Foot	New or Second Hand	Depth	Sacks Cement
17"	13-3/8"	40#	N	205	225 *
7-5/8"	4-1/2"	9.5#	N	3200	300

If changes in the above plans become advisable we will notify you immediately.

ADDITIONAL INFORMATION (If recompletion give full details of proposed plan of work.)

\* 13-3/8" casing already in well (cement circulated to surface)

Present condition of well: TD 3200, 13-3/8" C 205.

Propose to: Drill out plugs at surface, 300, 1500, and 3110. Cement 4-1/2" casing at 3200' w/ 300 sz, Log, perforate, treat and complete in the Queen sand.

Approved \_\_\_\_\_, 19\_\_\_\_\_  
Except as follows:

Sincerely yours,

Union Oil Company of California

(Company or Operator)

By

Richard H. Butler

Position Unit Engineer

Send Communications regarding well to

Name Union Oil Company of California

Address 205 E. Washington, Lovington, N.M.

OIL CONSERVATION COMMISSION

By

**NEW MEXICO OIL CONSERVATION COMMISSION**  
**WELL LOCATION AND ACREAGE DEDICATION PLAT**

FORM C-128  
 Revised 5/1/57

SEE INSTRUCTIONS FOR COMPLETING THIS FORM ON THE REVERSE SIDE

**SECTION A**

Operator <b>UNION OIL CO. OF CALIFORNIA</b>			Lease <b>CAPROCK QUEEN UNIT TRACT 25</b>		
Unit Letter <b>C</b>	Section <b>20</b>	Township <b>15 SOUTH</b>	Range <b>31 EAST</b>	County <b>CHAVES</b>	
Actual Footage Location of Well: <b>661</b> feet from the <b>NORTH</b> line and <b>1985</b> feet from the <b>WEST</b> line					
Ground Level Elev. <b>4432.75'</b>	Producing Formation <b>QUEEN SAND</b>		Pool <b>CAPROCK QUEEN</b>		Dedicated Acreage:  Acres

1. Is the Operator the only owner in the dedicated acreage outlined on the plat below? YES ☐ NO ☒ ("Owner" means the person who has the right to drill into and to produce from any pool and to appropriate the production either for himself or for himself and another. (65-3-29 (a) NMSA 1935 Comp.)
2. If the answer to question one is "no," have the interests of all the owners been consolidated by communication agreement or otherwise? YES ☒ NO ☐ . If answer is "yes," Type of Consolidation **Joint Operation**
3. If the answer to question two is "no," list all the owners and their respective interests below.

Owner	Land Description

**SECTION B**

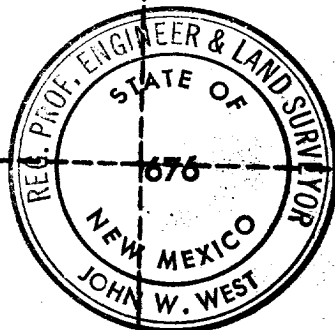
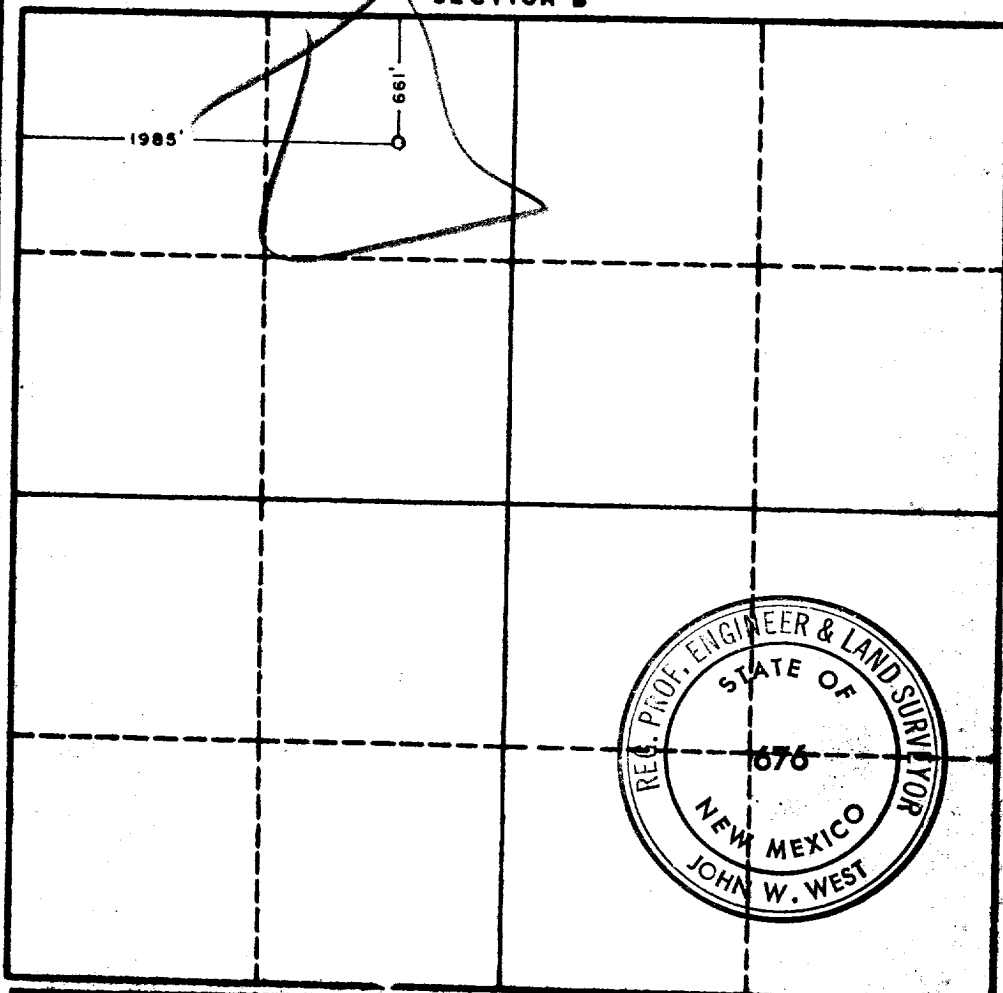

**CERTIFICATION**

I hereby certify that the information in SECTION A above is true and complete to the best of my knowledge and belief.

Name *R.M. Butler*  
 Position *Engineer*  
 Company *Union Oil Co. of Calif.*  
 Date *3-13-63*

I hereby certify that the well location shown on the plat in SECTION B was plotted from field notes of actual surveys made by me or under my supervision, and that the same is true and correct to the best of my knowledge and belief.

Date Surveyed *3-13-63*  
 Registered Professional Engineer and/or Land Surveyor, *John W. West*  
 Signature *[Signature]*  
 State of New Mexico

0 300 600 900 1200 1500 1800 2100 2400 2700 3000