

NEW MEXICO OIL CONSERVATION COMMISSION
Santa Fe, New Mexico

HOBBBS OFFICE OCC
NOTICE OF INTENTION TO DRILL OR RECOMPLETE

Notice must be given to the District Office of the Oil Conservation Commission and approval obtained before drilling or recompletion begins. If changes in the proposed plan are considered advisable, a copy of this notice showing such changes will be returned to the sender. Submit this notice in **QUINTUPLICATE**. One copy will be returned following approval. See additional instructions in Rules and Regulations of the Commission.

Hobbs, New Mexico

(Place)

July 3, 1961

(Date)

OIL CONSERVATION COMMISSION
SANTA FE, NEW MEXICO

Gentlemen:

You are hereby notified that it is our intention to commence the (Drilling) (Recompletion) of a well to be known as

Sunray Mid-Continent Oil Company

(Company or Operator)

H. M. State "AP"

(Lease)

Well No. **1**, in **I** The well is

(Unit)

located **1980** feet from the **south** line and **660** feet from the

east

line of Section **22**, T. **15S**, R. **31E**, NMPM.

Wildcat

Chaves

(GIVE LOCATION FROM SECTION LINE)

Pool, **B-10411** County

If State Land the Oil and Gas Lease is No. **B-10411**

If patented land the owner is

Address

We propose to drill well with drilling equipment as follows: **Rotary to 1500',
Cable tools to 3300'**

The status of plugging bond is **Approved**

Drilling Contractor **Cactus Drilling Company**

We intend to complete this well in the **Penrose** formation at an approximate depth of **3250** feet.

CASING PROGRAM

We propose to use the following strings of Casing and to cement them as indicated:

Size of Hole	Size of Casing	Weight per Foot	New or Second Hand	Depth	Sacks Cement
17 1/2 "	13 3/8	48#	New	350	320
11"	8 5/8	24#	2nd Hand	1500	To be pulled
8"	4 1/2	9.5#	New	3300	150.

If changes in the above plans become advisable we will notify you immediately.

ADDITIONAL INFORMATION (If recompletion give full details of proposed plan of work.)

CEMENT MUST BE CIRCULATED BEHIND

13 3/8 CASING.

Approved....., 19.....
Except as follows:

Sincerely yours,

Sunray Mid-Continent Oil Company

(Company or Operator)

By **H. E. Stettin**

Position **District Engineer**

Send Communications regarding well to

Name **C. T. McClanahan**

Address **Box 128
Hobbs, New Mexico**

OIL CONSERVATION COMMISSION

By **Leshie A. Clements**

Title **Oil & Gas En.**

NEW MEXICO OIL CONSERVATION COMMISSION
WELL LOCATION AND ACREAGE DEDICATION PLAT

FORM C-128
Revised 5/1/57

SEE INSTRUCTIONS FOR COMPLETING THIS FORM ON THE REVERSE SIDE

SECTION A

Operator Sunray Mid Continent Oil Co.			Lease 1961 JUL 3 PM			New Mexico State "AB"			1		
Unit Letter I	Section 22	Township 15 South		Range 31 East	County Chaves						
Actual Footage Location of Well: 1980 feet from the South line and 660 feet from the East line											
Ground Level Elev. 4390.2		Producing Formation			Pool Exploratory			Dedicated Acreage: 60 Acres			

1. Is the Operator the only owner in the dedicated acreage outlined on the plat below? YES ☒ NO ☐ ("Owner" means the person who has the right to drill into and to produce from any pool and to appropriate the production either for himself or for himself and another. (65-3-29 (e) NMSA 1935 Comp.)
2. If the answer to question one is "no," have the interests of all the owners been consolidated by communitization agreement or otherwise? YES ☐ NO ☐ If answer is "yes," Type of Consolidation _____
3. If the answer to question two is "no," list all the owners and their respective interests below:

Owner	Land Description

SECTION B

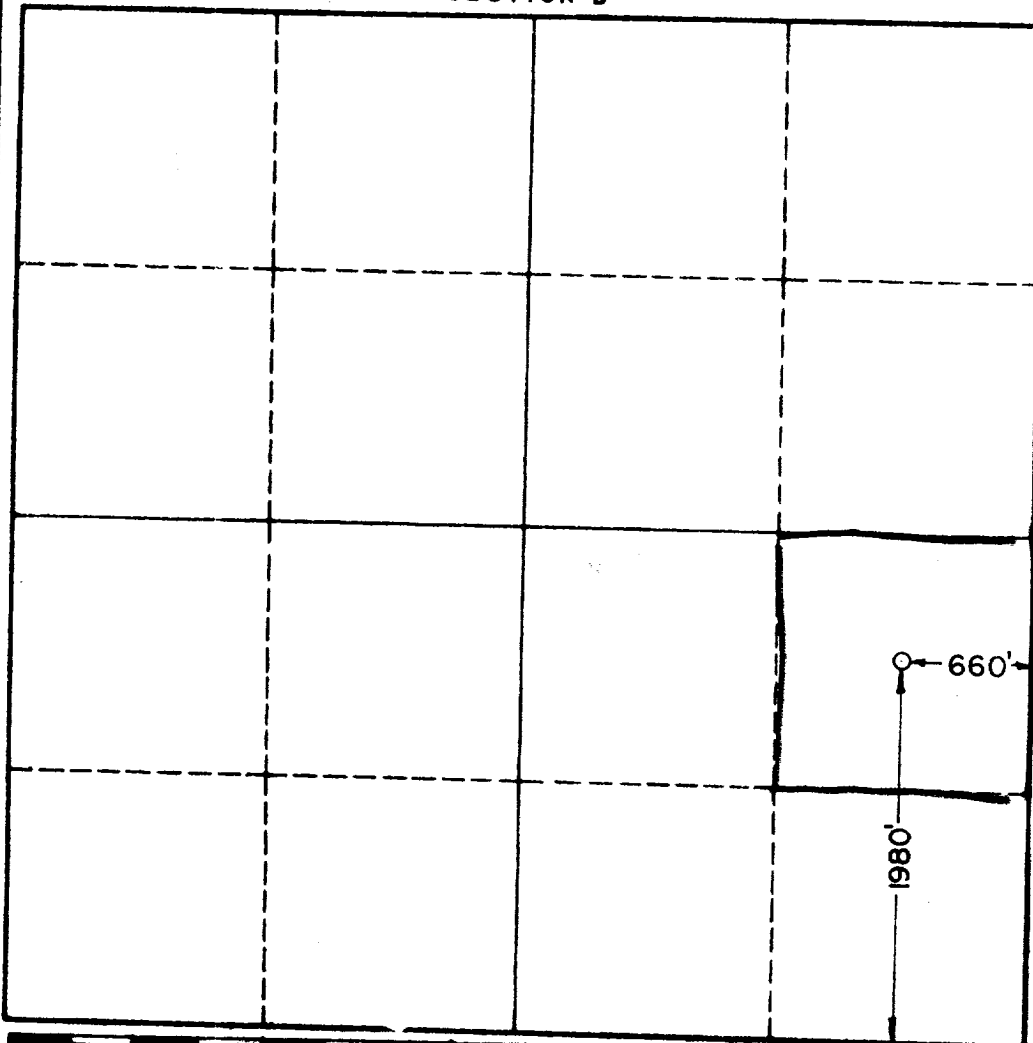

CERTIFICATION

I hereby certify that the information in SECTION A above is true and complete to the best of my knowledge and belief.

Name **R. E. Statton**
Position **District Engineer**
Company **Sunray Mid-Continent Oil Co.**
Date **July 3, 1961**

I hereby certify that the well location shown on the plat in SECTION B was plotted from field notes of actual surveys made by me or under my supervision, and that the same is true and correct to the best of my knowledge and belief.

Date Surveyed **6-30-61**
Registered Professional Engineer and/or Land Surveyor, **JOHN W. WEST**
Certificate No. **N.M. - P.E. & L.S. NO. 676**