

NO. OF COPIES RECEIVED	
DISTRIBUTION	
SANTA FE	
FILE	
U.S.G.S.	
LAND OFFICE	
OPERATOR	

NEW MEXICO OIL CONSERVATION COMMISSION

Form C-101
Revised 1-1-65

5A. Indicate Type of Lease	
STATE <input checked="" type="checkbox"/>	FEE <input type="checkbox"/>
5. State Oil & Gas Lease No.	
E-8664	

APPLICATION FOR PERMIT TO DRILL, DEEPEN, OR PLUG BACK

1a. Type of Work		7. Unit Agreement Name	
b. Type of Well DRILL <input type="checkbox"/> RE-ENTER <input checked="" type="checkbox"/> DEEPEN <input type="checkbox"/> PLUG BACK <input type="checkbox"/> OIL WELL <input checked="" type="checkbox"/> GAS WELL <input type="checkbox"/> OTHER <input type="checkbox"/> SINGLE ZONE <input type="checkbox"/> MULTIPLE ZONE <input type="checkbox"/>		S. Caprock Queen Unit	
2. Name of Operator		8. Farm or Lease Name	
Union Oil Company of California		S. Caprock Queen Unit	
3. Address of Operator		9. Well No.	
P. O. Box 671 Midland, Texas 79702		Tract 48 Well 15	
4. Location of Well UNIT LETTER 0 LOCATED 1980 FEET FROM THE East LINE AND 990 FEET FROM THE South LINE OF SEC. 30 TWP. 15-S RGE. 31-E NMPM		10. Field and Pool, or Wildcat	
		Caprock Queen	
		12. County	
		Chaves	
		19. Proposed Depth	
		3186'	
		19A. Formation	
		Queen Sand	
		20. Rotary or C.T.	
		Rotary	
21. Elevations (Show whether DF, RT, etc.)		21B. Drilling Contractor	
3448'		N/A	
21A. Kind & Status Plug. Bond		22. Approx. Date Work will start	
		Upon Approval	

PROPOSED CASING AND CEMENT PROGRAM

SIZE OF HOLE	SIZE OF CASING	WEIGHT PER FOOT	SETTING DEPTH	SACKS OF CEMENT	EST. TOP
11"	8-5/8"	24#	316'	204	Surface
7-7/8"	5-1/2"	15.5#	3186'	175	N/A

Well was P&A 3-24-72

Application is to re-enter, ^Ltest & evaluate production potential
Cement on the 5-2 casing must be
brought from the top of the salt or
anhydrite to the surface casing by
either circulating with cement or a
DV tool at the top of the salt.

IN ABOVE SPACE DESCRIBE PROPOSED PROGRAM; IF PROPOSAL IS TO DEEPEN OR PLUG BACK, GIVE DATA ON PRESENT PRODUCTIVE ZONE AND PROPOSED NEW PRODUCTIVE ZONE. GIVE BLOWOUT PREVENTER PROGRAM, IF ANY.

I hereby certify that the information above is true and complete to the best of my knowledge and belief.

Signed W.S. Welton ^{FonJAN} J.R. Hughes Title District Drilling Supt. Date Dec. 5, 1983

(This space for State Use)

ORIGINAL SIGNED BY JERRY SEXTON
DISTRICT I SUPERVISOR

DEC 13 1983

APPROVED BY _____ TITLE _____ DATE _____
CONDITIONS OF APPROVAL, IF ANY:

RECEIVED

DEC 12 1983

U.S. AIR FORCE

**NEW MEXICO OIL CONSERVATION COMMISSION
WELL LOCATION AND ACREAGE DEDICATION PLAT**

Form C-102
Supersedes C-128
Effective 1-1-65

All distances must be from the outer boundaries of the Section.

Operator Union Oil Company of California			Lease S. Caprock Queen Unit Tract 48		Well No. 15
Unit Letter 0	Section Sec 30	Township 15-S	Range 31-E	County Chaves	
Actual Footage Location of Well: 1980 feet from the East line and 990 feet from the South line					
Ground Level Elev. 3448'	Producing Formation Queen Sand		Pool Caprock Queen		Dedicated Acreage: 40 Acres

1. Outline the acreage dedicated to the subject well by colored pencil or hatchure marks on the plat below.
2. If more than one lease is dedicated to the well, outline each and identify the ownership thereof (both as to working interest and royalty).
3. If more than one lease of different ownership is dedicated to the well, have the interests of all owners been consolidated by communitization, unitization, force-pooling, etc?

☐ Yes ☐ No If answer is "yes," type of consolidation _____

If answer is "no," list the owners and tract descriptions which have actually been consolidated. (Use reverse side of this form if necessary.) _____

No allowable will be assigned to the well until all interests have been consolidated (by communitization, unitization, forced-pooling, or otherwise) or until a non-standard unit, eliminating such interests, has been approved by the Commission.

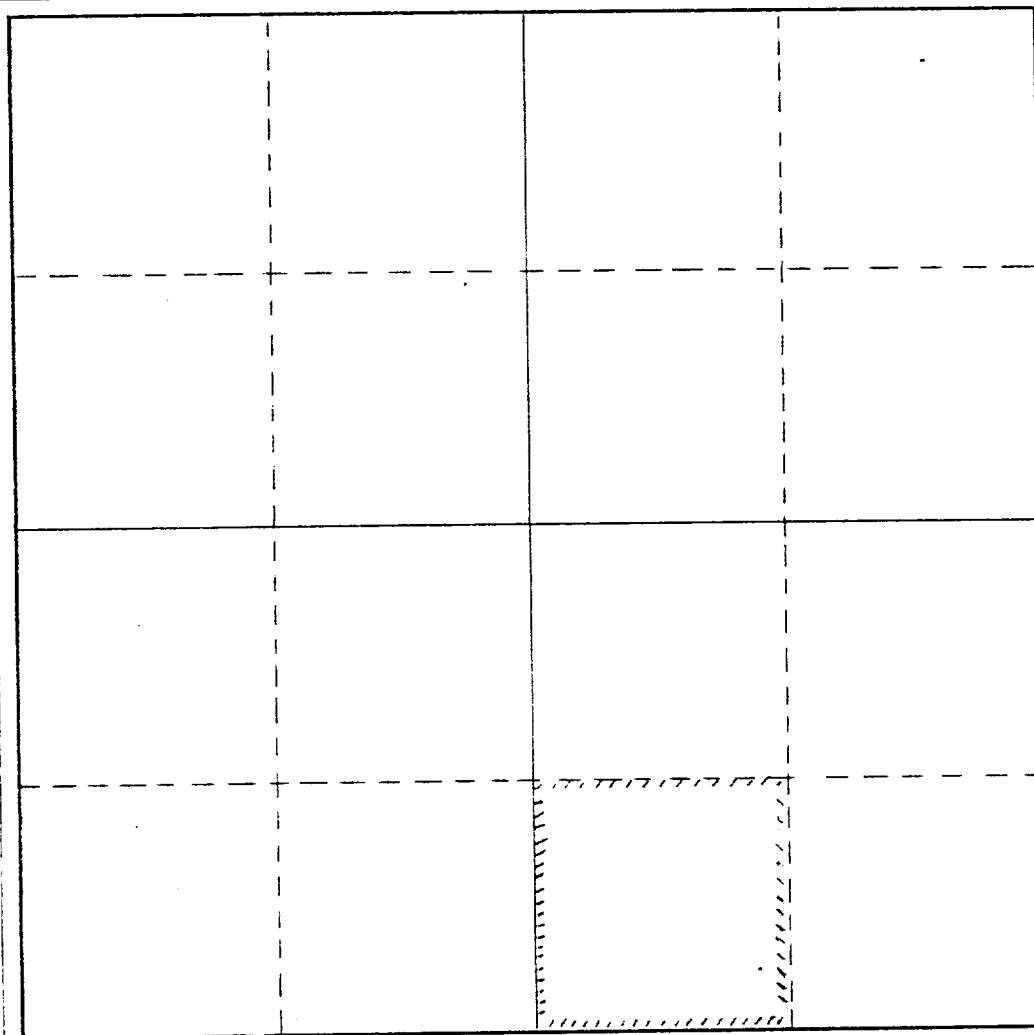

CERTIFICATION

I hereby certify that the information contained herein is true and complete to the best of my knowledge and belief.

W.S. Welton ^{For J.R. Hughes}
Name **J.R. Hughes**

Position
District Drilling Supt.
Company
Union Oil Co. of California

Date
Dec 5, 1983

I hereby certify that the well location shown on this plat was plotted from field notes of actual surveys made by me or under my supervision, and that the same is true and correct to the best of my knowledge and belief.

5-24-55

Date Surveyed

Registered Professional Engineer
and/or Land Surveyor

Certificate No.

0 330 660 990 1320 1650 1980 2310 2640 2000 1500 1000 500 0

RECEIVED
DEC 12 1983
C. G. B.
HARRISVILLE

WELL LOCATION SURVEY PLAT

OPERATOR UNION OIL CO. OF CALIF.

LEASE ~~STATE~~ S CARROCK Queen Unit

WELL NO. 15 TRACT 48

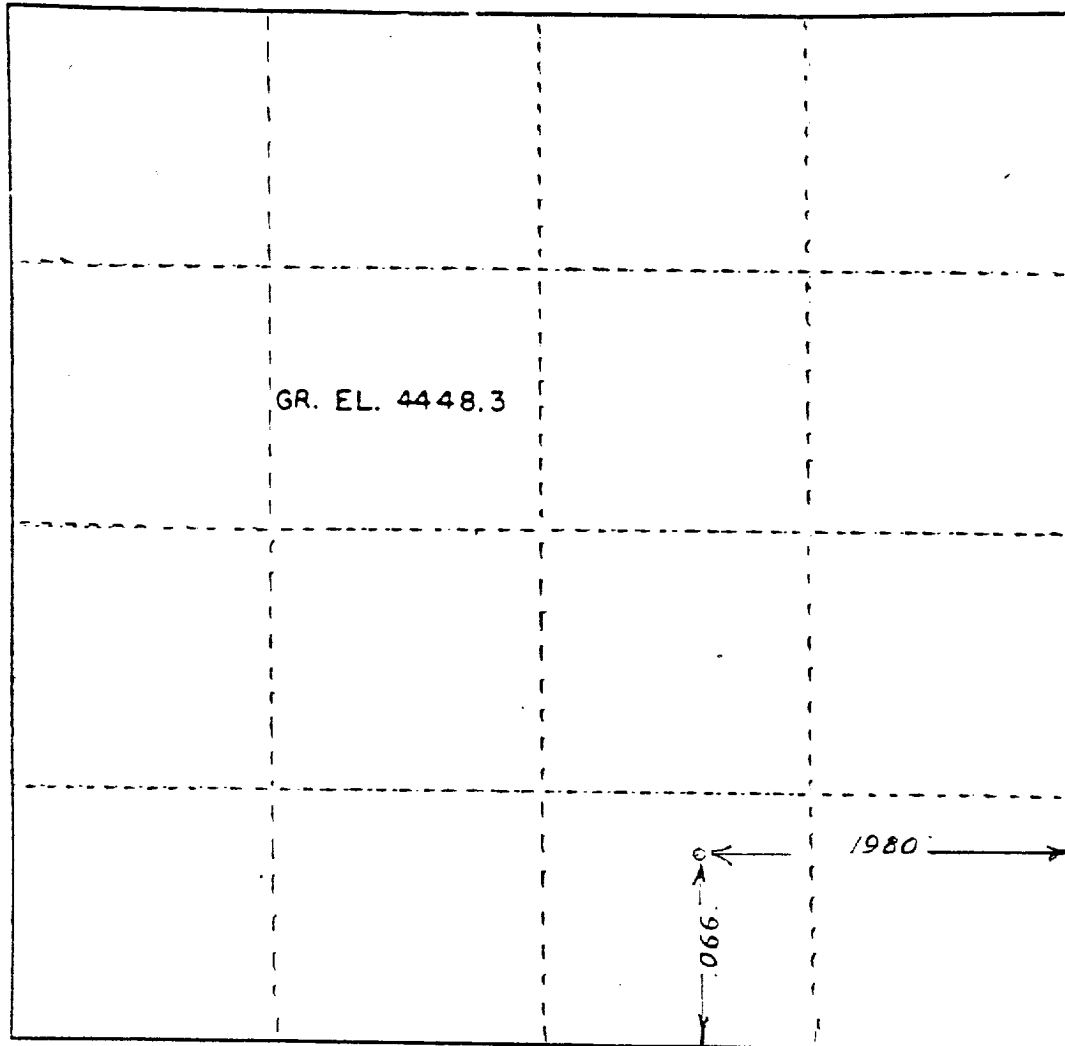

SEC. 30, TWP. 15 S., RGE. 31 E., N.M.P.M.

I HEREBY CERTIFY THAT THIS PLAT WAS MADE
FROM NOTES TAKEN IN THE FIELD BY ME AND
THAT THE SAME IS TRUE AND CORRECT TO THE
BEST OF MY KNOWLEDGE AND BELIEF.

John W West

JOHN W. WEST, PE & LS NO. 676

5-24-55

RECEIVED
DEC 12 1983
C.C.C.
HOBBS COUNTY