

DUPLICATE

NEW MEXICO OIL CONSERVATION COMMISSION

Santa Fe, New Mexico

NOTICE OF INTENTION TO DRILL OR RECOMPLETE

Notice must be given to the District Office of the Oil Conservation Commission and approval obtained before drilling or recompletion begins. If changes in the proposed plan are considered advisable, a copy of this notice showing such changes will be returned to the sender. Submit this notice in QUINTUPLICATE. One copy will be returned following approval. See additional instructions in Rules and Regulations of the Commission.

LODO HILLS, NEW MEXICO
(Place)

Jan. 23, 1957
(Date)

OIL CONSERVATION COMMISSION
SANTA FE, NEW MEXICO

Gentlemen:

You are hereby notified that it is our intention to commence the (Drilling) (Recompletion) of a well to be known as

Colley Green

(Company or Operator)

State

(Lease)

Well No. 1

in

Unit

The well is

located 1050 feet from the north line and 1980 feet from the

east

line of Section 31, T. 15, R. 31, NMPM.

(GIVE LOCATION FROM SECTION LINE)

Colley Green

Pool,

Chaves

County

If State Land the Oil and Gas Lease is No. 8665

If patented land the owner is

Address

We propose to drill well with drilling equipment as follows: Rotary 11' to

top, used and cable tools to drill pay.

The status of plugging bond is hard insurance agency. Oliver H. May

Drilling Contractor Tom Donnelly Drilling Co. & Company
Tools

We intend to complete this well in the used
formation at an approximate depth of 3100' feet.

CASING PROGRAM

We propose to use the following strings of Casing and to cement them as indicated:

| Size of Hole | Size of Casing | Weight per Foot | New or Second Hand | Depth | Sacks Cement |
|--------------|----------------|-----------------|--------------------|--------------|--------------|
| 1" | 8 5/8 | 24 | used | approx. 250' | to surface |
| 9 | 5 | 15 | new | 3050' | 150 sacks |

If changes in the above plans become advisable we will notify you immediately.

ADDITIONAL INFORMATION (If recompletion give full details of proposed plan of work.)

Approved: JAN 30 1957, 19.....
Except as follows:

OIL CONSERVATION COMMISSION

By

E. J. Fischer
Engineer District 1

Title

Sincerely yours,

Roland Rich Wolley
(Company or Operator)

By

J. L. BRISCOE

Position

Send Communications regarding well to

Name

J. L. BRISCOE

Address

Box 392, Lodo Hills, N.M.

NEW MEXICO
OIL CONSERVATION COMMISSION

Form C-128

Well Location and/or Gas Proration Plat

Date January 19th, 1957

Operator Woolley Green Lease 1957 State State

Well No. 1 Section 31 Township 15S Range 31E NMPM

Located 1650' Feet From North Line, 1980 Feet From East Line,

Chaves County, New Mexico. G. L. Elevation _____

Name of Producing Formation Queen Pool Caprock Dedicated Acreage _____

(Note: All distances must be from outer boundaries of Section)

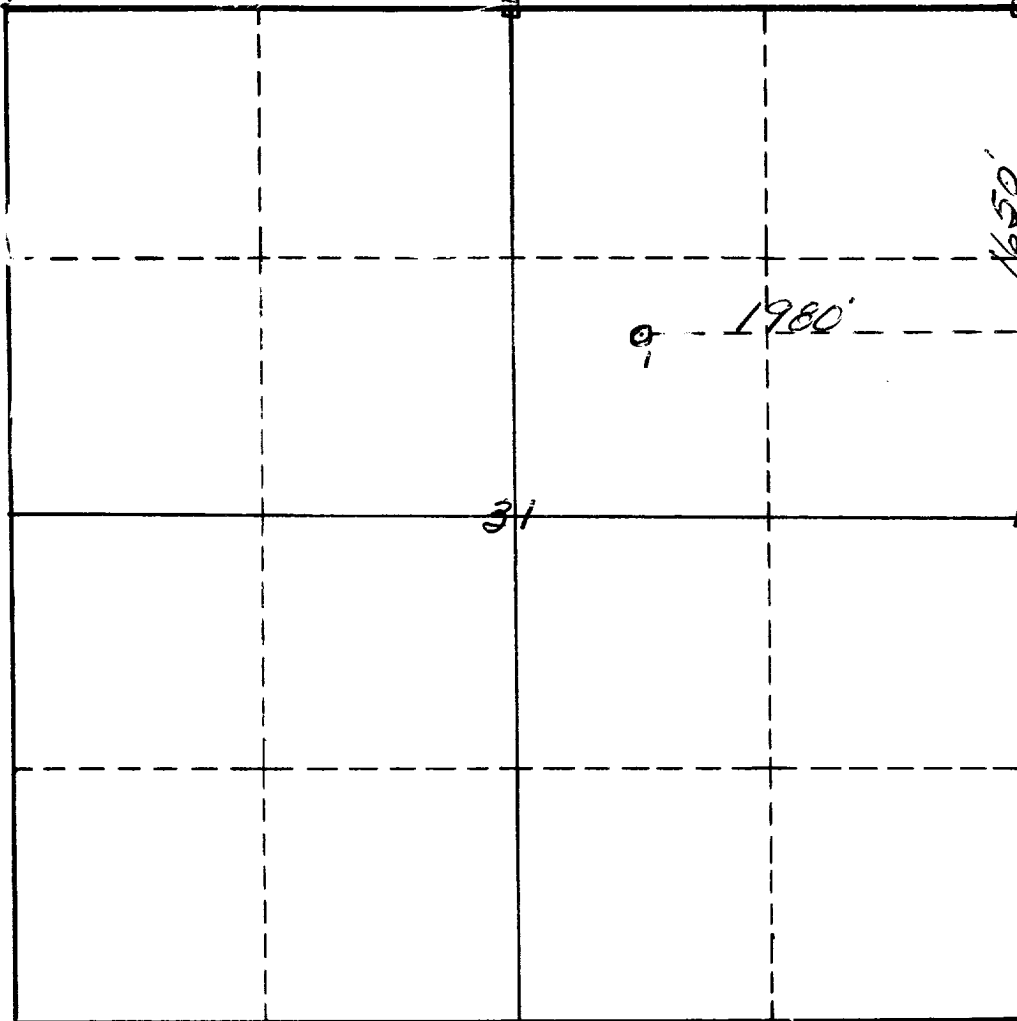

NOTE

This section of form is to be used for gas wells only.



SCALE: 1"=1000'

1. Is this Well a Dual Comp.? Yes ___ No ___.
2. If the answer to Question 1 is yes, are there any other dually completed wells within the dedicated acreage? Yes ___ No ___.

Name _____
Position _____
Representing _____
Address _____

This is to certify that the above plat was prepared from field notes of actual surveys made by me or under my supervision and that the same are true and correct to the best of my knowledge and belief.

Date Surveyed January 19th, 1957
James H. Krum N146S #542
Registered Professional Engineer and/or
Land Surveyor