

NEW MEXICO OIL CONSERVATION COMMISSION  
Santa Fe, New Mexico

MODER OFFICE 000

NOTICE OF INTENTION TO DRILL OR RECOMPLETE

Notice must be given to the District Office of the Oil Conservation Commission and approved before drilling or recompletion begins. If changes in the proposed plan are considered advisable, a copy of this notice showing such changes will be returned to the sender. Submit this notice in QUINTUPLICATE. One copy will be returned following approval. See additional instructions in Rules and Regulations of the Commission.

Hobbs, New Mexico

(Place)

July 11, 1961

(Date)

OIL CONSERVATION COMMISSION  
SANTA FE, NEW MEXICO

Gentlemen:

You are hereby notified that it is our intention to commence the (Drilling) (Recompletion) of a well to be known as

Sunray Mid-Continent Oil Company

(Company or Operator)

N. M. State "AB"

(Lease)

Well No. A-1

in N

(Unit)

located 660 feet from the South line and 1980 feet from the

West

line of Section 12, T. 12S, R. 31E, NMPM.

(GIVE LOCATION FROM SECTION LINE)

Wildcat

Pool, Chaves

County

If State Land the Oil and Gas Lease is No. B-10411

If patented land the owner is

Address

We propose to drill well with drilling equipment as follows: Rotary to 1400

Cable tools to 3200

The status of plugging bond is Approved

Drilling Contractor Cactus Drilling Co.

We intend to complete this well in the Penrose

formation at an approximate depth of 3150 feet.

CASING PROGRAM

We propose to use the following strings of Casing and to cement them as indicated:

Size of Hole	Size of Casing	Weight per Foot	New or Second Hand	Depth	Sacks Cement
17 1/2	13 3/8	48	New	350	320 or circ.
11	8 5/8	24	Used	1400	To be pulled
8	4 1/2	9.5	New	3200	150 X

If changes in the above plans become advisable we will notify you immediately.

ADDITIONAL INFORMATION (If recompletion give full details of proposed plan of work.)

Approved....., 19.....  
Except as follows:

Cement must tie back

into

OIL CONSERVATION COMMISSION

By.....

Title.....

Sincerely yours,

Sunray Mid-Continent Oil Company

(Company or Operator)

By

R. E. Statton

Position District Engineer

Send Communications regarding well to

Name C. T. McGlashan

Address P. O. Box 128

Hobbs, New Mexico

NEW MEXICO OIL CONSERVATION COMMISSION  
WELL LOCATION AND ACREAGE DEDICATION PLAT

FORM C-128  
Revised 5/1/57

SEE INSTRUCTIONS FOR COMPLETING THIS FORM ON THE REVERSE SIDE

SECTION A

Operator <b>Sunray Mid Continent Oil Co.</b>			Lease <b>New Mexico State "AB"</b>			Well No. <b>10:17</b>	
Unit Letter <b>N</b>	Section <b>12</b>	Township <b>12 South</b>	Range <b>31 East</b>	County <b>Chaves</b>			<b>A-1</b>
Actual Footage Location of Well: <b>660</b> feet from the <b>South</b> line and <b>1980</b> feet from the <b>West</b> line							
Ground Level Elev. <b>4424.84</b>		Producing Formation <b>Poncha</b>			Pool <b>Wildcat</b>		Dedicated Acreage: <b>10</b> Acres

1. Is the Operator the only owner in the dedicated acreage outlined on the plat below? YES ☐ NO ☒ ("Owner" means the person who has the right to drill into and to produce from any pool and to appropriate the production either for himself or for himself and another. (65-3-29 (e) NMSA 1935 Comp.)
2. If the answer to question one is "no," have the interests of all the owners been consolidated by communitization agreement or otherwise? YES ☐ NO ☐ If answer is "yes," Type of Consolidation \_\_\_\_\_
3. If the answer to question two is "no," list all the owners and their respective interests below:

Owner	Land Description

SECTION B

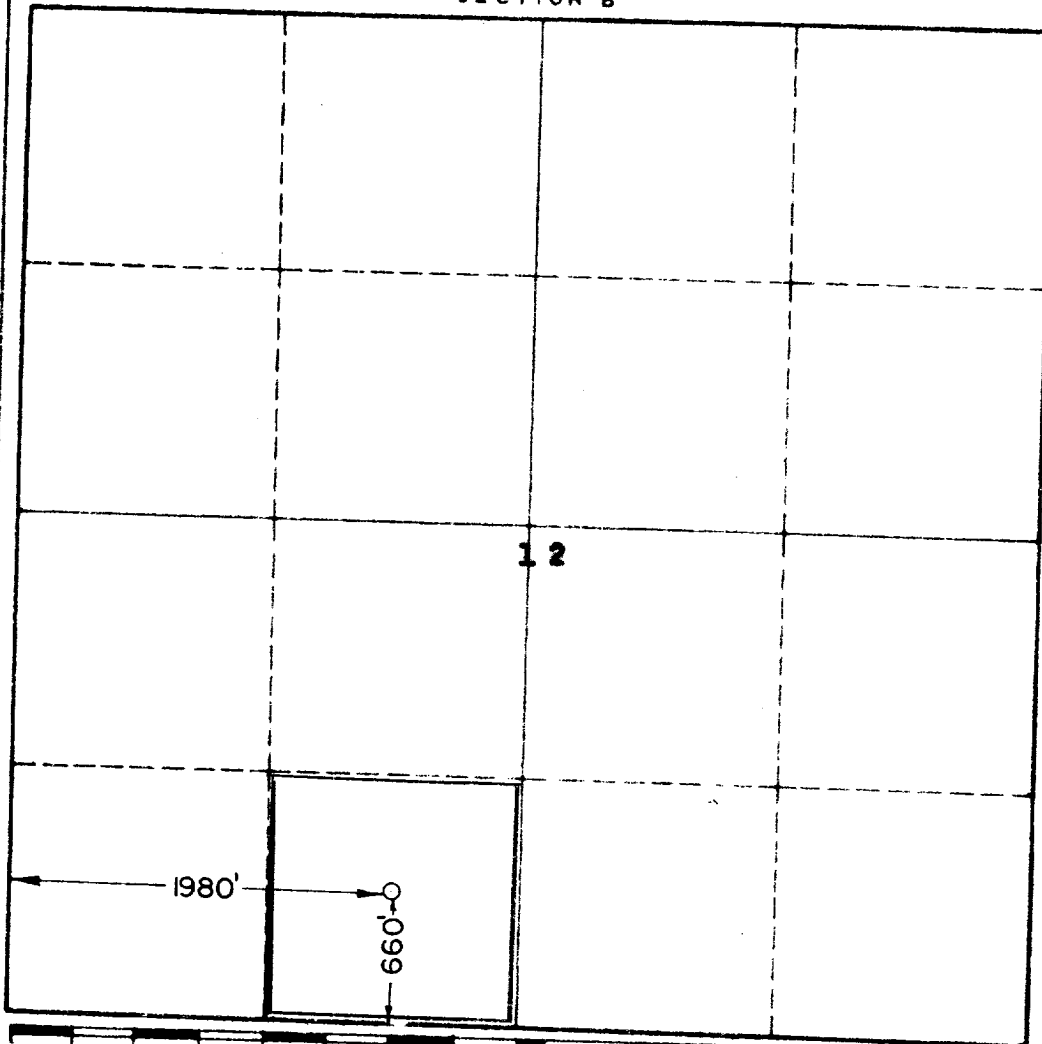

CERTIFICATION

I hereby certify that the information in SECTION A above is true and complete to the best of my knowledge and belief.

Name **R. E. Statton**  
Position **District Engineer**  
Company **Sunray Mid-Continent Oil Co.**  
Date **July 12, 1961**

I hereby certify that the well location shown on the plat in SECTION B was plotted from field notes of actual surveys made by me or under my supervision, and that the same is true and correct to the best of my knowledge and belief.

Date Surveyed **6-30-61**  
Registered Professional Engineer and/or Land Surveyor, **JOHN W. WEST**  
Certificate No. **W.M. - P.E. & L.S. NO. 676**