

NO. OF COPIES RECEIVED	
DISTRIBUTION	
SANTA FE	
FILE	
U.S.G.S.	
LAND OFFICE	
OPERATOR	

NEW MEXICO OIL CONSERVATION COMMISSION

Form C-101
Revised 1-1-65

5A. Indicate Type of Lease	
STATE <input type="checkbox"/>	FEE <input checked="" type="checkbox"/>
5. State Oil & Gas Lease No.	

APPLICATION FOR PERMIT TO DRILL, DEEPEN, OR PLUG BACK

1a. Type of Work		7. Unit Agreement Name	
b. Type of Well DRILL <input checked="" type="checkbox"/> Re-enter DEEPEN <input type="checkbox"/> PLUG BACK <input type="checkbox"/> OIL WELL <input type="checkbox"/> GAS WELL <input checked="" type="checkbox"/> OTHER <input type="checkbox"/> SINGLE ZONE <input checked="" type="checkbox"/> MULTIPLE ZONE <input type="checkbox"/>		8. Farm or Lease Name Phyllis Williams	
2. Name of Operator George H. Williams		9. Well No. 1	
3. Address of Operator c/o Oil Reports & Gas Services, Inc., Box 763, Hobbs, New Mexico 88240		10. Field and Pool, or Wildcat Caprock Queen	
4. Location of Well UNIT LETTER J LOCATED 2310 FEET FROM THE South LINE AND 1650 FEET FROM THE East LINE OF SEC. 3 TWP. 13 S RGE. 31 E NMPM		12. County Chaves	
19. Proposed Depth 3025		19A. Formation Queen	
20. Rotary or C.T. Cable		21. Elevations (Show whether DF, RT, etc.)	
21A. Kind & Status Plug. Bond Blanket		21B. Drilling Contractor C. O. Fulton	
22. Approx. Date Work will start 10/20/75		23.	

PROPOSED CASING AND CEMENT PROGRAM

SIZE OF HOLE	SIZE OF CASING	WEIGHT PER FOOT	SETTING DEPTH	SACKS OF CEMENT	EST. TOP
11	8 5/8	NA	239	100	
7 7/8	5 1/2	NA	2932	600	

Formerly Geo. P. Livermore, Inc., Williams #1, TD 3025, plugged 5/28/45.

To re-enter, locate top of 5 1/2" casing, run 5 1/2" casing & tie in, clean out to old total depth, treat and test.

Filed to re-instate Form C-101 cancelled 2/13/76.

IN ABOVE SPACE DESCRIBE PROPOSED PROGRAM: IF PROPOSAL IS TO DEEPEN OR PLUG BACK, GIVE DATA ON PRESENT PRODUCTIVE ZONE AND PROPOSED NEW PRODUCTIVE ZONE. GIVE BLOWOUT PREVENTER PROGRAM, IF ANY.

I hereby certify that the information above is true and complete to the best of my knowledge and belief.

Signed William Fulton Title Agent Date 4/20/76

(This space for State Use)

APPROVED BY [Signature] TITLE SEAL DATE 4/20/76

CONDITIONS OF APPROVAL, IF ANY:

RECEIVED

APR 20 1968
DE CONSERVATION COMM.
HOBBS N M

NEW MEXICO OIL CONSERVATION COMMISSION
WELL LOCATION AND ACREAGE DEDICATION FORM

Form C-102
 Supersedes C-128
 Effective 1-1-65

All distances must be from the outer boundaries of the Section.

Operator George H. Williams		Lease Phyllis Williams		Well No. 1
Unit Letter J	Section 3	Township 13 S	Range 31 E	County Chaves
Actual Postage Location of Well: 2310 feet from the South line and 1650 feet from the East line				
Ground Level Elev.	Producing Formation Queen	Pool Wildcat Caprock Queen	Dedicated Acreage: 160 40 Acres	

1. Outline the acreage dedicated to the subject well by colored pencil or hachure marks on the plat below.
2. If more than one lease is dedicated to the well, outline each and identify the ownership thereof (both as to working interest and royalty).
3. If more than one lease of different ownership is dedicated to the well, have the interests of all owners been consolidated by communitization, unitization, force-pooling, etc?

☐ Yes ☐ No If answer is "yes," type of consolidation _____

If answer is "no," list the owners and tract descriptions which have actually been consolidated. (Use reverse side of this form if necessary.) _____

No allowable will be assigned to the well until all interests have been consolidated (by communitization, unitization, forced-pooling, or otherwise) or until a non-standard unit, eliminating such interests, has been approved by the Commission.

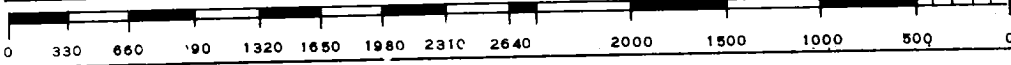
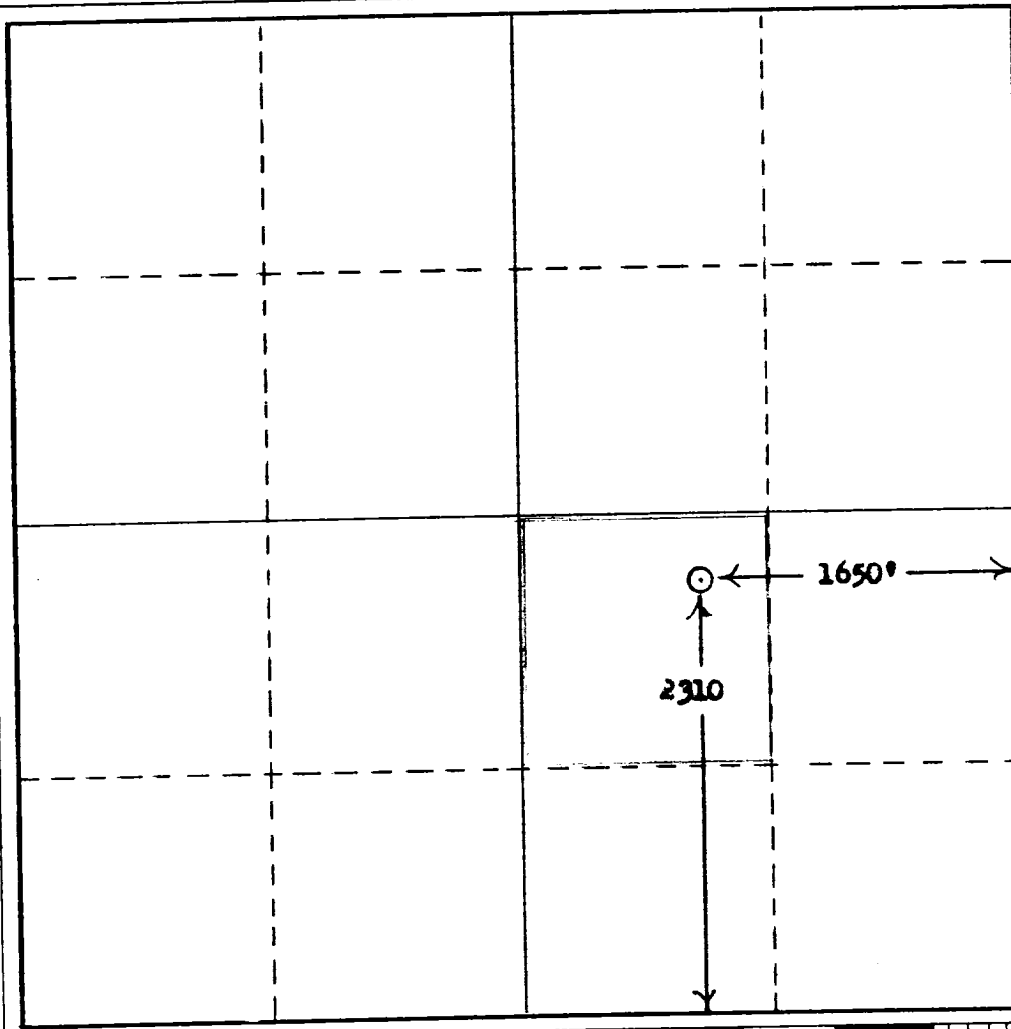

CERTIFICATION

I hereby certify that the information contained herein is true and complete to the best of my knowledge and belief.

George H. Williams
 Name

Agent
 Position

George H. Williams
 Company

10/15/75
 Date

Date

I hereby certify that the well location shown on this plat was plotted from field notes of actual surveys made by me or under my supervision, and that the same is true and correct to the best of my knowledge and belief.

Date Surveyed

Registered Professional Engineer
 and/or Land Surveyor

Certificate No.

RECEIVED

APR 22 1976

OIL CONSERVATION COMM.
HOBBS N. M.