

(FIVE COPIES SUBMITTED)

Budget Bureau No. 42-R358.1.  
Approval expires 11-30-49.

(SUBMIT IN TRIPLICATE)

Land Office Las Cruces, N.M.  
(New) Santa Fe, N.M.  
Lease No. 10000  
Unit 1

UNITED STATES  
DEPARTMENT OF THE INTERIOR  
GEOLOGICAL SURVEY

SUNDRY NOTICES AND REPORTS ON WELLS

NOTICE OF INTENTION TO DRILL.....	<input checked="" type="checkbox"/>	SUBSEQUENT REPORT OF WATER SHUT-OFF.....	
NOTICE OF INTENTION TO CHANGE PLANS.....		SUBSEQUENT REPORT OF SHOOTING OR ACIDIZING.....	
NOTICE OF INTENTION TO TEST WATER SHUT-OFF.....		SUBSEQUENT REPORT OF ALTERING CASING.....	
NOTICE OF INTENTION TO RE-DRILL OR REPAIR WELL.....		SUBSEQUENT REPORT OF REDRILLING OR REPAIR.....	
NOTICE OF INTENTION TO SHOOT OR ACIDIZE.....		SUBSEQUENT REPORT OF ABANDONMENT.....	
NOTICE OF INTENTION TO PULL OR ALTER CASING.....		SUPPLEMENTARY WELL HISTORY.....	
NOTICE OF INTENTION TO ABANDON WELL.....			

(INDICATE ABOVE BY CHECK MARK NATURE OF REPORT, NOTICE, OR OTHER DATA)

WEALY COMPANY, INC.  
FEDERAL "A" LEASE

Fort Worth 2, Texas

January 27, 1955

Well No. 1 is located 660 ft. from [N] line and 660 ft. from [E] line of sec. 15

All Section 15  
(1/4 Sec. and Sec. No.)

13-0  
(Twp.)

11-N  
(Range)

N.M.P.M.  
(Meridian)

Brickley Queen  
(Field)

Clarks  
(County or Subdivision)

New Mexico  
(State or Territory)

The elevation of the derrick floor above sea level is ..... ft. Ground Elevation: 4425'

DETAILS OF WORK

(State names of and expected depths to objective sands; show sizes, weights, and lengths of proposed casings; indicate mudding jobs, cementing points, and all other important proposed work)

Will drill with combination rotary and cable tools, drilling to approximately 1,430' and set 8-5/8" CB, 2 1/2", 2-40 seamless casing and cement with 200 sacks; balance of hole will be drilled with cable tools and approximately 300' of 7" O.D. 2-75 seamless casing set immediately above expected producing zone and cemented with 200 sacks cement, complete drilling with cable tools and cements if necessary and place on pump, using 2-5/8" O.D. external upset seamless tubing. Pumping unit will use electric motor for power.

I understand that this plan of work must receive approval in writing by the Geological Survey before operations may be commenced.

Company WEALY COMPANY, INC.

1301-1 Continental Life Building

Address FORT WORTH 2, TEXAS

NOTE: Contractor-Cactus Drilling Company  
P. O. Box 348, San Angelo, Texas  
New Mexico: George Baker  
Telephone: 3-7471-Albuquerque, New Mexico

WEALY COMPANY, INC.

By William D. Morris  
William D. Morris

Title President.

# WELL LOCATION SURVEY PLAT

OPERATOR WHALEY COMPANY, INC.

LEASE FEDERAL "A" L.C. 069184 , 1,080 Acres

WELL NO. 1

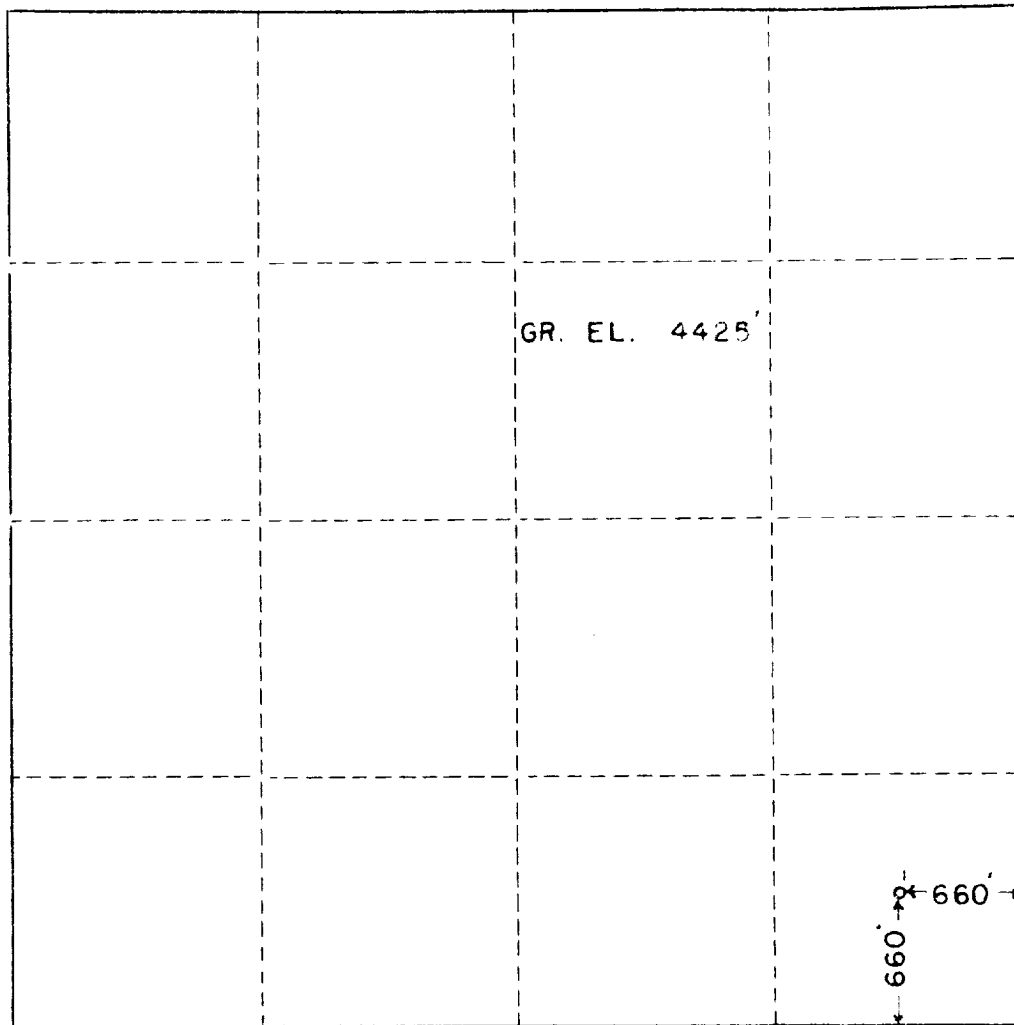

SEC. 15 , TWP. 13 S., RGE. 31 E., N.M.P.M.

I HEREBY CERTIFY THAT THIS PLAT WAS MADE  
FROM NOTES TAKEN IN THE FIELD BY ME AND  
THAT THE SAME IS TRUE AND CORRECT TO THE  
BEST OF MY KNOWLEDGE AND BELIEF.

*John W West*

JOHN W. WEST, PE & LS NO. 676

1-19-55