

NEW MEXICO OIL CONSERVATION COMMISSION

Santa Fe, New Mexico HOBBS OFFICE OCC



NOTICE OF INTENTION TO DRILL OR RECOMPLETE

Notice must be given to the District Office of the Oil Conservation Commission and approval obtained before drilling or recompletion begins. If changes in the proposed plan are considered advisable, a copy of this notice showing such changes will be returned to the sender. Submit this notice in **QUINTUPLICATE**. One copy will be returned following approval. See additional instructions in Rules and Regulations of the Commission. If State Land submit **6 Copies**

**Midland, Texas**

(Place)

**9/10/56**

(Date)

OIL CONSERVATION COMMISSION  
SANTA FE, NEW MEXICO

Gentlemen:

You are hereby notified that it is our intention to commence the (Drilling) (Recompletion) of a well to be known as

**Salsich, McGrath and Smith**

(Company or Operator)

**Chaves State "A"**

(Lease)

Well No. **2**

**J**

(Unit)

The well is

located **2310** feet from the **East** line and **1650** feet from the

**South**

line of Section **24**

**T. 13S**

**R. 31E**

**NMPM.**

(GIVE LOCATION FROM SECTION LINE)

**Caprock**

Pool,

**Chaves**

County

If State Land the Oil and Gas Lease is No. **E 5663**

If patented land the owner is

Address

We propose to drill well with drilling equipment as follows: **0 - TD Rotary**

The status of plugging bond is **Mims & Stevens, date 2/1/55**

**blanket bond under form 39-A1**

Drilling Contractor **Jennings Drilling Company, Hobbs, New Mexico**

We intend to complete this well in the **Queen sand**

formation at an approximate depth of **3050** feet.

**CASING PROGRAM**

We propose to use the following strings of Casing and to cement them as indicated:

Size of Hole	Size of Casing	Weight per Foot	New or Second Hand	Depth	Sacks Cement
<b>11</b>	<b>8-5/8</b>	<b>24#</b>	<b>Used</b>	<b>150</b>	<b>Circulated to surface 150 sbs</b>
<b>7-7/8</b>	<b>5-1/2</b>	<b>14#</b>	<b>Used</b>	<b>3040</b>	

If changes in the above plans become advisable we will notify you immediately.

ADDITIONAL INFORMATION (If recompletion give full details of proposed plan of work.)

Approved....., 19.....  
Except as follows:

OIL CONSERVATION COMMISSION

By **R. F. Montgomery**

Sincerely yours,

**Salsich, McGrath and Smith**

(Company or Operator)

By

**Pomeroy Smith**

Position

**Partner**

Name

**Salsich, McGrath & Smith, Box 2777,**

Address

**Midland, Texas**



NEW MEXICO  
OIL CONSERVATION COMMISSION

Form C-128

Well Location and/or Gas Proration Plat

HOBBS OFFICE Oct 9-21-1956

Operator SALSICH - McGRATH AND SMITH Lease CHAVES STATE "A"

1956 OCT 11 PM 2:47

Well No. 2 Section 24 Township 13 Range 31 NMPM

Located 2310 Feet From EAST Line, 1650 Feet From SOUTH Line,

CHAVES County, New Mexico. G. L. Elevation 4397.4

Name of Producing Formation Queen Sand Pool Caprock Dedicated Acreage 40

(Note: All distances must be from outer boundaries of Section)

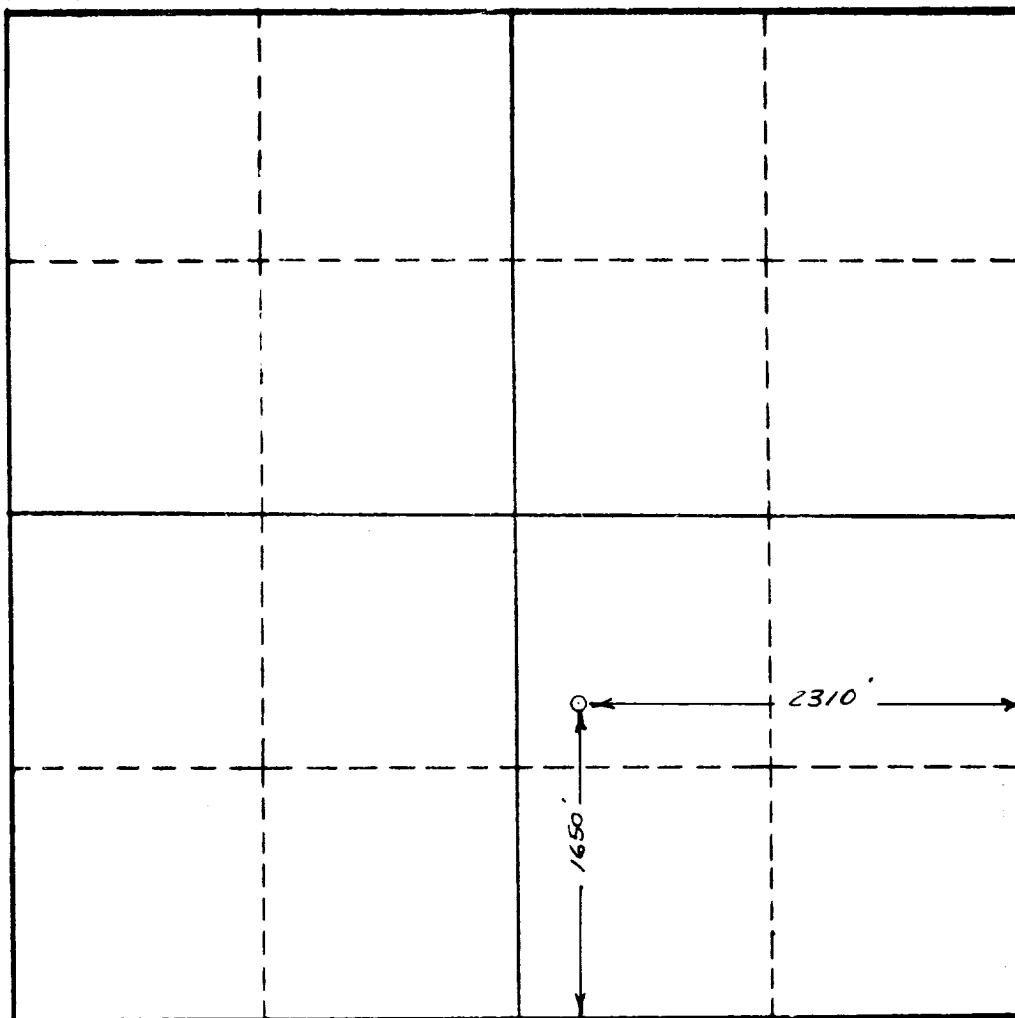

SCALE: 1" = 1000'

1. Is this Well a Dual Comp.? Yes No X
2. If the answer to Question 1 is yes, are there any other dually completed wells within the dedicated acreage? Yes No

This is to certify that the above plat was prepared from field notes of actual surveys made by me or under my supervision and that the same are true and correct to the best of my knowledge and belief.

Name Pomeroy Smith  
Position Partner  
Representing Salsich, McGrath and Smith  
Address Box 2777, Midland, Texas

Date Surveyed 9-21-1956  
John W. West  
Registered Professional Engineer and/or  
Land Surveyor

