

NEW MEXICO OIL CONSERVATION COMMISSION

Form C-128
Revised 5/1/57

Well Location and Acreage Dedication Plat

Section A.

Date October 8, 1957

Operator A. C. Holder and W. G. Ross Lease Phillips Cleat, Federal Lease NM 03210
Well No. 2 Unit Letter L Section 17 Township 14 South Range 81 East NMPM
Located 990 Feet From West Line, 2310 Feet From Section Office Line
County Chaves G. L. Elevation 4089.3 Dedicated Acreage 20 Acres
Name of Producing Formation Queen Pool Castroville Queen

1. Is the Operator the only owner* in the dedicated acreage outlined on the plat below?
Yes _____ No X
2. If the answer to question one is "no," have the interests of all the owners been consolidated by communitization agreement or otherwise? Yes X No _____. If answer is "yes," Type of Consolidation Operating Agreement
3. If the answer to question two is "no," list all the owners and their respective interests below:

Owner

Land Description

RECEIVED

OCT 9 1957

U. S. GEOLOGICAL SURVEY
ARTESIA, NEW MEXICO

Section B

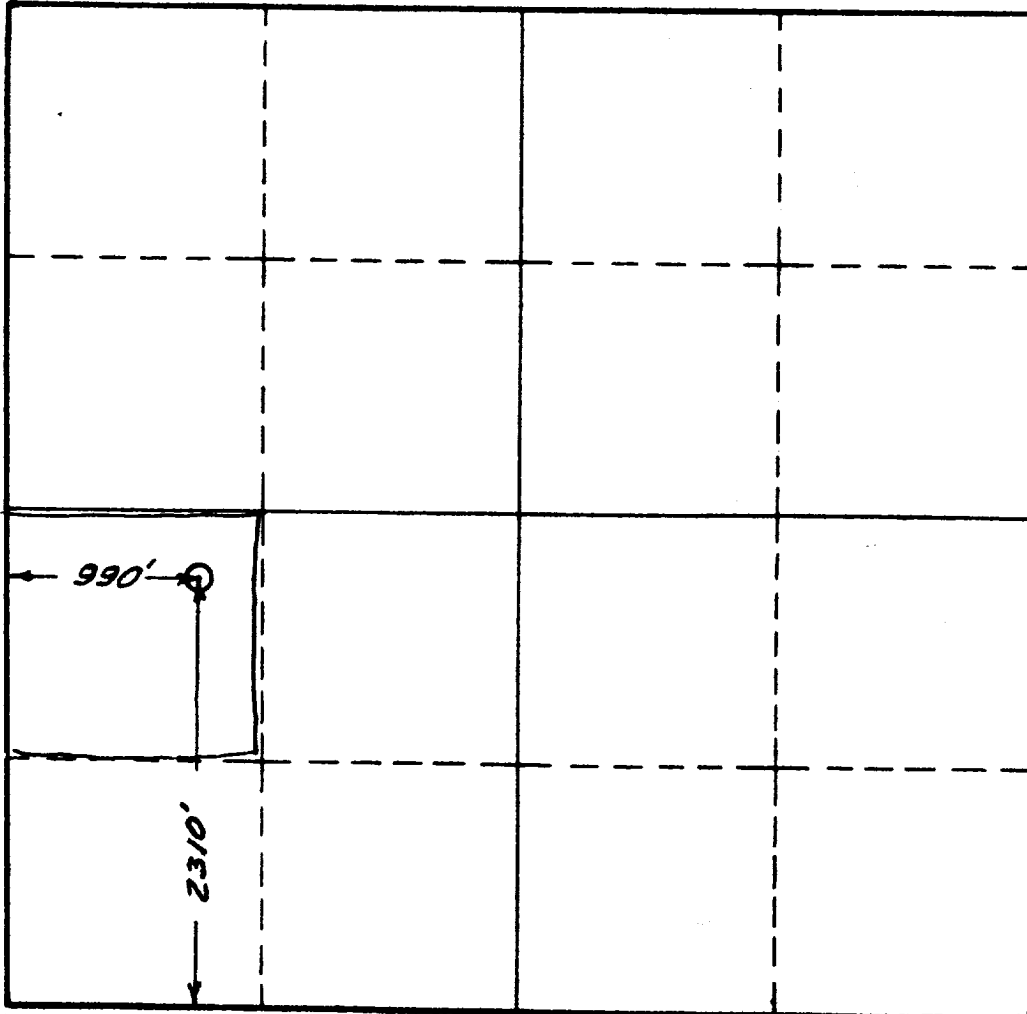

This is to certify that the information in Section A above is true and complete to the best of my knowledge and belief.

A. C. Holder and W. G. Ross
(Operator)

(Representative)

Box 90, Lovington, New Mexico
Address

This is to certify that the well location shown on the plat in Section B was plotted from field notes of actual surveys made by me or under my supervision and that the same is true and correct to the best of my knowledge and belief.

Date Surveyed Oct. 7, 1957

James J. Bullock
Registered Professional
Engineer and/or Land Surveyor.

Certificate No. 726

(See instructions for completing this form on the reverse side)