

(SUBMIT IN TRIPLICATE)

UNITED STATES  
DEPARTMENT OF THE INTERIOR  
GEOLOGICAL SURVEY

Land Office \_\_\_\_\_  
Lease No. **LC-060821-A**  
Unit \_\_\_\_\_

**SUNDRY NOTICES AND REPORTS ON WELLS**

NOTICE OF INTENTION TO DRILL	SUBSEQUENT REPORT OF WATER SHUT-OFF
NOTICE OF INTENTION TO CHANGE PLANS	SUBSEQUENT REPORT OF SHOOTING OR ACIDIZING
NOTICE OF INTENTION TO TEST WATER SHUT-OFF	SUBSEQUENT REPORT OF ALTERING CASING
NOTICE OF INTENTION TO RE-DRILL OR REPAIR WELL	SUBSEQUENT REPORT OF RE-DRILLING OR REPAIR
NOTICE OF INTENTION TO SHOOT OR ACIDIZE	SUBSEQUENT REPORT OF ABANDONMENT
NOTICE OF INTENTION TO PULL OR ALTER CASING	SUPPLEMENTARY WELL HISTORY
NOTICE OF INTENTION TO ABANDON WELL	

(INDICATE ABOVE BY CHECK MARK NATURE OF REPORT, NOTICE, OR OTHER DATA)

**June 4**, 19**56**

Well No. **2** is located **1980** ft. from **S** line and **2310** ft. from **E** line of sec. **21**  
**NE 1/4** of **SE 1/4** sec. **21** **143** **11E** (Meridian)  
 (1/4 Sec. and Sec. No.) (Twp.) (Range)  
**Caprock Queen** **Chaves** **New Mexico**  
 (Field) (County or Subdivision) (State or Territory)

The elevation of the derrick floor above sea level is \_\_\_\_\_ ft.

**DETAILS OF WORK**

(State names of and expected depths to objective sands; show sizes, weights, and lengths of proposed casings; indicate mudding jobs, cementing points, and all other important proposed work)

**Formation: Queen Sand**

**Total Depth: 2900'**

**Casing Program: 10 3/4", 32', 150', circulate cement, 15" hole**  
**7" 20', 2750', 150 sacks cement, 8 3/4" hole**

I understand that this plan of work must receive approval in writing by the Geological Survey before operations may be commenced.

Company **Ma ville G. Penrose, Inc.**  
 Address **Box 984**  
**Albuquerque, New Mexico**  
 By **Glenn G. Neill**  
**Agent**

NEW MEXICO OIL CONSERVATION COMMISSION  
Well Location and Acreage Dedication Plat

Section A.

Date June 4, 1958

Operator Neville G. Penrose Lease Saner  
Well No. 2 Unit Letter J Section 21 Township 14 S Range 31 E NMPM.  
Located 1980 Feet From South Line, 2310 Feet From East Line  
County Chaves G. L. Elevation \_\_\_\_\_ Dedicated Acreage 40 Acres  
Name of Producing Formation Queen Sand Pool Caprock Queen

1. Is the Operator the only owner\* in the dedicated acreage outlined on the plat below?  
Yes \_\_\_\_\_ No X.
2. If the answer to question one is "no," have the interests of all the owners been consolidated by communitization agreement or otherwise? Yes X No \_\_\_\_\_. If answer is "yes," Type of Consolidation joint venture
3. If the answer to question two is "no," list all the owners and their respective interests below:

Owner

Land Description

Section B

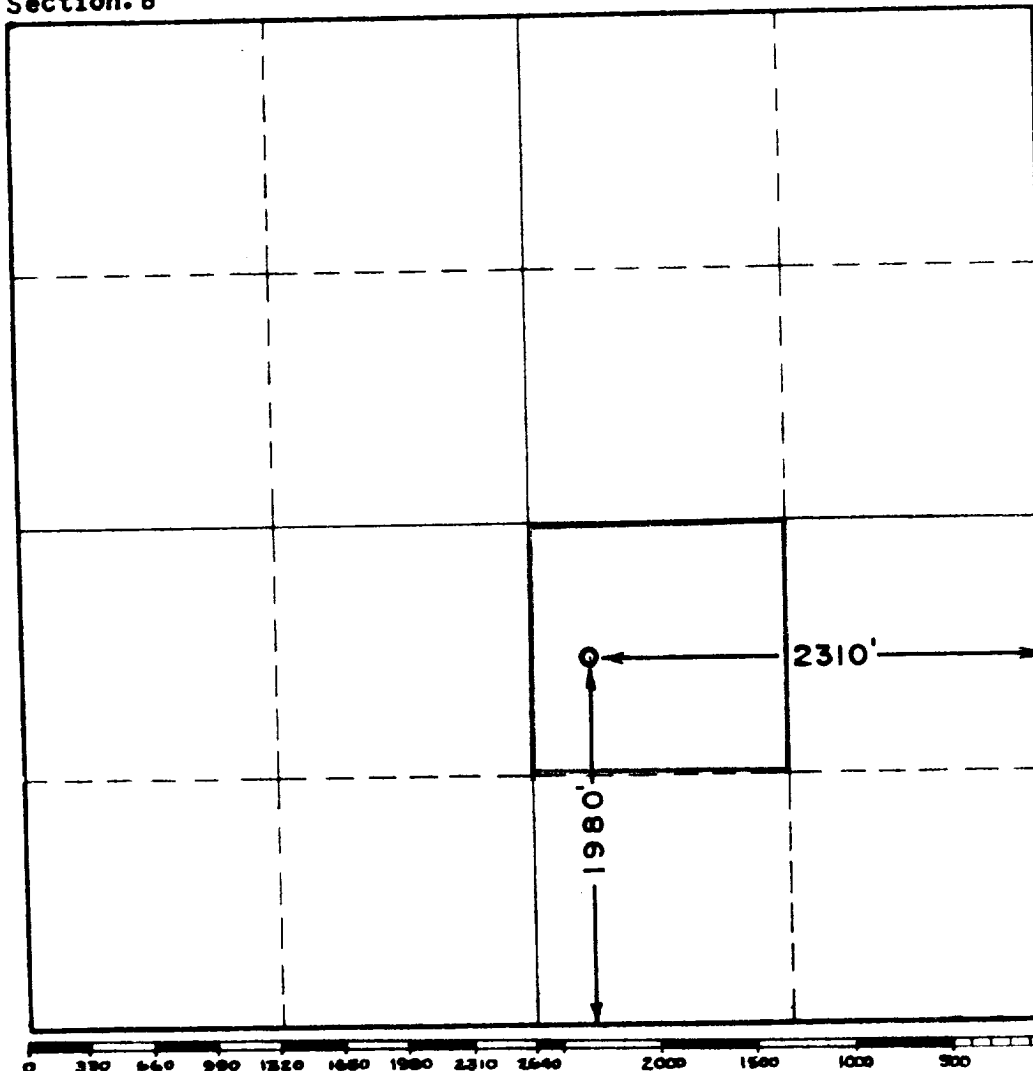

This is to certify that the information in Section A above is true and complete to the best of my knowledge and belief.

Neville G. Penrose, Inc.

(Operator)

Blair E. Nye

(Representative)

Box 988

Eunice, New Mexico

Address

This is to certify that the well location shown on the plat in Section B was plotted from field notes of actual surveys made by me or under my supervision and that the same is true and correct to the best of my knowledge and belief.

Date Surveyed 3-19-58

John W. West  
Registered Professional  
Engineer and/or Land Surveyor.

Certificate No. 676

(See instructions for completing this form on the reverse side)