

Form 9-381a  
(Feb. 1951)

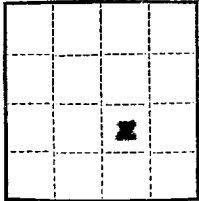

(SUBMIT IN TRIPLICATE)

UNITED STATES  
DEPARTMENT OF THE INTERIOR  
GEOLOGICAL SURVEY

nd Office

Lease No. **LC-060821-1**

Unit

SUNDRY NOTICES AND REPORTS ON WELLS

NOTICE OF INTENTION TO DRILL	<input checked="" type="checkbox"/>	SUBSEQUENT REPORT OF WATER SHUT-OFF
NOTICE OF INTENTION TO CHANGE PLANS		SUBSEQUENT REPORT OF SHOOTING OR ACIDIZING
NOTICE OF INTENTION TO TEST WATER SHUT-OFF		SUBSEQUENT REPORT OF ALTERING CASING
NOTICE OF INTENTION TO RE-DRILL OR REPAIR WELL		SUBSEQUENT REPORT OF RE-DRILLING OR REPAIR
NOTICE OF INTENTION TO SHOOT OR ACIDIZE		SUBSEQUENT REPORT OF ABANDONMENT
NOTICE OF INTENTION TO PULL OR ALTER CASING		SUPPLEMENTARY WELL HISTORY
NOTICE OF INTENTION TO ABANDON WELL		

(INDICATE ABOVE BY CHECK MARK NATURE OF REPORT, NOTICE, OR OTHER DATA)

**June 4**, 19**56**

Well No. **2** is located **1980** ft. from **N** line and **2310** ft. from **E** line of sec. **21**  
 of **324** sec. **31**  
 (1/4 Sec. and Sec. No.) (Twp.) (Range) (Meridian)  
**Caprock** **Chaves** **New Mexico**  
 (Field) (County or Subdivision) (State or Territory)

The elevation of the derrick floor above sea level is \_\_\_\_\_ ft.

DETAILS OF WORK

(State names of and expected depths to objective sands; show sizes, weights, and lengths of proposed casings; indicate mudding jobs, cementing points, and all other important proposed work)

Formation: **Queen Sand**

Total Depth: **2900'**

Casing Program: **10 3/4", 32', 150', circulate cement, 15" hole**  
**7" 20', 2750', 150 sacks cement, 8 3/4" hole**

I understand that this plan of work must receive approval in writing by the Geological Survey before operations may be commenced.

Company **De ville G. Peurson, Inc.**

Address **Box 944**

**Lunice, New Mexico**

By **Glenn C. Peill**  
**Glenn C. Peill**

Title **Agent**



NEW MEXICO OIL CONSERVATION COMMISSION  
Well Location and Acreage Dedication Plat

Section A.

Date June 4, 1958

Operator Neville G. Penrose, Inc. Lease Saner  
 Well No. 2 Unit Letter J Section 21 Township 14S Range 31E NMPM  
 Located 1980 Feet From south Line, 2310 Feet From east Line  
 County Chaves G. L. Elevation \_\_\_\_\_ Dedicated Acreage 40 Acres  
 Name of Producing Formation Queen sand Pool Caprock Queen

1. Is the Operator the only owner\* in the dedicated acreage outlined on the plat below?  
 Yes \_\_\_\_\_ No X.
2. If the answer to question one is "no," have the interests of all the owners been consolidated by communitization agreement or otherwise? Yes X No \_\_\_\_\_. If answer is "yes," Type of Consolidation joint venture
3. If the answer to question two is "no," list all the owners and their respective interests below:

OwnerLand Description

## Section B

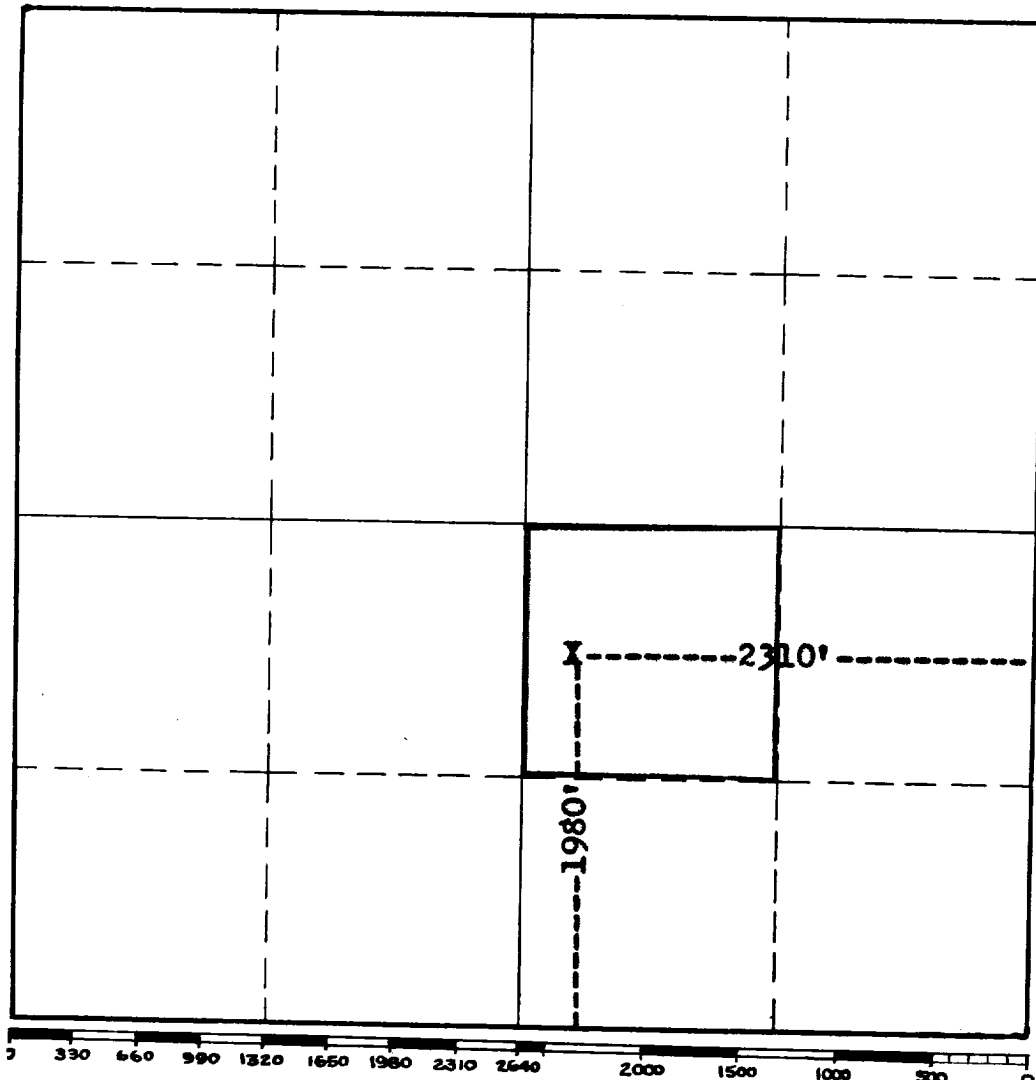

This is to certify that the information in Section A above is true and complete to the best of my knowledge and belief.

Neville G. Penrose, Inc.  
 (Operator)

Elmer E. Spicer  
 (Representative)

Box 988

Eunice, New Mexico  
 Address

This is to certify that the well location shown on the plat in Section B was plotted from field notes of actual surveys made by me or under my supervision and that the same is true and correct to the best of my knowledge and belief.

Date Surveyed 3-19-58

John W. West

Registered Professional  
 Engineer and/or Land Surveyor.

Certificate No. 676

(See instructions for completing this form on the back of the form.)

INSTRUCTIONS FOR COMPLETION:

1. Operator shall furnish and certify to the information called for in Section A.
2. Operator shall outline the dedicated acreage for both oil and gas wells on the plat in Section B.
3. A registered professional engineer or land surveyor registered in the State of New Mexico or approved by the Commission shall show on the plat the location of the well and certify this information in the space provided.
4. All distances shown on the plat must be from the outer boundaries of Section.
5. If additional space is needed for listing owners and their respective interests as required in question 3, Section A, please use space below

\* "Owner" means the person who has the right to drill into and to produce from any pool and to appropriate the production either for himself or for himself and another. (65-3-29 (e) NMSA 1953 Comp.)