

(SUBMIT IN TRIPLICATE)

Land Office

Lease No.

Unit

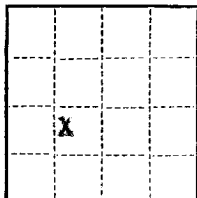

UNITED STATES
DEPARTMENT OF THE INTERIOR
GEOLOGICAL SURVEY

SUNDRY NOTICES AND REPORTS ON WELLS

NOTICE OF INTENTION TO DRILL	<input checked="" type="checkbox"/>	SUBSEQUENT REPORT OF WATER SHUT-OFF	
NOTICE OF INTENTION TO CHANGE PLANS		SUBSEQUENT REPORT OF SHOOTING OR ACIDIZING	
NOTICE OF INTENTION TO TEST WATER SHUT-OFF		SUBSEQUENT REPORT OF ALTERING CASING	
NOTICE OF INTENTION TO RE-DRILL OR REPAIR WELL		SUBSEQUENT REPORT OF RE-DRILLING OR REPAIR	
NOTICE OF INTENTION TO SHOOT OR ACIDIZE		SUBSEQUENT REPORT OF ABANDONMENT	
NOTICE OF INTENTION TO PULL OR ALTER CASING		SUPPLEMENTARY WELL HISTORY	
NOTICE OF INTENTION TO ABANDON WELL			

(INDICATE ABOVE BY CHECK MARK NATURE OF REPORT, NOTICE, OR OTHER DATA)

April 4, 1955

Well No. 1 is located 1980 ft. from N line and 1980 ft. from E line of sec. 22
 SW/4 Section 22 14S 1E 100M 12PM
 (1/4 Sec. and Sec. No.) (Twp.) (Range) (Meridian)
 Bricky Queen Chaves County New Mexico
 (Field) (County or Subdivision) (State or Territory)

The elevation of the derrick floor above sea level is 4433* ft. * This is estimated elevation,
 exact elevation to be furnished at a later date.

DETAILS OF WORK

(State names of and expected depths to objective sands; show sizes, weights, and lengths of proposed casings; indicate mudding jobs, cementing points, and all other important proposed work)

Casing design:
275' - 8 5/8" OD 21# J-55 ST&C Casing, cement w/200 sx cement.

3100' - 5 1/2" OD 14# J-55 ST&C casing, cement w/100 sx cement.

Mud Program:

Drill with water and native mud to approximately 3050'; displace mud with oil emulsion mud or crude oil and drill pay section to approximately 3150' TD.

Estimated depth to the top of important markers:

Hustler, 1404'; Yates, 2320'; Queens, 3100'.

Drilling Plan:

Drill well with rotary to approximately 275' and set 8 5/8" OD casing. Drill with rotary to TD of approximately 3150'. Run radioactivity logs. Set 5 1/2" OD casing at approximately 3100'. In argillite immediately above pay section and cement. Drill out pack off shoe and complete in open hole. Run 2 3/8" OD tubing to 3100' and snub well in. Run rods w/pump and set pumping unit for completion as pumping well.

I understand that this plan of work must receive approval in writing by the Geological Survey before operations may be commenced.

Company Ada Oil Company

Address Box 346, Midland, Texas

By C. L. Fly (C. L. Fly, Jr.)

Title Chief Clerk

WELL LOCATION SURVEY PLAT.

COMPANY ADA OIL COMPANY
LEASE ~~XXXXXXXXXX~~ FEDERAL-MERLIN "A"
WELL NO. ~~XXX~~ 1

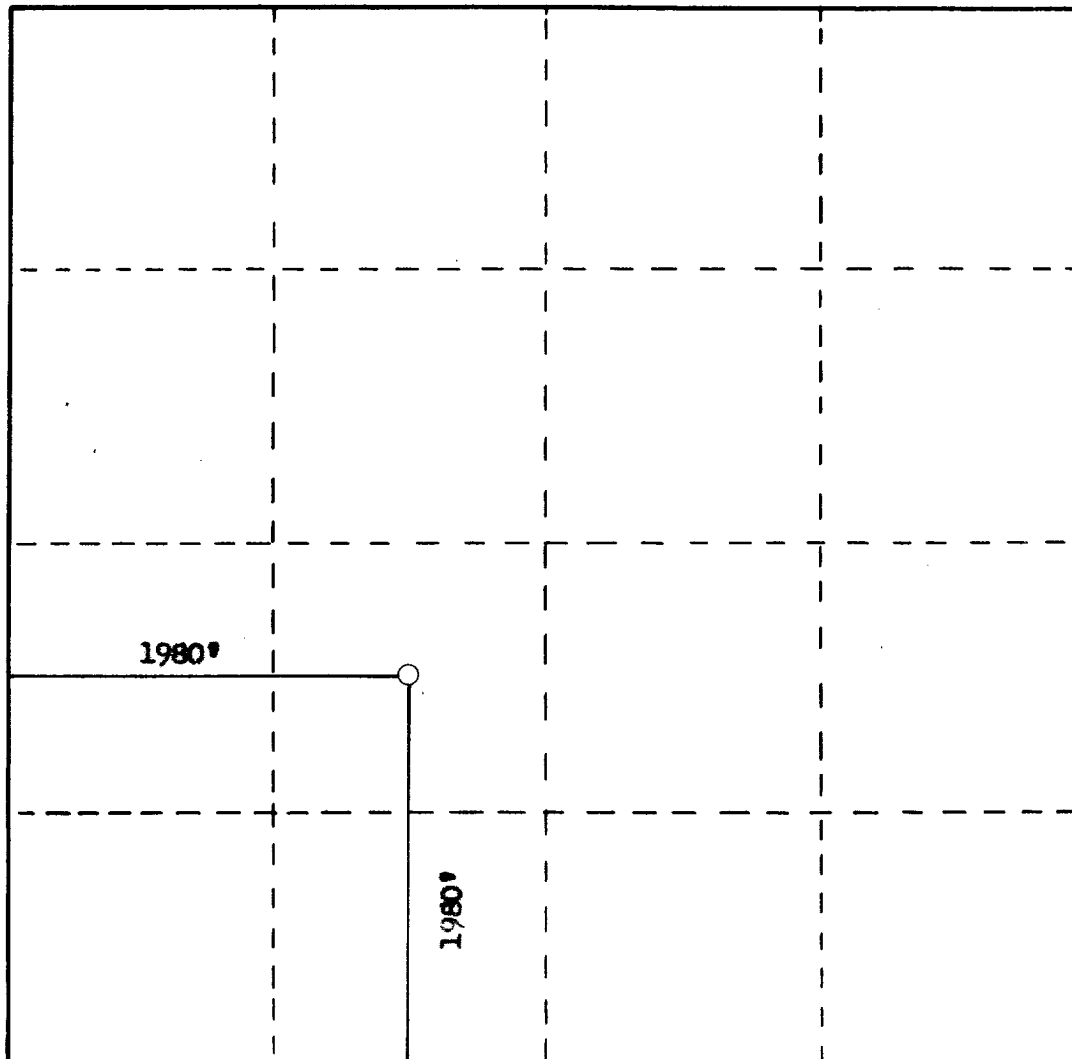

SEC. 22 TWP. 14 S. RGE. 31 E. N.M.P.M.

I CERTIFY THAT THIS SURVEY WAS MADE UNDER
MY DIRECTION, AND THAT THE PLAT IS CORRECT
TO THE BEST OF MY KNOWLEDGE.

George H. Hinckfeld

1528

NEW MEXICO LICENSE NO. _____