

NEW MEXICO OIL CONSERVATION COMMISSION
Santa Fe, New Mexico

HOBBS OFFICE 000

NOTICE OF INTENTION TO DRILL OR RECOMPLETE

Notice must be given to the District Office of the Oil Conservation Commission and approval obtained before drilling or recompletion begins. If changes in the proposed plan are considered advisable, a copy of this notice showing such changes will be returned to the sender. Submit this notice in **QUINTUPPLICATE**. One copy will be returned following approval. See additional instructions in Rules and Regulations of the Commission.

If State Land submit 6 Copies

Artesia, New Mexico
(Place)

Oct. 10, 1956
(Date)

OIL CONSERVATION COMMISSION
SANTA FE, NEW MEXICO

Gentlemen:

You are hereby notified that it is our intention to commence the (Drilling) (Recompletion) of a well to be known as
Donnelly Drilling Company, Inc.
(Company or Operator)

Medlin (Lease), Well No. **1**, in **1** (Unit) The well is located **1960-171** feet from the **South** line and **640** feet from the **West** line of Section **26**, T. **14**, R. **31**, NMPM. (GIVE LOCATION FROM SECTION LINE) **Caprock Queen** Pool, **Chaves** County

| | | | |
|---|---|---|---|
| D | C | B | A |
| E | F | G | H |
| I | K | J | I |
| M | N | O | P |

If State Land the Oil and Gas Lease is No.

If patented land the owner is **M. H. Medlin**

Address **Lovington, New Mexico**

We propose to drill well with drilling equipment as follows: **Rotary**

The status of plugging bond is **Blanket Bond**

Drilling Contractor **Donnelly Drilling Company, Inc.**

We intend to complete this well in the **Queen Sand** formation at an approximate depth of **3120** feet.

CASING PROGRAM

We propose to use the following strings of Casing and to cement them as indicated:

| Size of Hole | Size of Casing | Weight per Foot | New or Second Hand | Depth | Sacks Cement |
|--------------|----------------|-----------------|--------------------|-------------|------------------|
| 11 | 8 5/8 | 24 | New | 300 | Circulate |
| 7 7/8 | 5 1/2 | 14 | New | 3120 | 100 |
| | | | | | |
| | | | | | |

If changes in the above plans become advisable we will notify you immediately.

ADDITIONAL INFORMATION (If recompletion give full details of proposed plan of work.)

Approved....., 19.....
Except as follows:

OIL CONSERVATION COMMISSION
A. M. Rudy
Engineer District 1

Sincerely yours,

Donnelly Drilling Company, Inc.
(Company or Operator)

By **Donnelly**
Position **President**

Send Communications regarding well to

Name **Donnelly Drilling Company, Inc.**

Address **Box 433**
Artesia, New Mexico

NEW MEXICO
OIL CONSERVATION COMMISSION

Form C-128

Well Location and/or Gas Proration Plat

Date October 10th, 1956

Operator Donnelly Drilling Company Lease Medlin State

Well No. 1 Section 26 Township 14S Range 31E NMPM

Located 1980 Feet From South Line, 660 Feet From West Line,

Chaves County, New Mexico. G. L. Elevation 117

Name of Producing Formation _____ Pool _____ Dedicated Acreage _____

(Note: All distances must be from outer boundaries of Section)

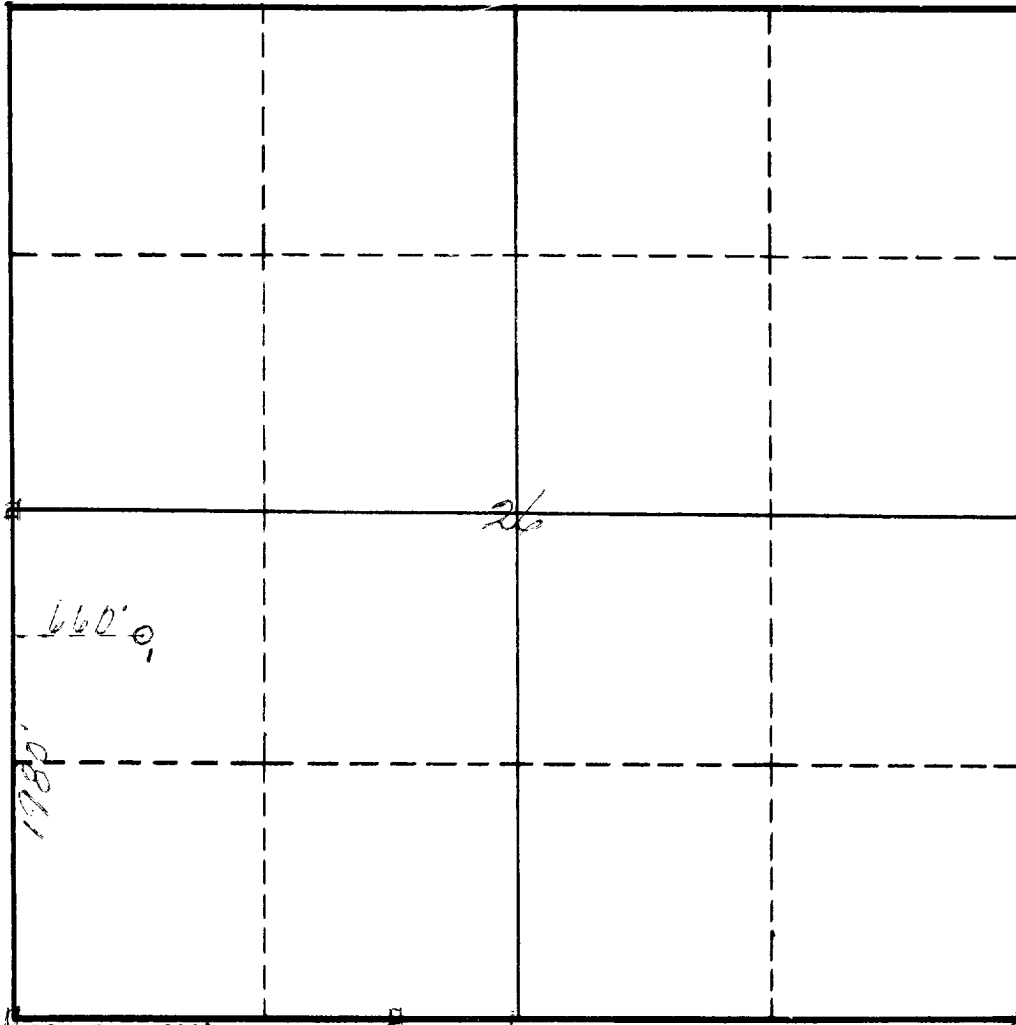

NOTE

This section of form is to be used for gas wells only.



SCALE: 1"=1000'

1. Is this Well a Dual Comp. ? Yes No .
2. If the answer to Question 1 is yes, are there any other dually completed wells within the dedicated acreage? Yes No .

Name _____
Position _____
Representing _____
Address _____

This is to certify that the above plat was prepared from field notes of actual surveys made by me or under my supervision and that the same are true and correct to the best of my knowledge and belief.

Date Surveyed October 10th, 1956
James H. Lamm N.M.S. #542
Registered Professional Engineer and/or
Land Surveyor