

DUPLICATE

NEW MEXICO OIL CONSERVATION COMMISSION

Santa Fe, New Mexico

NOTICE OF INTENTION TO DRILL OR RECOMPLETE

Notice must be given to the District Office of the Oil Conservation Commission and approval obtained before drilling or recompletion begins. If changes in the proposed plan are considered advisable, a copy of this notice showing such changes will be returned to the sender. Submit this notice in **QUINTUPPLICATE**. One copy will be returned following approval. See additional instructions in Rules and Regulations of the Commission.

If State Land submit 6 Copies

Artesia, New Mexico

(Place)

January 17, 1957

(Date)

OIL CONSERVATION COMMISSION
SANTA FE, NEW MEXICO

Gentlemen:

You are hereby notified that it is our intention to commence the (Drilling) (~~Recompletion~~) of a well to be known as

Crest Oil Company

(Company or Operator)

Gulf State

(Lease)

, Well No. 3

G

(Unit)

The well is

located 1980

feet from the

North

line and

1980

feet from the

East

line of Section 27

T. 14S

R. 31E

NMPM.

(GIVE LOCATION FROM SECTION LINE)

Caprock Queen

Pool,

Chaves

County

If State Land the Oil and Gas Lease is No. B-8459

If patented land the owner is

Address

We propose to drill well with drilling equipment as follows: Rotary Drilling Rig

The status of plugging bond is One well bond

Drilling Contractor Donnelly Drilling Company

Box 433

Artesia, New Mexico

We intend to complete this well in the Queen Sand

formation at an approximate depth of 3120 feet.

CASING PROGRAM

We propose to use the following strings of Casing and to cement them as indicated:

Size of Hole	Size of Casing	Weight per Foot	New or Second Hand	Depth	Sacks Cement
12-1/4	8-5/8	24 lb.	New	300'	Circulate
7-7/8	5-1/2	14 lb.	New	3120'	100 Sacks

If changes in the above plans become advisable we will notify you immediately.

ADDITIONAL INFORMATION (If recompletion give full details of proposed plan of work.)

FEB 5 1957

Approved _____, 19____
Except as follows:

OIL CONSERVATION COMMISSION

By E. J. Fischer

Title Engineer District III

Sincerely yours,

Crest Oil Company

(Company or Operator)

By W. W. Byers

Position W. W. Byers - Agent

Send Communications regarding well to

Name Crest Oil Company

Address P. O. Box 638

Artesia, New Mexico

NEW MEXICO
OIL CONSERVATION COMMISSION

Form C-128

Well Location and/or Gas Proration Plat

Operator Crest Oil Company HOBBS OFFICE OCC Date January 17th 1957
1957 Lease 10-7-18
Well No. 3 Section 27 Township 19S Range 31E NMPM
Located 1980 Feet From North Line, 1980 Feet From East Line,
Chaves County, New Mexico. G. L. Elevation _____
Name of Producing Formation _____ Pool _____ Dedicated Acreage _____

(Note: All distances must be from outer boundaries of Section)

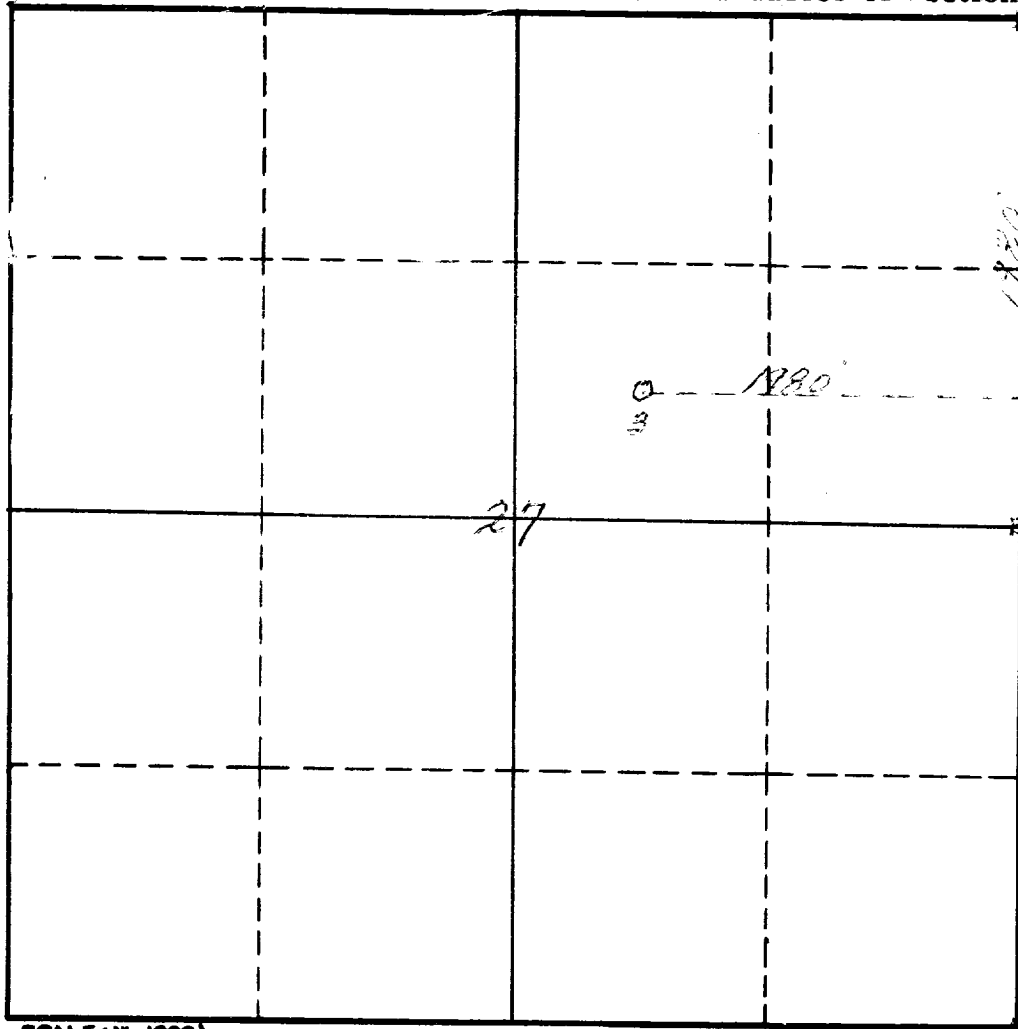

NOTE

This section of
form is to be
used for gas
wells only.



SCALE: 1" = 1000'

1. Is this Well a Dual Comp. ? Yes ___ No ___.
2. If the answer to Question 1 is yes, are there any other dually completed wells within the dedicated acreage? Yes ___ No ___.

This is to certify that the above plat was prepared from field notes of actual surveys made by me or under my supervision and that the same are true and correct to the best of my knowledge and belief.

Name _____
Position _____
Representing _____
Address _____

Date Surveyed January 17th 1957
James H. Brown NMPS #542
Registered Professional Engineer and/or
Land Surveyor