

NEW MEXICO OIL CONSERVATION COMMISSION
Santa Fe, New Mexico

NOTICE OF INTENTION TO DRILL OR RECOMPLETE

Notice must be given to the District Office of the Oil Conservation Commission and approval obtained before drilling or recompletion begins. If changes in the proposed plan are considered advisable, a copy of this notice showing such changes will be returned to the sender. Submit this notice in **QUINTUPPLICATE**. One copy will be returned following approval. See additional instructions in Rules and Regulations of the Commission. **If State Land submit 6 Copies**

Hobbs, New Mexico

(Place)

February 15, 1956

(Date)

OIL CONSERVATION COMMISSION
SANTA FE, NEW MEXICO

Gentlemen:

You are hereby notified that it is our intention to commence the (Drilling) (Recompletion) of a well to be known as

Gulf Oil Corporation

(Company or Operator)

Chaves State "BK" C

(Lease)

Well No. **4**

in **F**

(Unit)

The well is

located **1980** feet from the **North** line and **1980** feet from the

West

line of Section **34**

T14-S

R. **31-E**

NMPM.

(GIVE LOCATION FROM SECTION LINE)

Caprock-Queen

Pool, **Chaves**

County

If State Land the Oil and Gas Lease is No. **E-7662**

If patented land the owner is

Address

We propose to drill well with drilling equipment as follows: **Rotary**

The status of plugging bond is

Drilling Contractor **P. W. Miller Drilling and Production Company**
Box 1872, Midland, Texas

We intend to complete this well in the **Queen**

formation at an approximate depth of **3130**

feet.

CASING PROGRAM

We propose to use the following strings of Casing and to cement them as indicated:

Size of Hole	Size of Casing	Weight per Foot	New or Second Hand	Depth	Sacks Cement
11"	8-5/8"	24#	New	250'	200
7-7/8"	4-1/2"	9.50#	New	3100'	600

If changes in the above plans become advisable we will notify you immediately.

ADDITIONAL INFORMATION (If recompletion give full details of proposed plan of work.)

Approved....., 19.....
Except as follows:

OIL CONSERVATION COMMISSION

By.....

Sincerely yours,

Gulf Oil Corporation

(Company or Operator)

By.....

Position..... **Area Supt. of Prod.**
Send Communications regarding well to

Name..... **Gulf Oil Corporation**

Address..... **Box 2167, Hobbs, New Mexico**

NEW MEXICO
OIL CONSERVATION COMMISSION

Form C-128

Well Location and/or Gas Proration Plat

Date 2-13-56

Operator Gulf Lease Chaves State M&M "C"

Well No. 4 Section 34 Township 11-S Range 31-E NMPM

Located 1980 Feet From North Line, 1980 Feet From West Line,

Chaves County, New Mexico. G. L. Elevation _____

Name of Producing Formation _____ Pool _____ Dedicated Acreage _____

(Note: All distances must be from outer boundaries of Section)

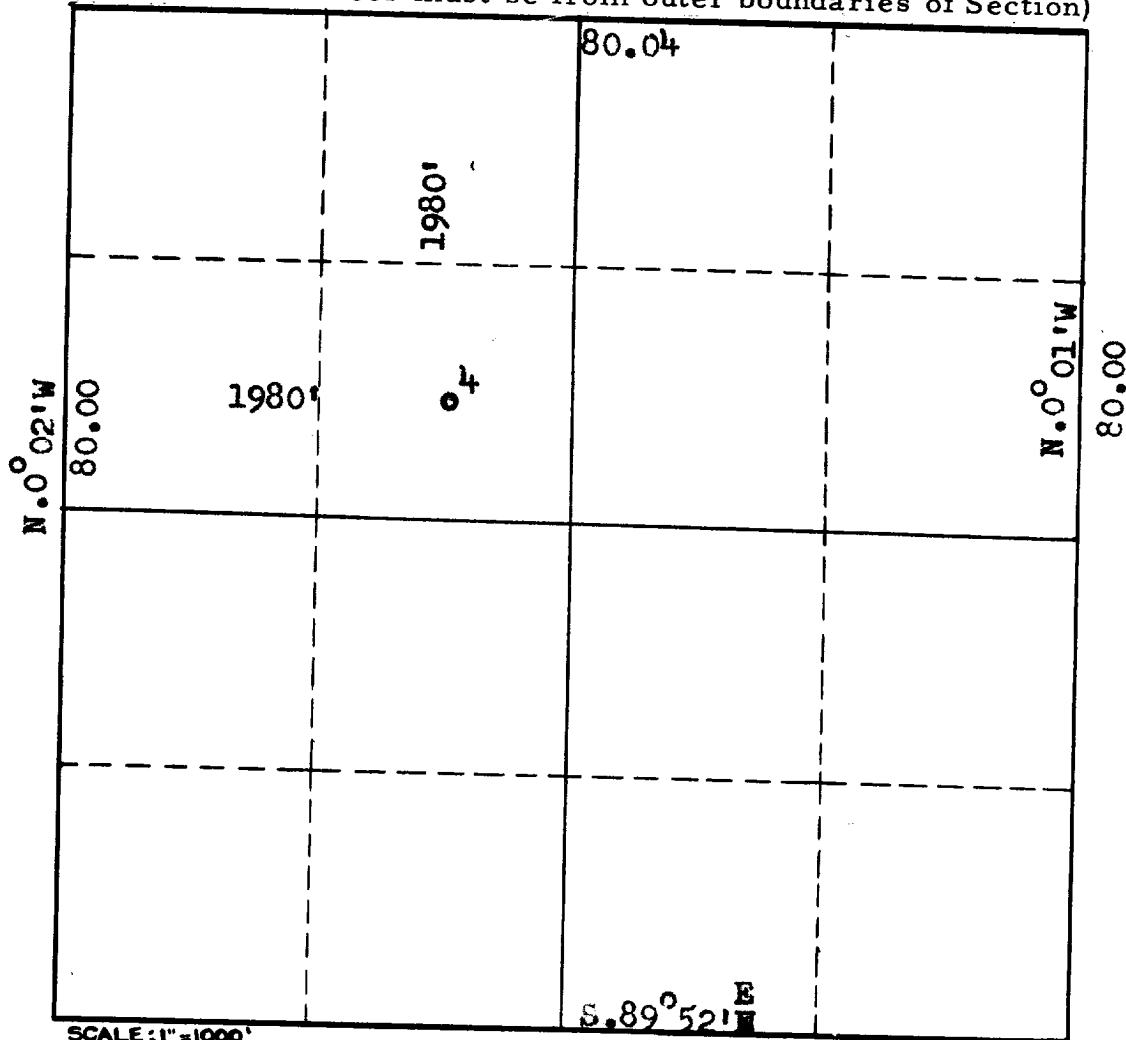

1. Is this Well a Dual Comp. ? Yes ___ No X.
2. If the answer to Question 1 is yes, are there any other dually completed wells within the dedicated acreage? Yes ___ No ___.

This is to certify that the above plat was prepared from field notes of actual surveys made by me or under my supervision and that the same are true and correct to the best of my knowledge and belief.

Name _____
Position _____
Representing _____
Address _____

Date Surveyed 2-10-56
Registered Professional Engineer and/or
Land Surveyor [Signature]