

NEW MEXICO OIL CONSERVATION COMMISSION
WELL LOCATION AND ACREAGE DEDICATION PLAT

HOBBS OFFICE
Form C-120
Revised 5/1/57
APR 24 10 32 AM '64

SEE INSTRUCTIONS FOR COMPLETING THIS FORM ON THE REVERSE SIDE

SECTION A

Operator CABOT CORPORATION		Lease TIDEWATER STATE		Well No. 1
Unit Letter H	Section 31	Township 8 SOUTH	Range 33 EAST	County CHAVES
Actual Footage Location of Well: 1980 feet from the NORTH line and 660 feet from the EAST line				
Ground Level Elev. 4384.7'	Producing Formation Pennsylvanian	Pool Wildcat	Dedicated Acreage: 40 Acres	

1. Is the Operator the only owner in the dedicated acreage outlined on the plat below? YES ☒ NO ____ ("Owner" means the person who has the right to drill into and to produce from any pool and to appropriate the production either for himself or for himself and another. (65-3-29 (a) NMSA 1935 Comp.)
2. If the answer to question one is "no," have the interests of all the owners been consolidated by communitization agreement or otherwise? YES ____ NO ____ . If answer is "yes," Type of Consolidation ____
3. If the answer to question two is "no," list all the owners and their respective interests below:

Owner Cabot Corporation	Land Description SE/4 of NE/4 of Section 31, T-8-S,
P. O. Box 4395, Midland, Texas	R-23-E, Chaves County, New Mexico

SECTION B

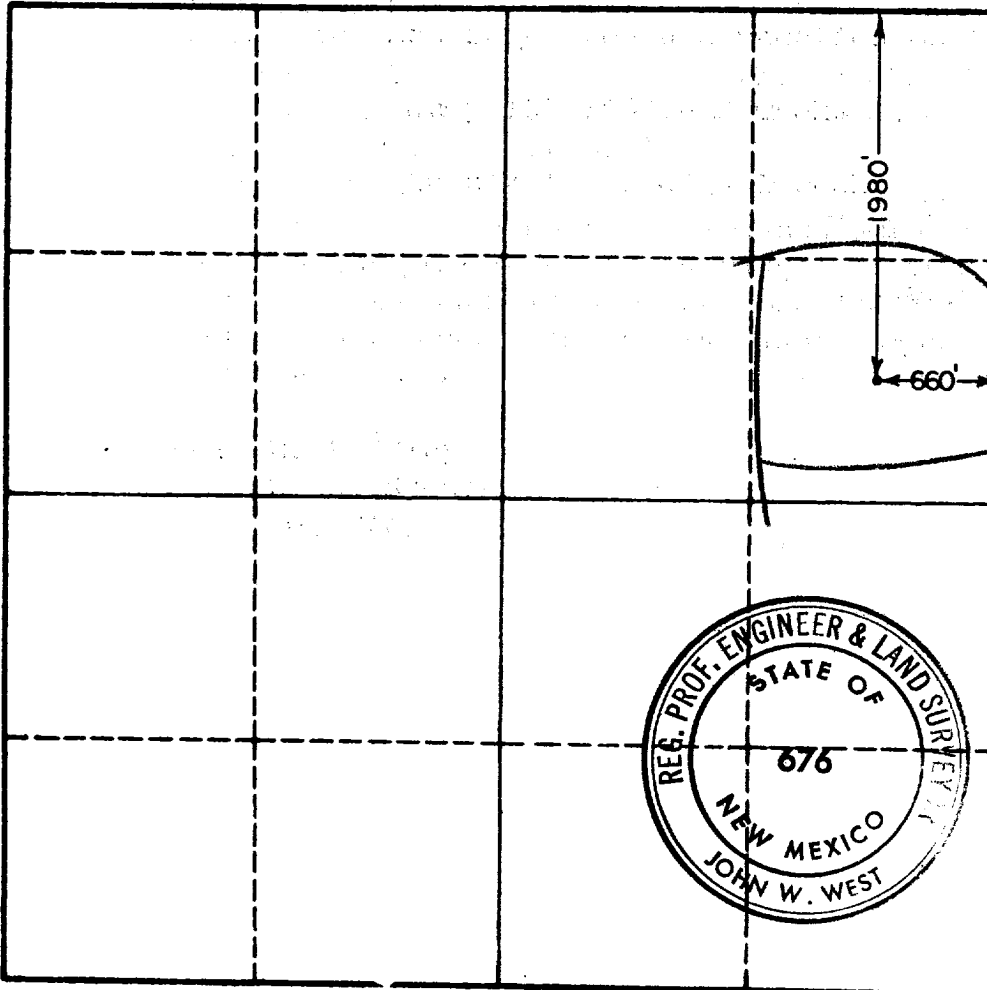

CERTIFICATION

I hereby certify that the information in SECTION A above is true and complete to the best of my knowledge and belief.

Name Percy C. Quinn
Position Dist. Prod. Sup't.
Company Cabot Corporation
Date April 22, 1964

I hereby certify that the well location shown on the plat in SECTION B was plotted from field notes of actual surveys made by me or under my supervision, and that the same is true and correct to the best of my knowledge and belief.

Date Surveyed APRIL 8, 1964
Registered Professional Engineer and/or Land Surveyor, JOHN W. WEST
Certificate No. John W. West
N. M. - P. E. & L. S. NO. 676

0 330 660 990 1320 1650 1980 2310 2640 2970 3300 3630 0