

HUMBLE LEASE NO. 211597 NEW MEXICO OIL CONSERVATION COMMISSION  
STATE LEASE NO. E-9089 Corrected  
FEDERAL LEASE NO. Well Location and Acreage Dedication Plat

Form C-128  
Revised 5/1/57

Section A.

Date Oct 6, 1964

Operator Humble Oil & Refining Co. Lease New Mexico State B.W.  
Well No. 2 Unit Letter F Section 20 Township 8 South Range 33 East NMPM  
Located 1780 Feet From North Line, 1980 Feet From West Line  
County Chaves G. L. Elevation Later Dedicated Acreage 80 Acres  
Name of Producing Formation Penn - Brough "C" Pool Tobac - Penn

1. Is the Operator the only owner\* in the dedicated acreage outlined on the plat below?  
Yes ☒ No ☐
2. If the answer to question one is "no", have the interests of all the owners been consolidated by communitization agreement or otherwise? Yes ☐ No ☐ If answer is "yes," Type of Consolidation \_\_\_\_\_
3. If the answer to question two is "no," list all the owners and their respective interests below:

Owner

Land Description

Section B

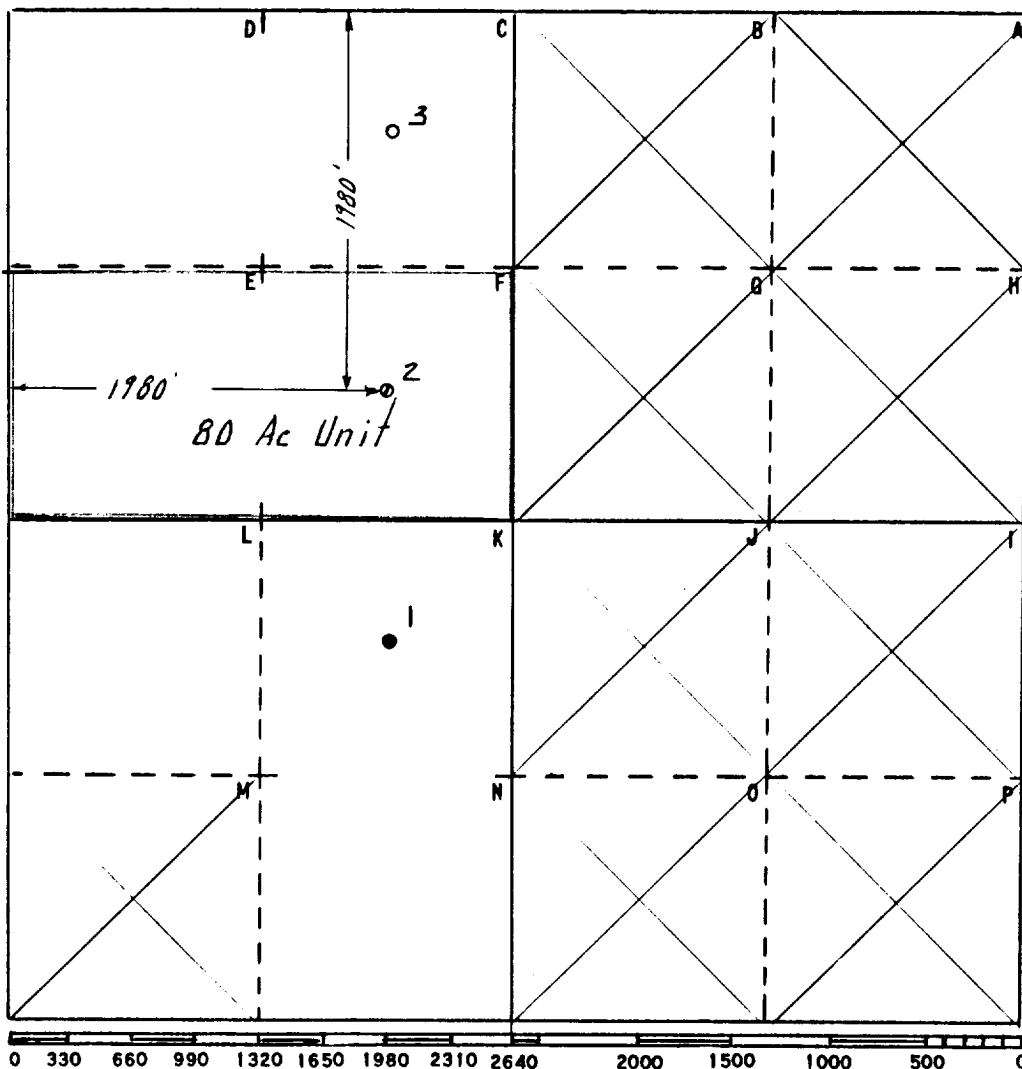

This is to certify that the information in Section A above is true and complete to the best of my knowledge and belief

HUMBLE OIL & REFG. CO.

(Operator)

J. R. Hennessy

(Representative)

Box 1600 Midland, Texas

Address

This is to certify that the well location shown on the plat in Section B was plotted from field notes of actual surveys made by me or under my supervision and that the same is true and correct to the best of my knowledge and belief.

Date Surveyed 6-9-64

H. W. Strickland  
Registered Professional  
Engineer and/or Land Surveyor

Certificate No. 2156

FILE NO. W-A-3589