

Humble Lse. # 211597  
State Lse.No.E-9089

NEW MEXICO OIL CONSERVATION COMMISSION  
WELL LOCATION AND ACREAGE DEDICATION PLAT

Form C-102  
Supersedes C-128  
Effective 1-1-65

All distances must be from the quarter boundaries of the Section.

Operator Humble Oil & Refining Company			Lease New Mexico State # 211597 APR 14 2 30 PM '66		Well No. 5
Unit Letter 0	Section 16	Township T-8-S	Range R-33-E	County Chaves	
Actual Footage Location of Well: 662 feet from the South line and 1997 feet from the East line					
Ground Level Elev: later	Producing Formation San Andres		Pool Undesignated	Dedicated Acreage: 40 Acres	

1. Outline the acreage dedicated to the subject well by colored pencil or hachure marks on the plat below.
2. If more than one lease is dedicated to the well, outline each and identify the ownership thereof (both as to working interest and royalty).
3. If more than one lease of different ownership is dedicated to the well, have the interests of all owners been consolidated by communitization, unitization, force-pooling, etc?

☐ Yes ☐ No If answer is "yes," type of consolidation \_\_\_\_\_

If answer is "no," list the owners and tract descriptions which have actually been consolidated. (Use reverse side of this form if necessary.) \_\_\_\_\_

No allowable will be assigned to the well until all interests have been consolidated (by communitization, unitization, forced-pooling, or otherwise) or until a non-standard unit, eliminating such interests, has been approved by the Commission.

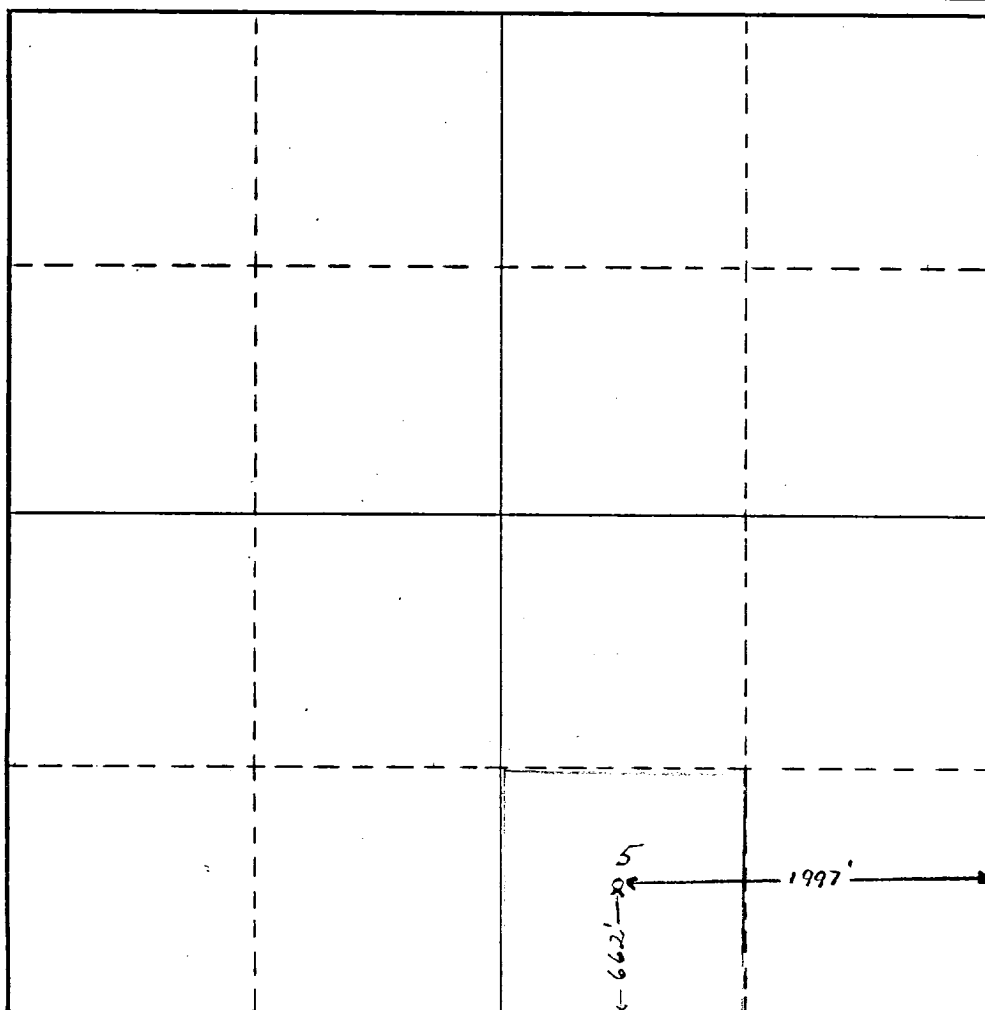

CERTIFICATION

I hereby certify that the information contained herein is true and complete to the best of my knowledge and belief.

Name

Position

Dist. Admin. Supervisor

Company Humble Oil & Refining Co.  
P.O. Box 1600, Midland, Texas

Date

April 14, 1966

I hereby certify that the well location shown on this plat was plotted from field notes of actual surveys made by me or under my supervision, and that the same is true and correct to the best of my knowledge and belief.

Date Surveyed

March 12, 1965

Registered Professional Engineer  
and/or Land Surveyor

/S/ W. S. Westerfeld

Certificate No.

1382

0 330 660 990 1320 1650 1980 2310 2640 2000 1500 1000 500 0