

HUMBLE OIL & REFINING COMPANY

MIDLAND AREA
MIDLAND, TEXAS

11-16-64

Re: ELEVATION

New Mexico Oil Conservation Commission
Box 1545
Hobbs, N. M.

Gentlemen:

The ELEVATION of the following well is: 4393 DF as
reported by Laughlin-Simmons & Company.
COUNTY: Chaves, N. M. Field: Tobac

Humble Oil & Refining Company

No. 1 Tobac-State Oil Unit No. 2

Sec 21, T8S, R33E

660' FNL & 660' FWL of Sec

The above is given you to complete your records for the Form 1,
"Notice of Intention to Drill," filed with you on this well under date of:

11-4-64

HUMBLE OIL & REFINING COMPANY
BILL R. PAYNE, AREA EXPL. MANAGER

By: _____
F. H. McMahon

FHM/1st
Orig & 1 cc: NMOCC
cc: Mr. R. R. McCarty

NOTICE OF INTENTION TO DRILL

Notice must be given to the District Office of the Oil Conservation Commission and approval obtained before drilling or recompletion begins. If changes in the proposed plan are considered advisable, a copy of this notice showing such changes will be returned to the sender. Submit this notice in **QUINTUPLICATE**. One copy will be returned following approval. See additional instructions in Rules and Regulations of the Commission. If State Land submit 6 Copies Attach Form O-128 in triplicate to first 3 copies of form O-101

Midland, Texas
(Place)

11-4-64
(Date)

OIL CONSERVATION COMMISSION
SANTA FE, NEW MEXICO

Gentlemen:

You are hereby notified that it is our intention to commence the Drilling of a well to be known as
Humble Oil & Refining Co.
(Company or Operator)

Tobac-State Oil Unit No. 2, Well No. 1, in D. The well is
(Lease) (Unit)

located 660 feet from the north line and 660 feet from the west line of Section 21, T. 8-S, R. 33-E, NMPM.
(GIVE LOCATION FROM SECTION LINE) Tobac Penn Pool, Chaves County

If State Land the Oil and Gas Lease is No. OG 6006

If patented land the owner is

Address

We propose to drill well with drilling equipment as follows: rotary

The status of plugging bond is on file

Drilling Contractor Unknown

We intend to complete this well in the Penn formation at an approximate depth of 9100 feet.

CASING PROGRAM

We propose to use the following strings of Casing and to cement them as indicated:

Size of Hole	Size of Casing	Weight per Foot	New or Second Hand	Depth	Sacks Cement
15 or 17-1/2	10-3/4 or 13-3/8	32.75 or 48	New	400	180*
9-7/8 or 11	7-5/8 or 8-5/8	24	New	3600	300**
6-3/4 or 7-7/8	4-1/2	9.5 or 11.6	New	9100	250***

If changes in the above plans become advisable we will notify you immediately.

ADDITIONAL INFORMATION (If recompletion give full details of proposed plan of work.)

*Circl to surf.

**Circl to base of salt sec. est. 2300'.

***Circl to 600' above the uppermost pay.

Min mud for samples

HOWCO method of cmtg to be used.

Approved....., 19.....
Except as follows:

No cores.

Sincerely yours,

Humble Oil & Refining Co.
(Company or Operator)

By

Adm. Specialist

Send Communications regarding well to

Name R. R. McCarty

Address Box 1600, Midland, Texas

OIL CONSERVATION COMMISSION

By

Section A.

Date Oct 1, 1964

Operator Humble Oil & Refining Co. Lease Tobac - State Oil Unit No. 2
 Well No. 1 Unit Letter "D" Section 21 Township 8 South Range 33 East NMPM
 Located 660 Feet From North Line, 660 Feet From West Line
 County Chaves G. L. Elevation Later Dedicated Acreage 80 Acres
 Name of Producing Formation Penn (Bough "C") Pool Tobac - Penn

1. Is the Operator the only owner* in the dedicated acreage outlined on the plat below?

Yes No ✓2. If the answer to question one is "no", have the interests of all the owners been consolidated by communitization agreement or otherwise? Yes ✓ No If answer is "yes," Type of Consolidation Unitization

3. If the answer to question two is "no," list all the owners and thier respective interests below:

OwnerLand Description

Section B

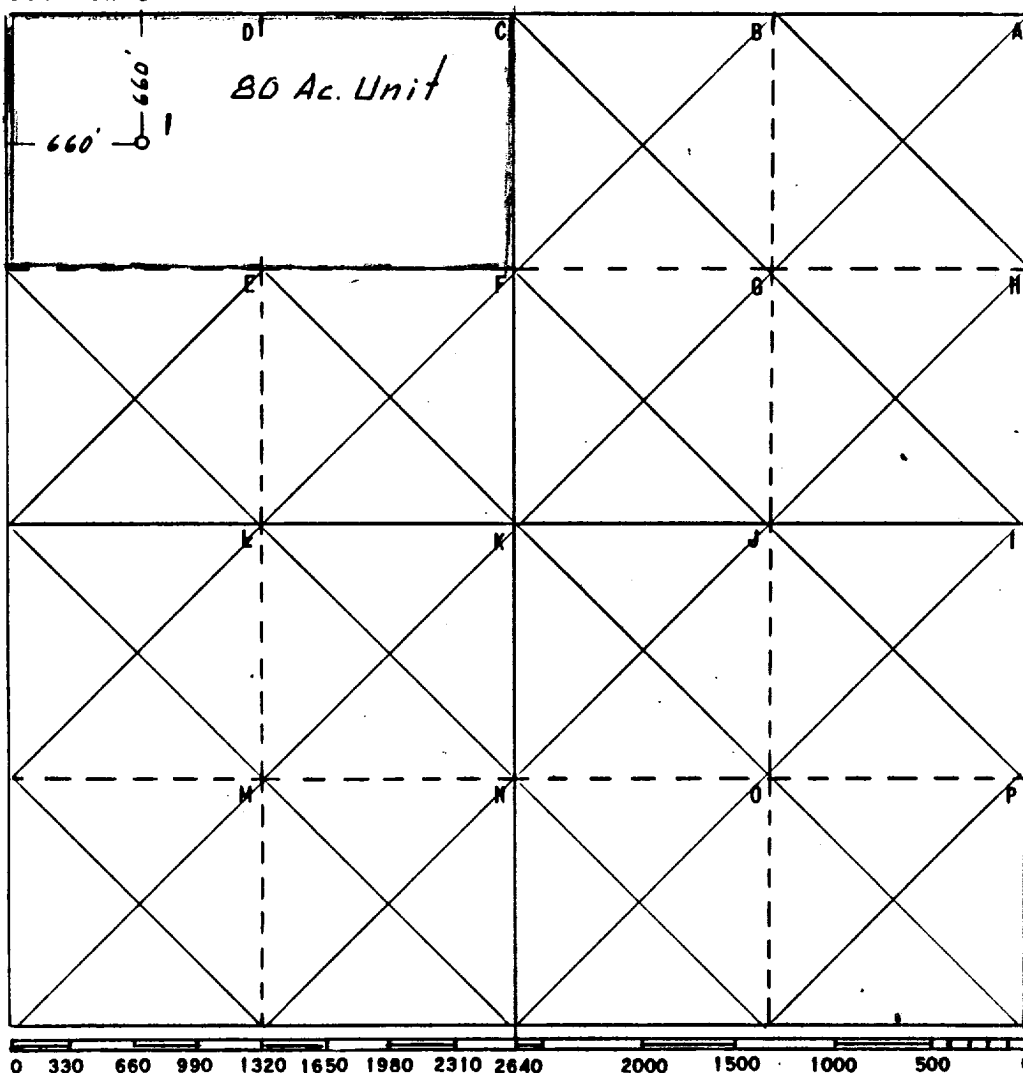

This is to certify that the information in Section A above is true and complete to the best of my knowledge and belief

HUMBLE OIL & REFG. CO.

(Operator)

H. L. Henoc

(Representative)

Box 1600 Midland, Texas

Address

This is to certify that the well location shown on the plat in Section B was plotted from field notes of actual surveys made by me or under my supervision and that the same is true and correct to the best of my knowledge and belief.

Date Surveyed 9-14-64

H. S. Winterfield
 Registered Professional
 Engineer and/or Land Surveyor

Certificate No. 1382

FILE NO. W-A-3602

Humble

" U. S. "

17 | 16

" S T A T E "

15

Shell

20 21

Humble # 600819

Humble

22

80 Ac. Unit

" Tobac - State Oil Unit #2"

Sunset Int.

2-A

Sunset Int.

1-B

T - 8 - S

R - 33 - E

"State"

" S T A T E "

29	28
----	----

27

This is to certify that I am a registered professional
architect and duly licensed in the State of
California. My commission expires from July
first to June thirty next. The fee for my license
has been paid to the

2156 Hutchinson

This Application For Well No. 1

T O B A C - S T A T E O I L U N I T N O . 2

Humble Lease No. 600819

Chaves County, New Mexico

HUMBLE OIL & REFINING COMPANY
SOUTHWEST REGION
PRODUCTION DEPARTMENT
MIDLAND AREA

DRAWN D.L.McKibbin

ENGR. SECTION _____ REVISED _____

SCALE 1"-1000"

JOB NO.

FILE NO.

CHECKED

APPROVED

DATE 9/30/64

W A - 3 6 0 2

New Mexico State Tse. # OG-6006