

NUMBER OF COPIES RECEIVED	
DISTRIBUTION	
SANTA FE	
FILE	
U.S.G.S.	
LAND OFFICE	
TRANSPORTER	OIL GAS
PRORATION OFFICE	
OPERATOR	

NEW MEXICO OIL CONSERVATION COMMISSION
Santa Fe, New Mexico

Form C-101
Revised 12/1/55

NOTICE OF INTENTION TO DRILL

Notice must be given to the District Office of the Oil Conservation Commission and approval obtained before drilling or recompletion begins. If changes in the proposed plan are considered advisable, a copy of this notice showing such changes will be returned to the sender. Submit this notice in QUINTUPLICATE. One copy will be returned following approval. See additional instructions in Rules and Regulations of the Commission. If State Land submit 6 Copies. Attach Form C-128 in triplicate to first 3 copies of Form C-101.

509 W. Texas Avenue, Midland, Texas

(Place)

November 10, 1964

(Date)

OIL CONSERVATION COMMISSION
SANTA FE, NEW MEXICO

Gentlemen:

You are hereby notified that it is our intention to commence the Drilling of a well to be known as

Signal Oil and Gas Company

(Company or Operator)

State , Well No. 30-3, in A The well is
(Lease) (Unit)

located 660 feet from the North line and 660 feet from the
East line of Section 30, T. 8-S, R. 33-E, NMPM.

(GIVE LOCATION FROM SECTION LINE)

 Pool, County

D	C	B	⁸ A <u>660</u>
E	F	G	H
L	K	J	I
M	N	O	P

If State Land the Oil and Gas Lease is No. E-8253

If patented land the owner is

Address

We propose to drill well with drilling equipment as follows: Rotary Tools

The status of plugging bond is Fidelity and Deposit Company
#5291833 for \$10,000, in force.

Drilling Contractor Canary Drilling Co.

We intend to complete this well in the Bough C
formation at an approximate depth of 9050 feet.

CASING PROGRAM

We propose to use the following strings of Casing and to cement them as indicated:

Size of Hole	Size of Casing	Weight per Foot	New or Second Hand	Depth	Sacks Cement
<u>15"</u>	<u>10 3/4</u>	<u>32.75</u>	<u>New</u>	<u>400</u>	<u>To surface</u>
<u>9 7/8"</u>	<u>7 5/8</u>	<u>24</u>	<u>New</u>	<u>3600</u>	<u>300</u>
<u>6 3/4"</u>	<u>4 1/2</u>	<u>11.6</u>	<u>New</u>	<u>9100</u>	<u>200</u>

If changes in the above plans become advisable we will notify you immediately.

ADDITIONAL INFORMATION (If recompletion give full details of proposed plan of work.)

Approved NOV 12 1964, 19
Except as follows:

Sincerely yours,

Signal Oil and Gas Company

(Company or Operator)

By Paul J. Dennis **Paul J. Dennis**

Position Production Engineer

Send Communications regarding well to

Name Signal Oil and Gas Company

Address 509 W. Texas Avenue, Midland, Texas

OIL CONSERVATION COMMISSION

By

NEW MEXICO OIL CONSERVATION COMMISSION

WELL LOCATION AND ACREAGE DEDICATION PLAT

FORM C-128
Revised 5/1/57

SEE INSTRUCTIONS FOR COMPLETING THIS FORM ON THE REVERSE SIDE

SECTION A

Operator SIGNAL OIL & GAS COMPANY			Lease		STATE	Well No. 30-3
Unit Letter A	Section 30	Township 8 SOUTH	Range 33 EAST	County Chaves ROOSEVELT		
Actual Footage Location of Well: 660 feet from the NORTH line and 660 feet from the EAST line						
Ground Level Elev. 4398.2	Producing Formation Bough C		Pool Tobac Penn		Dedicated Acreage: 80 Acres	

1. Is the Operator the only owner in the dedicated acreage outlined on the plat below? YES _____ NO _____. ("Owner" means the person who has the right to drill into and to produce from any pool and to appropriate the production either for himself or for himself and another. (65-3-29 (e) NMSA 1935 Comp.)
2. If the answer to question one is "no," have the interests of all the owners been consolidated by communitization agreement or otherwise? YES _____ NO _____. If answer is "yes," Type of Consolidation _____
3. If the answer to question two is "no," list all the owners and their respective interests below:

Owner	Land Description

SECTION B

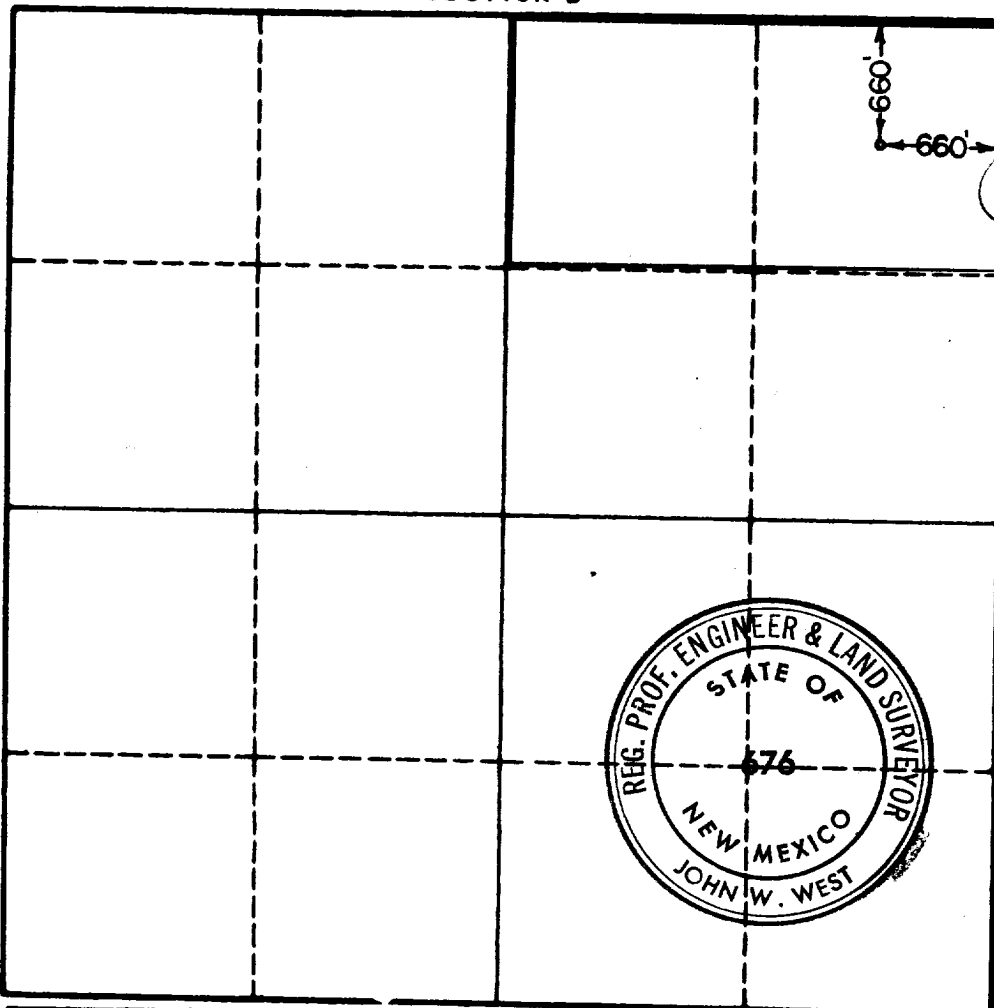

CERTIFICATION

I hereby certify that the information in SECTION A above is true and complete to the best of my knowledge and belief.

Saul J. Dorris
Name
Paul J. Dorris
Position
Production Engineer
Company
Signal Oil and Gas Co.
Date
11/10/64

I hereby certify that the well location shown on the plat in SECTION B was plotted from field notes of actual surveys made by me or under my supervision, and that the same is true and correct to the best of my knowledge and belief.

Date Surveyed
10-16-64
Registered Professional Engineer and/or Land Surveyor, JOHN W. WEST
John W. West
Certificate No.
N. M. - P. E. & L. S. NO. 676

0 330 660 990 1320 1650 1980 2310 2640 2000 1600 1200 800 0