

UNITED STATES  
DEPARTMENT OF THE INTERIOR  
GEOLOGICAL SURVEY

SUBMIT IN TRIPLE COPY  
(Other instructions on reverse side)

Form approved.  
Budget Bureau No. 42-R1424.  
5. LEASE DESIGNATION AND SERIAL NO.

LC-064359-A

6. IF INDIAN, ALLOTTEE OR TRIBE NAME

SUNDRY NOTICES AND REPORTS ON WELLS

(Do not use this form for proposals to drill or to deepen or plug back to a different reservoir. Use "APPLICATION FOR PERMIT—" for such proposals.)

1. OIL WELL  GAS WELL  OTHER Dry Hole

7. UNIT AGREEMENT NAME

2. NAME OF OPERATOR

8. FARM OR LEASE NAME

Deane H. Stoltz

Mobil Federal

3. ADDRESS OF OPERATOR

9. WELL NO.

P. O. Box 1714, Midland, Texas

I-7

4. LOCATION OF WELL (Report location clearly and in accordance with any State requirements.\* See also space 17 below.)  
At surface

10. FIELD AND POOL, OR WILDCAT

2310' FNL and 990' FWL Sec. 7-10S-31E

Wildcat

11. SEC., T., R., M., OR BLK. AND SURVEY OR AREA

Sec. 7-10S-31E

14. PERMIT NO.

15. ELEVATIONS (Show whether DF, RT, GR, etc.)

12. COUNTY OR PARISH

13. STATE

4171 GL 4185 DF

Chaves New Mexico

16. Check Appropriate Box To Indicate Nature of Notice, Report, or Other Data

NOTICE OF INTENTION TO:

SUBSEQUENT REPORT OF:

TEST WATER SHUT-OFF

PULL OR ALTER CASING

WATER SHUT-OFF

REPAIRING WELL

FRACTURE TREAT

MULTIPLE COMPLETE

FRACTURE TREATMENT

ALTERING CASING

SHOOT OR ACIDIZE

ABANDON\*

SHOOTING OR ACIDIZING

ABANDONMENT\*

REPAIR WELL

CHANGE PLANS

(Other)

(Other)

(Note: Report results of multiple completion on Well Completion or Recompletion Report and Log form.)

17. DESCRIBE PROPOSED OR COMPLETED OPERATIONS (Clearly state all pertinent details, and give pertinent dates, including estimated date of starting any proposed work. If well is directionally drilled, give subsurface locations and measured and true vertical depths for all markers and zones pertinent to this work.)\*

This notice is subsequent to conversation with Mr. Shoger on January 11, 1965 pertaining to plugging this well.

After reaching TD of 2,000 feet on January 11, 1965, we proposed to run a gamma ray-neutron log and set cement plugs as follows:

- 65 sacks from 1950 - 1770 feet
- 50 sacks from 225 - 175 feet
- 15 sacks from 40 - Surface

The required marker will be installed and location cleaned up. 10.5# mud will be put above and below all plugs.

18. I hereby certify that the foregoing is true and correct

SIGNED *David Albritton*

TITLE APPROVED

DATE January 14, 1965

(This space for Federal or State office use)

APPROVED BY  
CONDITIONS OF APPROVAL, IF ANY:

TITLE

JAN 28 1965

B. J. SHOGER  
DISTRICT ENGINEER

NOTED

JAN 28 1965

SHOGER

\*See Instructions on Reverse Side

NMOCC - ARTESIA  
NMOCC - HOBBS  
BLM - SANTA FE

UNITED STATES  
DEPARTMENT OF THE INTERIOR  
GEOLOGICAL SURVEY

APPLICATION FOR PERMIT TO DRILL, DEEPEN, OR PLUG BACK

1a. TYPE OF WORK  
 DRILL       DEEPEN       PLUG BACK

b. TYPE OF WELL  
 OIL WELL       GAS WELL       OTHER       SINGLE ZONE       MULTIPLE ZONE

2. NAME OF OPERATOR  
**DEANE H. STOLTZ**

3. ADDRESS OF OPERATOR  
**P. O. Box 1714 - Midland, Texas**

4. LOCATION OF WELL (Report location clearly and in accordance with any State requirements.\*)  
 At surface **2310' FNL and 990' FWL Section 7-105-31E.**  
 At proposed prod. zone

5. LEASE DESIGNATION AND SERIAL NO.  
**LC-064359-A**

6. IF INDIAN, ALLOTTEE OR TRIBE NAME  
 -----

7. UNIT AGREEMENT NAME  
 -----

8. FARM OR LEASE NAME  
**Mobil Federal**

9. WELL NO.  
**1-7**

10. FIELD AND POOL, OR WILDCAT  
**Wildcat**

11. SEC., T., E., M., OR BLK. AND SURVEY OR AREA  
**Sec. 7-105-31E.**

12. COUNTY OR PARISH      13. STATE  
**Chaves      New Mexico**

14. DISTANCE IN MILES AND DIRECTION FROM NEAREST TOWN OR POST OFFICE\*  
**40 miles East of Roswell, New Mexico**

15. DISTANCE FROM PROPOSED\* LOCATION TO NEAREST PROPERTY OR LEASE LINE, FT. (Also to nearest drlg. line, if any)

16. NO. OF ACRES IN LEASE  
**2367.03**

17. NO. OF ACRES ASSIGNED TO THIS WELL  
**40**

18. DISTANCE FROM PROPOSED LOCATION\* TO NEAREST WELL, DRILLING, COMPLETED, OR APPLIED FOR, ON THIS LEASE, FT.

19. PROPOSED DEPTH  
**2000 feet**

20. ROTARY OR CABLE TOOLS  
**Cable Tools**

21. ELEVATIONS (Show whether DF, RT, GR, etc.)  
**4171 GL**

22. APPROX. DATE WORK WILL START\*  
**December 30, 1964**

23. PROPOSED CASING AND CEMENTING PROGRAM

SIZE OF HOLE	SIZE OF CASING	WEIGHT PER FOOT	SETTING DEPTH	QUANTITY OF CEMENT
10"	8"	24#	200'	100 sacks
7"	5 1/2"	15#	2000'	100 sacks

Propose to drill to test Yates- Seven Rivers formation at approximate depth of 2000 feet. Will set 200' of 8 5/8" surface casing and circulate with 100 sacks cement. If well is productive, will set 2000' 5 1/2" casing and cement with 100 sacks cement.

RECEIVED

DEC 31 1964

O. C. C.  
MARTESIA, OFFICE

APPROVED

DEC 30 1964

J. W. SUTHERLAND  
ACTING DISTRICT ENGINEER

IN ABOVE SPACE DESCRIBE PROPOSED PROGRAM: If proposal is to deepen or plug back, give data on present productive zone and proposed new productive zone. If proposal is to drill or deepen directionally, give pertinent data on subsurface locations and measured and true vertical depths. Give blowout preventer program, if any.

24. SIGNED Len Mayer TITLE Agent DATE December 28, 1964

(This space for Federal or State office use)

PERMIT NO. \_\_\_\_\_ APPROVAL DATE \_\_\_\_\_

APPROVED BY \_\_\_\_\_ TITLE \_\_\_\_\_ DATE \_\_\_\_\_

CONDITIONS OF APPROVAL, IF ANY:

RECEIVED  
DEC 29 1964

\*See Instructions On Reverse Side

U. S. GEOLOGICAL SURVEY  
ROSWELL, NEW MEXICO

**NEW MEXICO OIL CONSERVATION COMMISSION  
WELL LOCATION AND ACREAGE DEDICATION PLAT**

FORM C-128  
Revised 5/1/57

**SEE INSTRUCTIONS FOR COMPLETING THIS FORM ON THE REVERSE SIDE**

**SECTION A**

Operator <b>DEAN H. STOLTZ</b>		Lease <b>MOBIL FEDERAL</b>		Well No. <b>1</b>
Unit Letter <b>E</b>	Section <b>7</b>	Township <b>10 SOUTH</b>	Range <b>31 EAST</b>	County <b>CHAVES</b>
Actual Footage Location of Well: <b>2310</b> feet from the <b>NORTH</b> line and <b>990</b> feet from the <b>WEST</b> line				
Ground Level Elev.	Producing Formation	Pool	Dedicated Acreage: Acres	

1. Is the Operator the only owner in the dedicated acreage outlined on the plat below? YES \_\_\_\_\_ NO \_\_\_\_\_. ("Owner" means the person who has the right to drill into and to produce from any pool and to appropriate the production either for himself or for himself and another. (65-3-29 (e) NMSA 1935 Comp.)
2. If the answer to question one is "no," have the interests of all the owners been consolidated by communitization agreement or otherwise? YES \_\_\_\_\_ NO \_\_\_\_\_. If answer is "yes," Type of Consolidation \_\_\_\_\_
3. If the answer to question two is "no," list all the owners and their respective interests below:

Owner	Land Description <b>DEC 31 1964</b>
	<b>O. C. C.</b>

**ARTESIA, OFFICE  
CERTIFICATION**

I hereby certify that the information in SECTION A above is true and complete to the best of my knowledge and belief.

Name <i>Lea Mayer</i>
Position <i>Agent</i>
Company <i>DEAN H. STOLTZ</i>
Date <i>12-28-64</i>

**SECTION B**

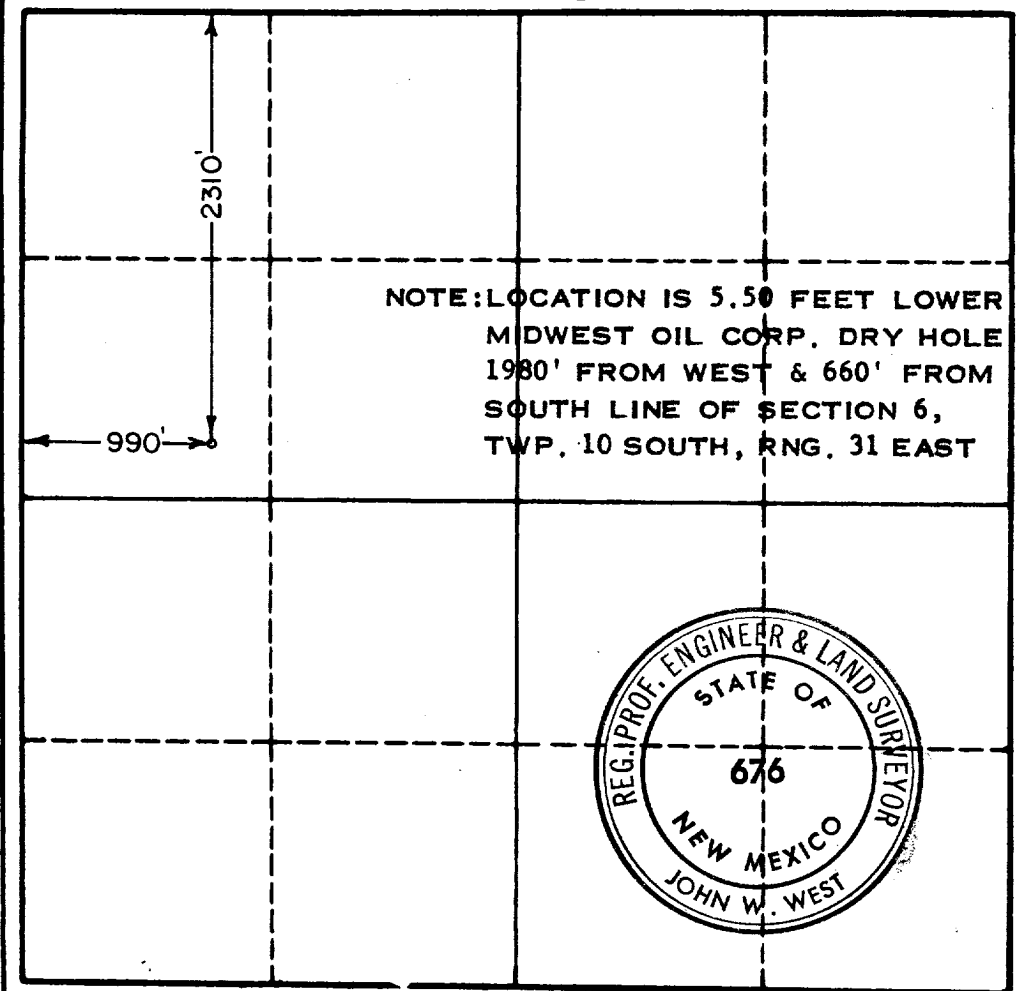

I hereby certify that the well location shown on the plat in SECTION B was plotted from field notes of actual surveys made by me or under my supervision, and that the same is true and correct to the best of my knowledge and belief.

Date Surveyed <b>12-26-64</b>
Registered Professional Engineer and/or Land Surveyor, <b>JOHN W. WEST</b>
<i>John W. West</i>
Certificate No. <b>N.M. - P.E. &amp; L.S. NO. 676</b>

