

UNITED STATES
DEPARTMENT OF THE INTERIOR
GEOLOGICAL SURVEY

APPLICATION FOR PERMIT TO DRILL, DEEPEN, OR PLUG BACK

1a. TYPE OF WORK
DRILL ☒ DEEPEN ☐ PLUG BACK ☐

b. TYPE OF WELL
OIL WELL ☒ GAS WELL ☐ OTHER ☐

2. NAME OF OPERATOR
John H. Trigg

3. ADDRESS OF OPERATOR
O. C. C. ARTERIA, OFFICE

4. LOCATION OF WELL (Report location clearly and in accordance with any State requirements.)*
At surface **990 Ft. From South Line & 1917 Ft. From East Line**
At proposed prod. zone **Same**

14. DISTANCE IN MILES AND DIRECTION FROM NEAREST TOWN OR POST OFFICE*

15. DISTANCE FROM PROPOSED* LOCATION TO NEAREST PROPERTY OR LEASE LINE, FT. (Also to nearest drlg. unit line, if any) **990 Ft.**

16. NO. OF ACRES IN LEASE **2,554.50**

17. NO. OF ACRES ASSIGNED TO THIS WELL **40**

18. DISTANCE FROM PROPOSED LOCATION* TO NEAREST WELL, DRILLING, COMPLETED, OR APPLIED FOR, ON THIS LEASE, FT. **4150 Ft.**

19. PROPOSED DEPTH **4150 Ft.**

20. ROTARY OR CABLE TOOLS **Rotary**

21. ELEVATIONS (Show whether DF, RT, GR, etc.) **4180' G. L.**

22. APPROX. DATE WORK WILL START* **September 22, 1964**

5. LEASE DESIGNATION AND SERIAL NO. **22a, Cruces 062486**

6. IF INDIAN, ALLOTTEE OR TRIBE NAME

7. UNIT AGREEMENT NAME

8. FARM OR LEASE NAME **Federal Trigg**

9. WELL NO. **38-4**

10. FIELD AND POOL, OR WILDCAT **Wildcat**

11. SEC., T., R., M., OR BLK. AND SURVEY OR AREA **Sec. 4, T14S., R31E.**

12. COUNTY OR PARISH **Chaves**

13. STATE **New Mexico**

PROPOSED CASING AND CEMENTING PROGRAM

SIZE OF HOLE	SIZE OF CASING	WEIGHT PER FOOT	SETTING DEPTH	QUANTITY OF CEMENT
12 1/4"	8 5/8"	24#	1130 Ft.	75 Sacks
7 7/8"	4 1/2"	10.5#	4100 Ft.	250 Sacks

I plan to drill a well at this location to test the San Andres formation at an approximate depth of 4100 feet. I am planning to re-enter an old hole drilled in June, 1958 to a depth of 1130 feet to test for water in the Santa Rosa sand. 8 5/8 inch casing was run to 1130 feet in the anhydrite immediately above the salt section and cemented with 75 sacks of regular neat cement. The casing was perforated with four shots per foot at the following intervals: 1013-1030, 1038-1046, 1083-1086, and 1094-1100. I now propose to squeeze these perforations with approximately 100 sacks of cement before drilling below the 8 5/8 inch casing.

Cementing of the 4 1/2 inch production casing will be in accordance with U.S.G.S. regulations.

IN ABOVE SPACE DESCRIBE PROPOSED PROGRAM: If proposal is to deepen or plug back, give data on present productive zone and proposed new productive zone. If proposal is to drill or deepen directionally, give pertinent data on subsurface locations and measured and true vertical depths. Give blowout preventer program, if any.

24. ORIGINAL SIGNED BY JOHN H. TRIGG
SIGNED John H. Trigg TITLE Owner DATE Sept. 17, 1964
(This space for Federal or State office use)

PERMIT NO. _____ APPROVAL DATE _____

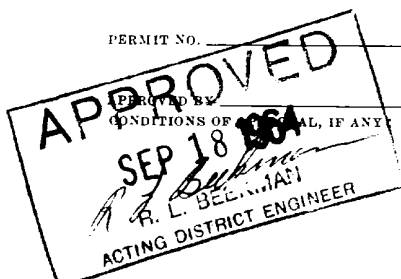

*See Instructions On Reverse Side

NEW MEXICO OIL CONSERVATION COMMISSION
WELL LOCATION AND ACREAGE DEDICATION PLAT

FORM C-128
Revised 5/1/57

SEE INSTRUCTIONS FOR COMPLETING THIS FORM ON THE REVERSE SIDE

SECTION A

Operator JOHN H. TRIGG		Lease TRIGG FED.		Well No. 38-4
Unit Letter Q	Section 4	Township 14 SOUTH	Range 31 EAST	County CHAVES
Actual Footage Location of Well: 990 feet from the SOUTH line and 1917 feet from the EAST line				
Ground Level Elev. 4180 G. L.	Producing Formation		Pool Wildcat	Dedicated Acreage: 40 Acres

1. Is the Operator the only owner in the dedicated acreage outlined on the plat below? YES X NO ____ . ("Owner" means the person who has the right to drill into and to produce from any pool and to appropriate the production either for himself or for himself and another. (65-3-29 (a) NMSA 1935 Comp.)
2. If the answer to question one is "no," have the interests of all the owners been consolidated by communitization agreement or otherwise? YES ____ NO ____ . If answer is "yes," Type of Consolidation ____
3. If the answer to question two is "no," list all the owners and their respective interests below:

RECEIVED

SEP 21 1964

SECTION B

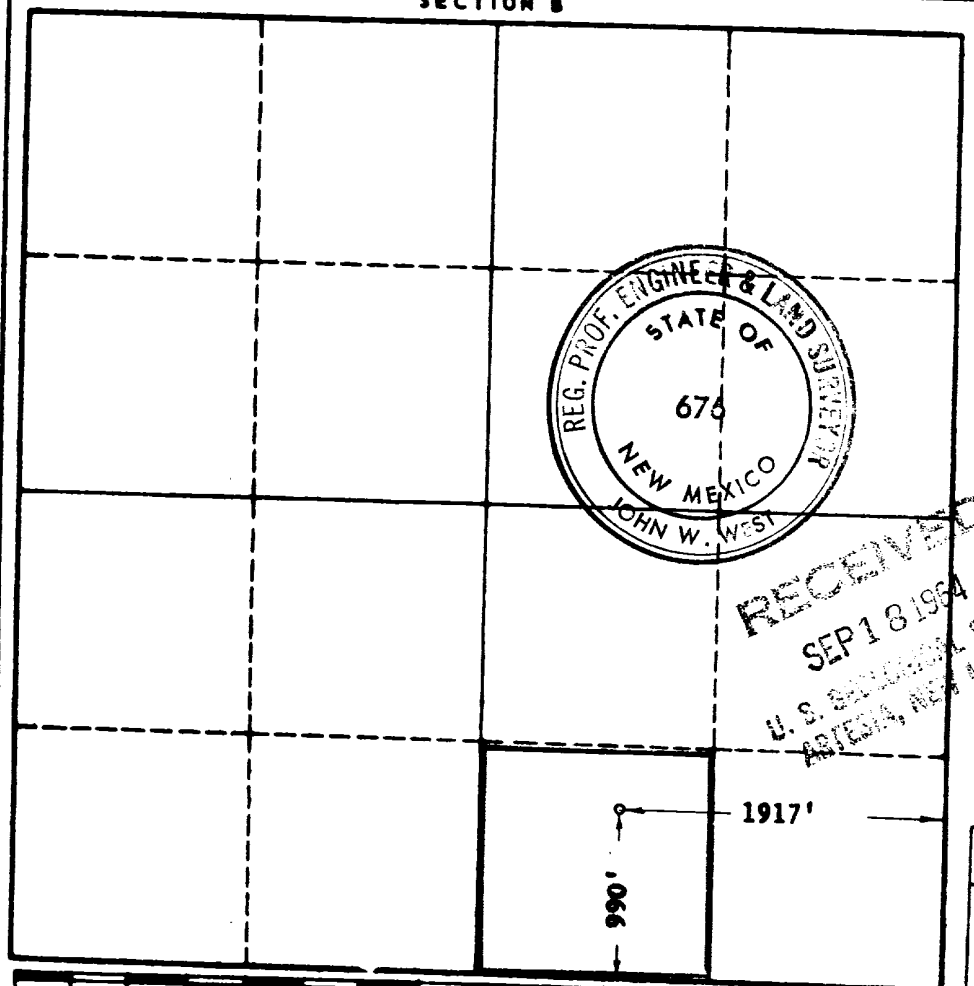

O. C. B.
ARTESIAN OFFICE

I hereby certify that the information in SECTION A above is true and complete to the best of my knowledge and belief.

Name	John H. Trigg
Position	Owner
Company	John H. Trigg
Date	September 17, 1964

I hereby certify that the well location shown on the plat in SECTION B was plotted from field notes of actual surveys made by me or under my supervision, and that the same is true and correct to the best of my knowledge and belief.

Date Surveyed	4-16-1964
Registered Professional Engineer and/or Land Surveyor,	JOHN W. WEST
Certificate No.	N. M. - P. E. & L. S. NO. 676