

NEW MEXICO OIL CONSERVATION COMMISSION
WELL LOCATION AND ACREAGE DEDICATION PLAT

FORM C-128
Revised 5/1/57

SEE INSTRUCTIONS FOR COMPLETING THIS FORM ON THE REVERSE SIDE

SECTION A

Operator <i>A Division of Allied Chemical Corp.</i>		Lease		Well No.	
UNION TEXAS PETROLEUM CORP.		ALLEN-FEDERAL		1	
Unit Letter	Section	Township	Range	County	
M	12	8 SOUTH	31 EAST	CHAVES	
Actual Footage Location of Well:					
660		feet from the SOUTH line and		660 feet from the WEST line	
Ground Level Elev.	Producing Formation		Pool		Dedicated Acreage:
4310	San Andres		Wildcat		40 Acres

1. Is the Operator the only owner in the dedicated acreage outlined on the plat below? YES ☒ NO ____ ("Owner" means the person who has the right to drill into and to produce from any pool and to appropriate the production either for himself or for himself and another. (65-3-29 (a) NMSA 1935 Comp.)
2. If the answer to question one is "no," have the interests of all the owners been consolidated by communitization agreement or otherwise? YES ____ NO ____ . If answer is "yes," Type of Consolidation ____
3. If the answer to question two is "no," list all the owners and their respective interests below:

Owner	Land Description

RECEIVED
DEC - 9 1964

SECTION B

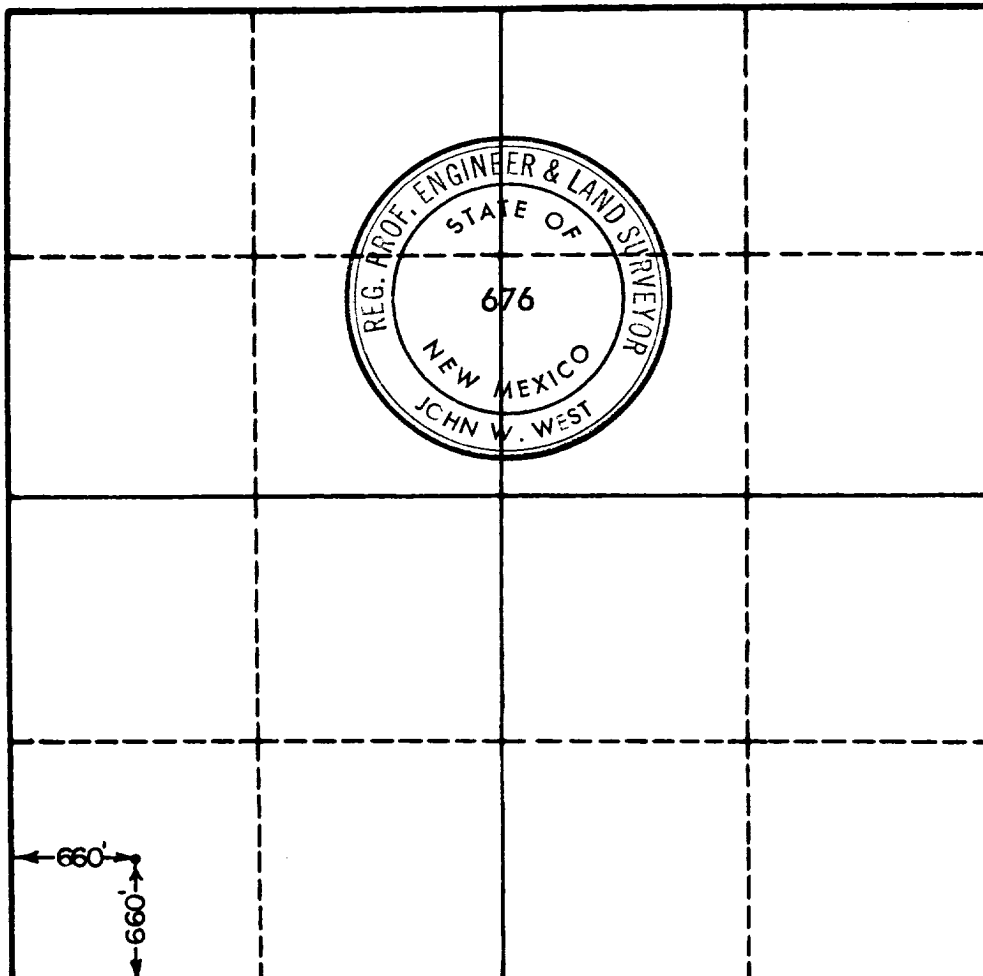

U. S. GEOLOGICAL SURVEY
ROSWell, NEW MEXICO
I hereby certify that the information in SECTION A above is true and complete to the best of my knowledge and belief.

Name *R. L. Stover*
Position
District Superintendent
Company
Union Texas Petr. Corp.
Date
Dec 7, 1964

I hereby certify that the well location shown on the plat in SECTION B was plotted from field notes of actual surveys made by me or under my supervision, and that the same is true and correct to the best of my knowledge and belief.

Date Surveyed
12-3-64
Registered Professional Engineer and/or Land Surveyor, JOHN W. WEST
John W. West
Certificate No.
N. M. - P. E. & L. S. NO. 676

