

NEW MEXICO OIL CONSERVATION COMMISSION
WELL LOCATION AND ACREAGE DEDICATION PLAT

Form C-102
Supersedes C-128
Effective 1-1-65

HOBBS OFFICE O. C. C.

All distances must be from the outer boundaries of the Section.

Operator Champlin Petroleum Company		Lease Signal State		Well No. MAR 23 11 48 AM '66	
Non-Operator: Warren American Oil Company					
Init Letter A	Section 1	Township 8-S	Range 32-E	County Chaves	
Actual Footage Location of Well: 660 feet from the North line and 660 feet from the East line					
Ground Level Elev.	Producing Formation San Andres	Pool Wildcat	Dedicated Acreage: 40 Acres		

1. Outline the acreage dedicated to the subject well by colored pencil or hachure marks on the plat below.
2. If more than one lease is dedicated to the well, outline each and identify the ownership thereof (both as to working interest and royalty).
3. If more than one lease of different ownership is dedicated to the well, have the interests of all owners been consolidated by communitization, unitization, force-pooling, etc?

☒ Yes ☐ No If answer is "yes," type of consolidation **Farmout (See Reverse Side)**

If answer is "no," list the owners and tract descriptions which have actually been consolidated. (Use reverse side of this form if necessary.)

No allowable will be assigned to the well until all interests have been consolidated (by communitization, unitization, forced-pooling, or otherwise) or until a non-standard unit, eliminating such interests, has been approved by the Commission.

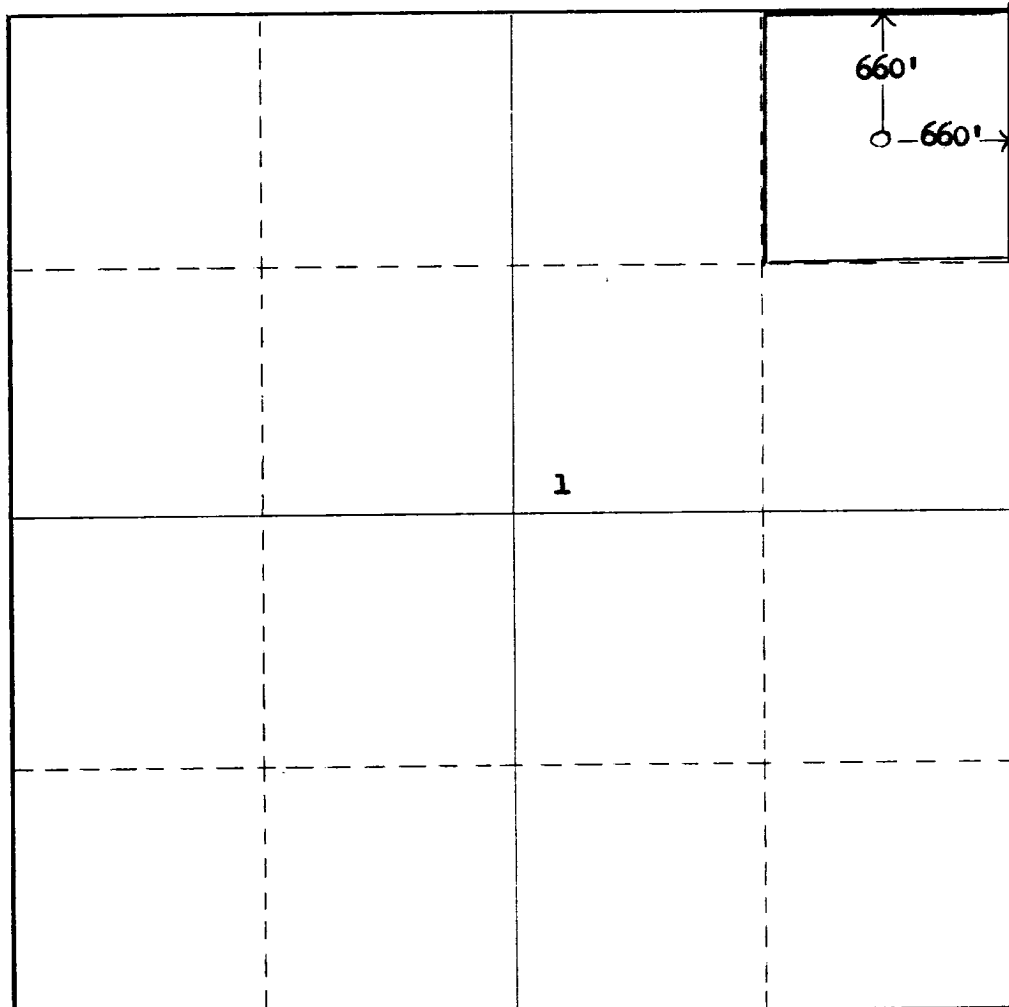

CERTIFICATION

I hereby certify that the information contained herein is true and complete to the best of my knowledge and belief.

H. N. Brown

Name **H. N. Brown**
Position **District Superintendent**

Company **Champlin Petroleum Company**
Date **March 22, 1966**

Date

I hereby certify that the well location shown on this plat was plotted from field notes of actual surveys made by me or under my supervision, and that the same is true and correct to the best of my knowledge and belief.

March 10, 1966
Date Surveyed

Registered Professional Engineer and/or Land Surveyor

Ed Stamp
Certificate No. **1069**

22' 11' 8"

Champlin Petroleum Company (Operator) and Warren American Oil Company (Non-Operator) are securing Farmout from Signal Oil & Gas Company on State of New Mexico Lease OG-528.