

**NEW MEXICO OIL CONSERVATION COMMISSION
WELL LOCATION AND ACREAGE DEDICATION PLAT**

Form CH-102
Supersedes C-128
Effective 1-4-65

All distances must be from the outer boundaries of the Section.

Operator SOUTHERN PETROLEUM EXPLORATION, INC.			Lease 1" STATE APR 17 8 25 AM '67		Well No. 2
Unit Letter B	Section 6	Township 8 SOUTH	Range 33 EAST	County CHAVES	
Actual Footage Location of Well: 660 feet from the NORTH line and 1980 feet from the EAST line					
Ground Level Elev. 4450	Producing Formation San Andres	Pool CHAVES	Dedicated Acreage 39.95 Acres		

1. Outline the acreage dedicated to the subject well by colored pencil or hatchure marks on the plat below.
2. If more than one lease is dedicated to the well, outline each and identify the ownership thereof (both as to working interest and royalty).
3. If more than one lease of different ownership is dedicated to the well, have the interests of all owners been consolidated by communization, unitization, force-pooling, etc?

☐ Yes ☐ No If answer is "yes," type of consolidation _____

If answer is "no," list the owners and tract descriptions which have actually been consolidated. (Use reverse side of this form if necessary.) _____

No allowable will be assigned to the well until all interests have been consolidated (by communization, unitization, forced-pooling, or otherwise) or until a non-standard unit, eliminating such interests, has been approved by the Commission.

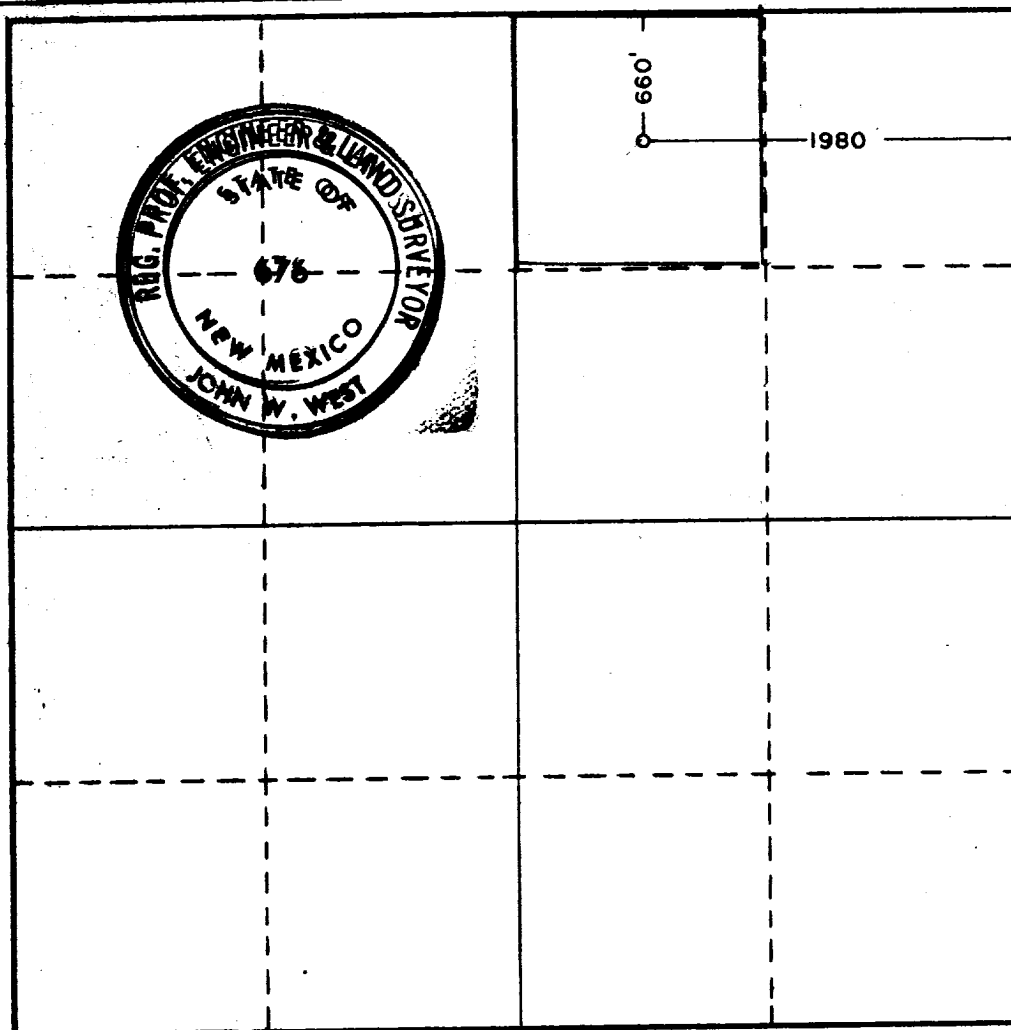

CERTIFICATION

I hereby certify that the information contained herein is true and complete to the best of my knowledge and belief.

Name

B. C. Hicks

Position

District Land Manager

Company

Southern Pet. Expl., Inc.

Date

April 14, 1967

I hereby certify that the well location shown on this plat was plotted from field notes of actual surveys made by me or under my supervision, and that the same is true and correct to the best of my knowledge and belief.

Date Surveyed

4-13-67

Registered Professional Engineer and/or Land Surveyor

Certificate No.

676

173