

NEW MEXICO OIL CONSERVATION COMMISSION
WELL LOCATION AND ACREAGE DEDICATION PLAT

Form O-10
Supersedes O-128
Effective 1-1-65

All distances must be from the outer boundaries of the section. **HUBBS OFFICE O. C. C.**

Owner PAN AMERICAN PETROLEUM CORPORATION		Lease GASKETT "E" JUN 15 7 41 AM '67		Well No. 2
Section H	Section 15	Township 8 SOUTH	Range 30 EAST	County CHAVES
Actual Well Location of Well:				
1980 feet from the NORTH line and		660 feet from the EAST line		
Ground Level Elev. San Andres	Producing Formation CATO San Andres	Dedicated Acreage 40		Acres

1. Outline the acreage dedicated to the subject well by colored pencil or hatchure marks on the plat below.
2. If more than one lease is dedicated to the well, outline each and identify the ownership thereof (both as to working interest and royalty).
3. If more than one lease of different ownership is dedicated to the well, have the interests of all owners been consolidated by communitization, unitization, force-pooling, etc?

☐ Yes ☐ No If answer is "yes," type of consolidation _____

If answer is "no," list the owners and tract descriptions which have actually been consolidated. (Use reverse side of this form if necessary.) _____

No allowable will be assigned to the well until all interests have been consolidated (by communitization, unitization, forced-pooling, or otherwise) or until a non-standard unit, eliminating such interests, has been approved by the Commission.

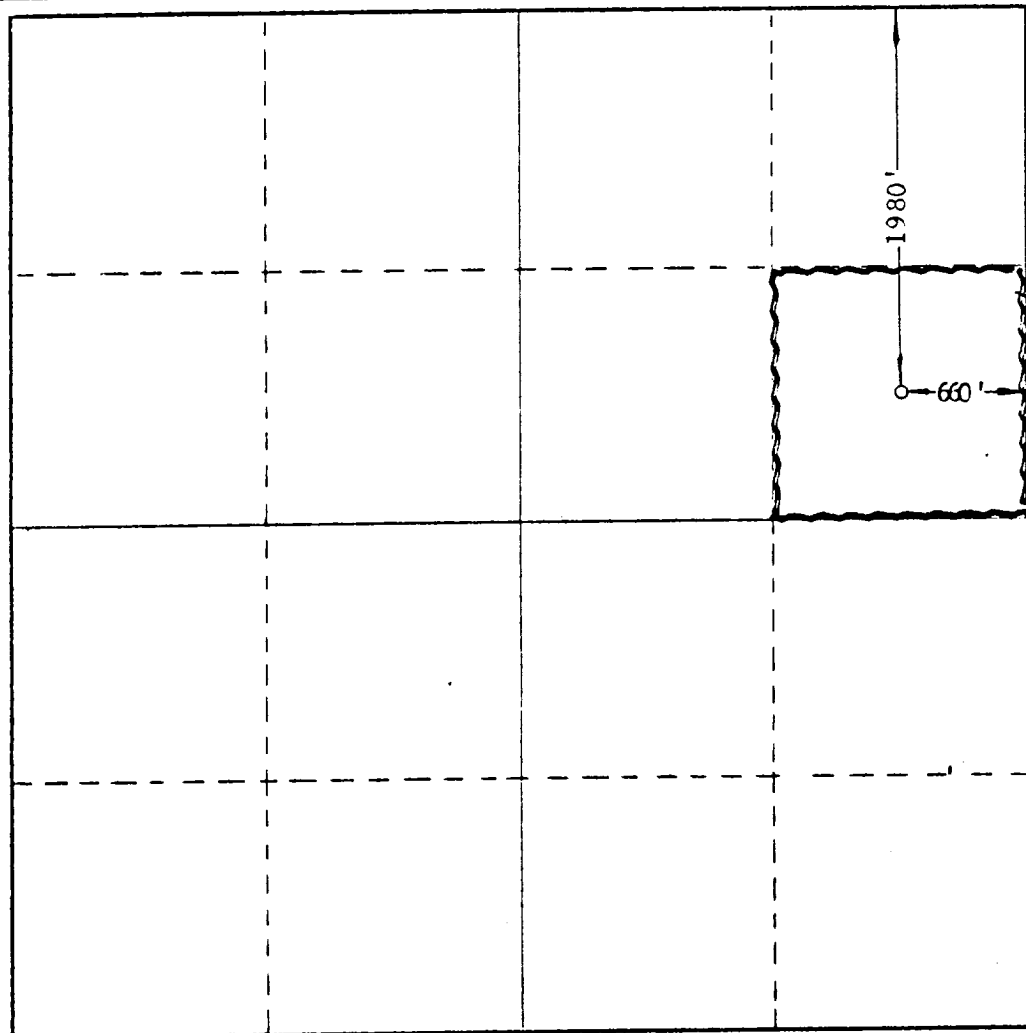

CERTIFICATION

I hereby certify that the information contained herein is true and complete to the best of my knowledge and belief.

[Signature]
Date _____

AREA SUPERINTENDENT

PAN AMERICAN PETROLEUM CORPORATION

Date **6-12-67**

I hereby certify that the well location shown on this plat was plotted from field notes of actual surveys made by me or under my supervision, and that the same is true and correct to the best of my knowledge and belief.

Date Surveyed **6/10/67**

Registered Professional Engineer and Well Log Surveyor

[Signature]
John W. West

676

0 330 660 990 1320 1650 1980 2310 2640 2000 1500 1000 500 0

173