

UNITED STATES
DEPARTMENT OF THE INTERIOR
GEOLOGICAL SURVEY
OFFICE O. C. C.

APPLICATION FOR PERMIT TO DRILL, DEEPEN, OR PLUG BACK

1a. TYPE OF WORK

DRILL ☒DEEPEN ☐PLUG BACK ☐

b. TYPE OF WELL

OIL
WELL ☒GAS
WELL ☐OTHER ☐SINGLE
ZONE ☒MULTIPLE
ZONE ☐

2. NAME OF OPERATOR

SOUTHERN MINERALS CORP.

3. ADDRESS OF OPERATOR

P.O. BOX 716 CORPUS CHRISTI, TEXAS 78403

4. LOCATION OF WELL (Report location clearly and in accordance with any State requirements.)*

At surface

1980 ft. FEL, 660 ft. FSL Sec. 6, T-9-S, R-31-E

At proposed prod. zone

same

14. DISTANCE IN MILES AND DIRECTION FROM NEAREST TOWN OR POST OFFICE*

15 mi. SE of Elkins

15. DISTANCE FROM PROPOSED*

LOCATION TO NEAREST

PROPERTY OR LEASE LINE, FT.

(Also to nearest drlg. unit line, if any)

660'

16. NO. OF ACRES IN LEASE

446.57

17. NO. OF ACRES ASSIGNED
TO THIS WELL

40

18. DISTANCE FROM PROPOSED LOCATION*
TO NEAREST WELL, DRILLING, COMPLETED,
OR APPLIED FOR, ON THIS LEASE, FT.

1 mi. NW

19. PROPOSED DEPTH

4000'

20. ROTARY OR CABLE TOOLS

Rotary

21. ELEVATIONS (Show whether DF, RT, GR, etc.)

4192.2 G.L.

22. APPROX. DATE WORK WILL START*

On Approval

23.

PROPOSED CASING AND CEMENTING PROGRAM

SIZE OF HOLE	SIZE OF CASING	WEIGHT PER FOOT	SETTING DEPTH	QUANTITY OF CEMENT
11	8-5/8	24	375	350
7-7/8	4-1/2	10.5	4000	100

It is planned to drill a 4000 ft. San Anres test at the location described above. Surface casing will be run as shown above and cement circulated to surface. It is also planned to core or drill stem test the San Andres pay zone and if production is indicated 4-1/2" casing will be run and the well treated with acid and/or sand fractured and the well completed for production.

IN ABOVE SPACE DESCRIBE PROPOSED PROGRAM: If proposal is to deepen or plug back, give data on present productive zone and proposed new productive zone. If proposal is to drill or deepen directionally, give pertinent data on subsurface locations and measured and true vertical depths. Give blowout preventer program, if any.

24.

SIGNED

TITLE Agent

DATE 4-15-69

(This space for Federal or State office use)

PERMIT NO.

APPROVED BY
CONDITIONS OF APPROVAL, IF ANY:
APR 15 1969
R. L. BEEKMA

THIS APPROVAL IS RESCINDED IF OPERATIONS
ARE NOT COMMENCED WITHIN 3 MONTHS.
EXPIRES JUL 19 1969

DATE

*See Instructions On Reverse Side

Instructions

General: This form is designed for submitting proposals to perform certain well operations, as indicated, on all types of lands and leases for appropriate action by either a Federal or a State agency, or both, pursuant to applicable Federal and/or State laws and regulations. Any necessary special instructions concerning the use of this form and the number of copies to be submitted, particularly with regard to local, area, or regional procedures and practices, either are shown below or will be issued by, or may be obtained from, the local Federal and/or State office.

Item 1: If the proposal is to redrill to the same reservoir at a different subsurface location or to a new reservoir, use this form with appropriate notations. Consult applicable State or Federal regulations concerning subsequent work proposals or reports on the well.

Item 4: If there are no applicable State requirements, locations on Federal or Indian land should be described in accordance with Federal requirements. Consult local State or Federal office for specific instructions.

Item 14: Needed only when location of well cannot readily be found by road from the land or lease description. A plat, or plats, separate or on this reverse side, showing the roads to, and the surveyed location of, the well, and any other required information, should be furnished when required by Federal or State agency offices.

Items 15 and 18: If well is to be, or has been directionally drilled, give distances for subsurface location of hole in any present or objective production zone.

Item 22: Consult applicable Federal or State regulations, or appropriate officials, concerning approval of the proposal before operations are started.

NEW MEXICO OIL CONSERVATION COMMISSION
WELL LOCATION AND ACREAGE DEDICATION PLAT

Form C-102
 Supersedes C-128
 Effective 1-1-65

All distances must be from the outer boundary of the Section.

Operator SOUTHERN MINERALS CORP.			Lease APR 23 1969 HARRIS FEDERAL		Well No. 1
Unit Letter O	Section 6	Township 9 SOUTH	Range 31 EAST	County CHAVES	
Actual Footage Location of Well:					
660 feet from the SOUTH line and		1980 feet from the EAST line			
Ground Level Elev. 4192.2	Producing Formation San Andres	Pool Wildcat	Dedicated Acreage: SW 1/4 SE 1/4 40 Acres		

1. Outline the acreage dedicated to the subject well by colored pencil or hachure marks on the plat below.
2. If more than one lease is dedicated to the well, outline each and identify the ownership thereof (both as to working interest and royalty).
3. If more than one lease of different ownership is dedicated to the well, have the interests of all owners been consolidated by communitization, unitization, force-pooling, etc?

☐ Yes ☐ No If answer is "yes," type of consolidation _____

If answer is "no," list the owners and tract descriptions which have actually been consolidated. (Use reverse side of this form if necessary.) _____

No allowable will be assigned to the well until all interests have been consolidated (by communitization, unitization, forced-pooling, or otherwise) or until a non-standard unit, eliminating such interests, has been approved by the Commission.

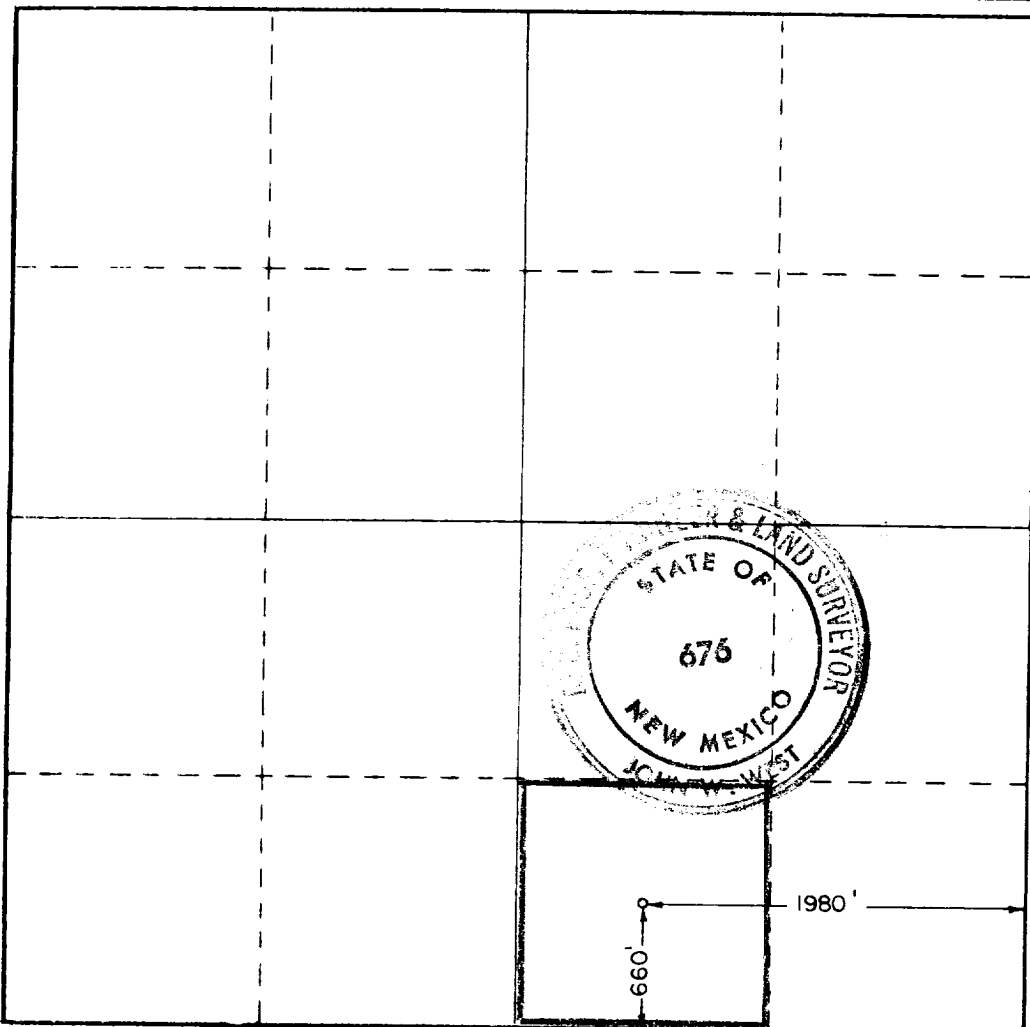

CERTIFICATION

I hereby certify that the information contained herein is true and complete to the best of my knowledge and belief.

Name
W.G. McCoy

Position
Agent

Company
Southern Minerals Corp.

Date
April 18, 1969

I hereby certify that the well location shown on this plat was derived from field notes of actual surveys made by me or under my supervision, and that the same is true and correct to the best of my knowledge and belief.

APRIL 15, 1969

Date Surveyed

Registered Professional Engineer
 and/or Land Surveyor

John W. West

Certificate No. **676**

N. O. C. C. COPY (Submit in triplicate to appropriate
Regional Oil and Gas or Mining Supervisor)

HOBBS OFFICE O. C. C.

APR 23 11 30 AM 1969

DESIGNATION OF OPERATOR

The undersigned is, on the records of the Bureau of Land Management, holder of lease

DISTRICT LAND OFFICE: **New Mexico**
SERIAL No.: **ML-028083**

and hereby designates

NAME: **Southern Minerals Corporation**
ADDRESS: **P. O. Box 716, Corpus Christi, Texas 78403**

as his operator and local agent, with full authority to act in his behalf in complying with the terms of the lease and regulations applicable thereto and on whom the supervisor or his representative may serve written or oral instructions in securing compliance with the Operating Regulations with respect to (describe acreage to which this designation is applicable):

Township 2 South, Range 31 East, NPM

Section 6: Lot 7, SW 1/4, NW 1/4
Section 7: Lots 1, 2, NW 1/4

Containing 446.57 acres, more or less.

It is understood that this designation of operator does not relieve the lessee of responsibility for compliance with the terms of the lease and the Operating Regulations. It is also understood that this designation of operator does not constitute an assignment of any interest in the lease.

In case of default on the part of the designated operator, the lessee will make full and prompt compliance with all regulations, lease terms, or orders of the Secretary of the Interior or his representative.

The lessee agrees promptly to notify the supervisor of any change in the designated operator.

April 7, 1969

(Date)

Ramon A. ...
(Signature of lessee)
Mason V. Harwood

P. O. Box 1714, Roswell, N. M. 88201

(Address)