

NO. OF COPIES RECEIVED	
DISTRIBUTION	
SANTA FE	
FILE	
U.S.G.S.	
LAND OFFICE	
OPERATOR	

NEW MEXICO OIL CONSERVATION COMMISSION

MAY 15 7 39 AM '69

Form C-101  
Revised 1-1-65

5A. Indicate Type of Lease	
STATE <input type="checkbox"/>	FEE <input checked="" type="checkbox"/>

5. State Oil & Gas Lease No.

APPLICATION FOR PERMIT TO DRILL, DEEPEN, OR PLUG BACK

1a. Type of Work	
DRILL <input checked="" type="checkbox"/>	DEEPEN <input type="checkbox"/>
b. Type of Well	
OIL WELL <input checked="" type="checkbox"/>	GAS WELL <input type="checkbox"/>
OTHER <input type="checkbox"/>	
SINGLE ZONE <input checked="" type="checkbox"/>	
MULTIPLE ZONE <input type="checkbox"/>	

7. Unit Agreement Name

8. Farm or Lease Name

BASKETT "D"

9. Well No.

7

10. Field and Pool, or Wildcat

CATO San Andres

2. Name of Operator

PAN AMERICAN PETROLEUM CORPORATION

3. Address of Operator

BOX 68, HOBBS, N. M. 88240

4. Location of Well

UNIT LETTER P LOCATED 330 FEET FROM THE SOUTH LINE AND 990 FEET FROM THE EAST LINE OF SEC. 11 TWP. 8-S RGE. 30-E NMPM

12. County

CHAVES

19. Proposed Depth	19A. Formation	20. Rotary or C.T.
3700'	SAN ANDRES	ROTARY
21. Elevations (Show whether DF, RT, etc.)	21A. Kind & Status Plug. Bond	21B. Drilling Contractor
	BLANKET - ON FILE	ARD DrLG Co.
		22. Approx. Date Work will start
		8-1-69

PROPOSED CASING AND CEMENT PROGRAM

SIZE OF HOLE	SIZE OF CASING	WEIGHT PER FOOT	SETTING DEPTH	SACKS OF CEMENT	EST. TOP
12 1/4 - 11"	8 5/8"	24"	300'	circulate	Surface
7 7/8"	4 1/2"	9.5"	3700'	150 Sx.	600' above
					par

8 5/8

8-19-69

IN ABOVE SPACE DESCRIBE PROPOSED PROGRAM: IF PROPOSAL IS TO DEEPEN OR PLUG BACK, GIVE DATA ON PRESENT PRODUCTIVE ZONE AND PROPOSED NEW PRODUCTIVE ZONE. GIVE BLOWOUT PREVENTER PROGRAM, IF ANY.

I hereby certify that the information above is true and complete to the best of my knowledge and belief.

Signed Area Foreman Title AREA FOREMAN Date MAY 15 1969

APPROVED BY [Signature] TITLE SUPERVISOR DISTRICT 1 DATE MAY 18 1969

CONDITIONS OF APPROVAL, IF ANY:

ON 4-NM OCC. H  
1-N SW  
1-S USP

NEW MEXICO OIL CONSERVATION COMMISSION  
WELL LOCATION AND ACREAGE DEDICATION PLAT

Form C-102  
Supersedes C-128  
Effective 1-1-65

All distances must be from the outer boundaries of the Section

Operator <b>PAN AMERICAN PETROLEUM CORP.</b>		Lease <b>MAY 16 7 39 AM '69 BASKETT</b>		Well No. <b>7</b>
Unit Letter <b>P</b>	Section <b>11</b>	Township <b>8 SOUTH</b>	Range <b>30 EAST</b>	County <b>CHAVES</b>
Actual Footage Location of Well: <b>330</b> feet from the <b>SOUTH</b> line and <b>990</b> feet from the <b>EAST</b> line				
Ground Level Elev.	Producing Formation <b>SAN ANDRES</b>	Pool <b>CATO San Amaris</b>	Dedicated Acreage: <b>40</b> Acres	

1. Outline the acreage dedicated to the subject well by colored pencil or hachure marks on the plat below.
2. If more than one lease is dedicated to the well, outline each and identify the ownership thereof (both as to working interest and royalty).
3. If more than one lease of different ownership is dedicated to the well, have the interests of all owners been consolidated by communitization, unitization, force-pooling, etc?

☐ Yes ☐ No If answer is "yes," type of consolidation \_\_\_\_\_

If answer is "no," list the owners and tract descriptions which have actually been consolidated. (Use reverse side of this form if necessary.) \_\_\_\_\_

No allowable will be assigned to the well until all interests have been consolidated (by communitization, unitization, forced-pooling, or otherwise) or until a non-standard unit, eliminating such interests, has been approved by the Commission.

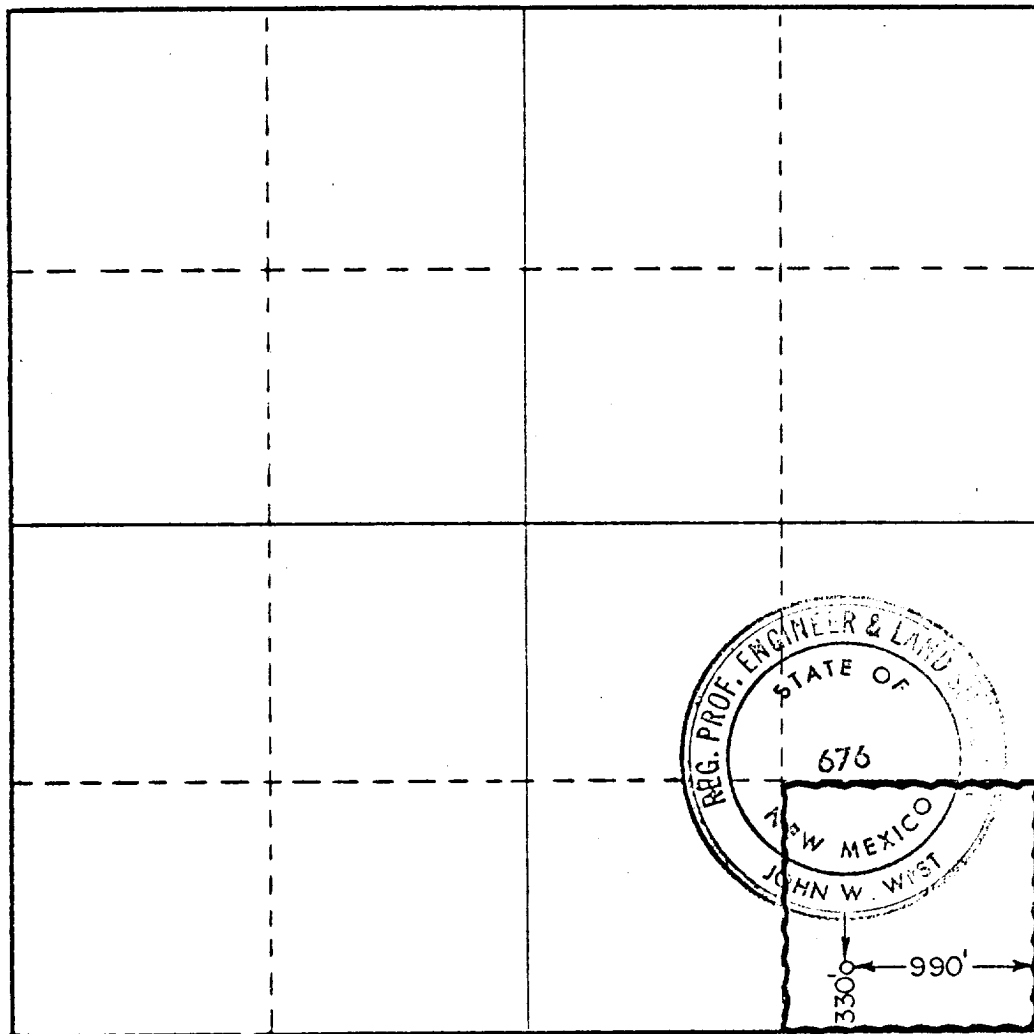

CERTIFICATION

I hereby certify that the information contained herein is true and complete to the best of my knowledge and belief.

Name

*John W. West*

Position

**AREA FOREMAN**

Company

**PAN AMERICAN PETROLEUM CORPORATION**

Date

**MAY 15 1969**

I hereby certify that the well location shown on this plat was plotted from field notes of actual surveys made by me or under my supervision, and that the same is true and correct to the best of my knowledge and belief.

Date Surveyed

**MAY 7, 1969**

Registered Professional Engineer and/or Land Surveyor

*John W. West*

Certificate No.

**676**

0 230 460 690 920 1150 1380 1610 1840 2070 2300 2530 2760 3000