

NO. OF COPIES RECEIVED	
DISTRIBUTION	
SANTA FE	
FILE	
U.S.G.S.	
LAND OFFICE	
OPERATOR	

NEW MEXICO OIL CONSERVATION COMMISSION

OCT 23 1970

Form C-191
Revised 1-4-65

5A. Indicate Type of Lease
STATE <input type="checkbox"/> FEE <input checked="" type="checkbox"/>
5. State Oil & Gas Lease No.

APPLICATION FOR PERMIT TO DRILL, DEEPEN, OR PLUG BACK

1a. Type of Work		DRILL <input checked="" type="checkbox"/> DEEPEN <input type="checkbox"/> PLUG BACK <input type="checkbox"/>	
b. Type of Well		OIL WELL <input checked="" type="checkbox"/> GAS WELL <input type="checkbox"/> OTHER <input type="checkbox"/>	
2. Name of Operator		S.P. Yates	
3. Address of Operator		207 So. 4th Street, Artesia, New Mexico 88210	
4. Location of Well		UNIT LAYER M LOCATED 660 FEET FROM THE South LINE	
AND 660 FEET FROM THE West LINE OF SEC. 3 TWP. 13S RGE. 31E NMPM			
12. County		Chaves	
19. Proposed Depth		2750	
19A. Formation		Queen	
20. Rotary or C.T.		Rotary	
21. Elevations (Show whether DF, RT, etc.)		GL 4138'	
21A. Kind & Status Plug. Bond		Blanket Bond	
21B. Drilling Contractor		Unknown	
22. Approx. Date Work will start		When approved	

PROPOSED CASING AND CEMENT PROGRAM

SIZE OF HOLE	SIZE OF CASING	WEIGHT PER FOOT	SETTING DEPTH	SACKS OF CEMENT	EST. TOP
11"	8-5/8"	24"	350	Circulate	
7-7/8"	5 1/2" or 4 1/2"	14"	2750	200	1600 to 1800

Propose to drill well to test the Queen Formation, which is expected at approximately 2685'. Estimated TD is 2750'. If oil production is encountered, will run 5-1/2" production string to TD; if gas is encountered, will run 4-1/2" production string to TD. Will use 8-5/8" API 900 Series, double ram blowout preventer below surface casing.

DATE OF PERMIT 8/3/8
CASH.

NO. 10041 VALID
DATE OF PERMIT 8/3/8
DATE OF COMMENCED,

FILE NO. 1-26-71

IN ABOVE SPACE DESCRIBE PROPOSED PROGRAM: IF PROPOSAL IS TO DEEPEN OR PLUG BACK, GIVE DATA ON PRESENT PRODUCTIVE ZONE AND PROPOSED NEW PRODUCTIVE ZONE. GIVE BLOWOUT PREVENTER PROGRAM, IF ANY.

I hereby certify that the information above is true and complete to the best of my knowledge and belief.

Signed [Signature] Title Engineer Date October 23, 1970

(This space for State Use)

APPROVED BY [Signature] TITLE [Signature] DATE 10/23/1970

CONDITIONS OF APPROVAL, IF ANY:

NEW MEXICO OIL CONSERVATION COMMISSION
WELL LOCATION AND ACREAGE DEDICATION PLAT

Form C-102
Supersedes C-128
Effective 1-1-65

All distances must be from the outer boundaries of the Section.

Operator S. P. Yates		Lease Phyllis		Well No. 1	
Unit Letter M	Section 5	Township 13N	Range 13E	County Chaves	
Actual Footage Location of Well: 0 feet from the 13N line and 0 feet from the 13E line					
Ground Level Elev. 4138	Producing Formation Queen		Pool Wildcat	Dedicated Acreage: 40 Acres	

1. Outline the acreage dedicated to the subject well by colored pencil or hachure marks on the plat below.
2. If more than one lease is dedicated to the well, outline each and identify the ownership thereof (both as to working interest and royalty).
3. If more than one lease of different ownership is dedicated to the well, have the interests of all owners been consolidated by communitization, unitization, force-pooling, etc?

☐ Yes ☐ No If answer is "yes," type of consolidation _____

If answer is "no," list the owners and tract descriptions which have actually been consolidated. (Use reverse side of this form if necessary.) _____

No allowable will be assigned to the well until all interests have been consolidated (by communitization, unitization, forced-pooling, or otherwise) or until a non-standard unit, eliminating such interests, has been approved by the Commission.

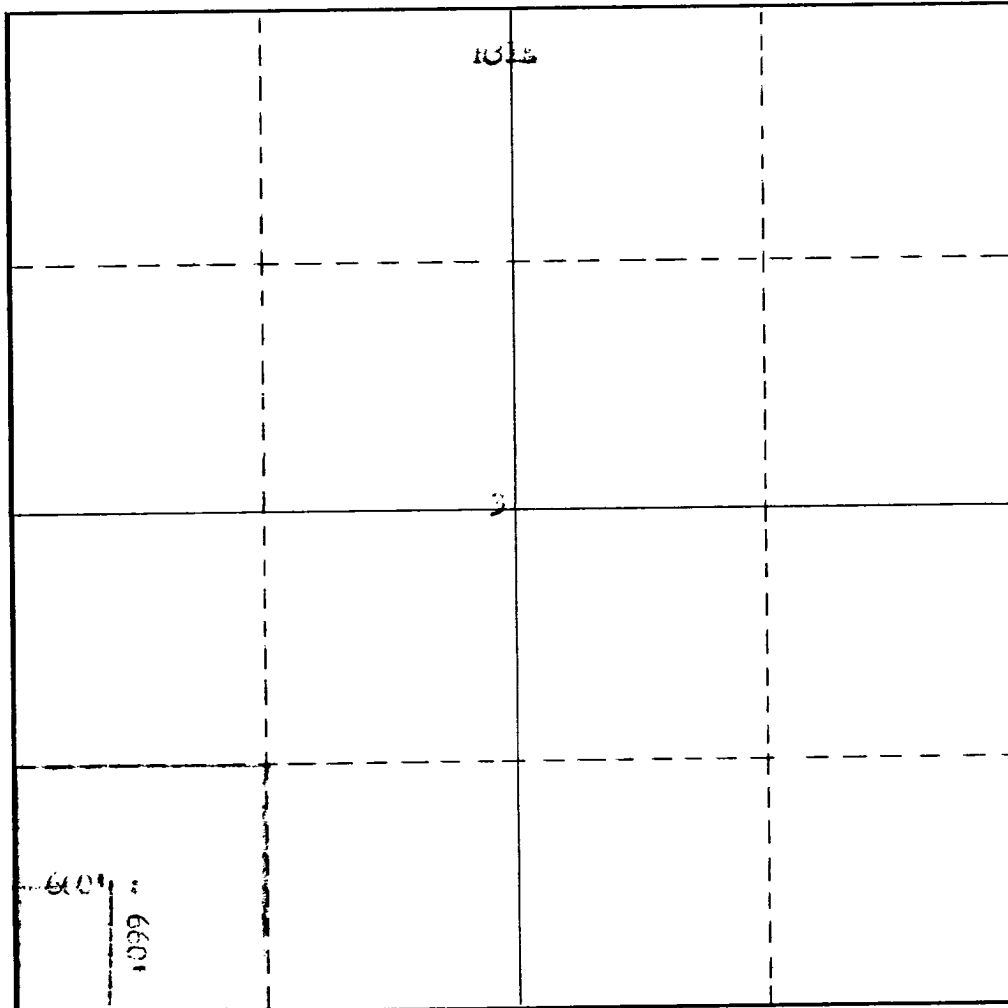

CERTIFICATION

I hereby certify that the information contained herein is true and complete to the best of my knowledge and belief.

Name

Peyton Yates

Position

Peyton Yates
Engineer

Company

S.P. Yates

Date

October 23, 1970

I hereby certify that the well location shown on this plat was plotted from field notes of actual survey made by me or under my supervision, and that the same is true and correct to the best of my knowledge and belief.

Date Surveyed

October 23, 1970

Registered Professional Engineer and/or Land Surveyor

Certificate No.

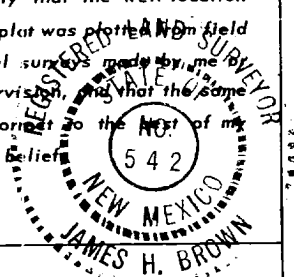

173

RECEIVED

SEP 2 1970

OIL CONSERVATION COMM.
HOUSTON, TEX.