

(May 1965)

N. M. O. C. C. COPY

(Other instructive reverse side)

Budget Bureau No. 42-R1425.

UNITED STATES
DEPARTMENT OF THE INTERIOR
GEOLOGICAL SURVEY

APPLICATION FOR PERMIT TO DRILL, DEEPEN, OR PLUG BACK

1a. TYPE OF WORK

DRILL ☒DEEPEN ☐PLUG BACK ☐

b. TYPE OF WELL

OIL WELL ☒GAS WELL ☐OTHER ☐SINGLE ZONE ☐MULTIPLE ZONE ☐

2. NAME OF OPERATOR

JACK F. GRIMM

3. ADDRESS OF OPERATOR

P. O. BOX 35 ABILENE, TEXAS 79604

4. LOCATION OF WELL (Report location clearly and in accordance with any State requirements.)*

At surface 660' from North line and 1,980' from East line of Section 28

At proposed prod. zone

Queen Sand

14. DISTANCE IN MILES AND DIRECTION FROM NEAREST TOWN OR POST OFFICE*

25 miles east of Hagerman

16. DISTANCE FROM PROPOSED* LOCATION TO NEAREST PROPERTY OR LEASE LINE, FT. (Also to nearest drlg. unit line, if any) 660' from North line

18. NO. OF ACRES IN LEASE

1120/80

18. DISTANCE FROM PROPOSED LOCATION* TO NEAREST WELL, DRILLING, COMPLETED, OR APPLIED FOR, ON THIS LEASE, FT. 1,320'

19. PROPOSED DEPTH

2,400'

21. ELEVATIONS (Show whether DF, RT, GR, etc.)

3,890.6 GR

23.

PROPOSED CASING AND CEMENTING PROGRAM

SIZE OF HOLE	SIZE OF CASING	WEIGHT PER FOOT	SETTING DEPTH	QUANTITY OF CEMENT
10 1/4	8 5/8	24#	300	300 Sx
8	4 1/2	9.5#	2,400	150 Sx

IN ABOVE SPACE DESCRIBE PROPOSED PROGRAM: If proposal is to deepen or plug back, give data on present productive zone and proposed new productive zone. If proposal is to drill or deepen directionally, give pertinent data on subsurface locations and measured and true vertical depths. Give blowout preventer program, if any.

24.

SIGNED

Jack F. Grimm

TITLE

Operator

DATE

March 1, 1971

(This space for Federal or State office use)

PERMIT NO.

APPROVAL DATE

APPROVED BY
CONDITIONS OF APPROVAL, IF ANY:APPROVED
MAR 12 1971
H. L. BEEKMAN
ACTING DISTRICT ENGINEER

TITLE

THIS APPROVAL IS REVOKED IF OPERATIONS
ARE NOT COMMENCED WITHIN 3 MONTHS.
EXPIRES JUN 12 1971
See Instructions On Reverse Side

5. LEASE DESIGNATION AND SERIAL NO.

0343765-A

6. IF INDIAN, ALLOTTEE OR TRIBE NAME

CON. AGREEMENT NAME

7. FARM OR LEASE NAME

Federal 28

8. WELL NO.

3

10. FIELD AND POOL, OR WILDCAT

Unnamed

11. SEC., T., R., M., OR BLK. AND SURVEY OR AREA

Sec. 28, T. 14S, R. 30E

12. COUNTY OR PARISH

Chaves

13. STATE

New Mexico

17. NO. OF ACRES ASSIGNED TO THIS WELL

40

20. ROTARY OR CABLE TOOLS

Cable tools

22. APPROX. DATE WORK WILL START*

March 15, 1971

RECEIVED
MAR 3 1971
GEOLOGICAL SURVEY
NEW MEXICO

RECEIVED

MAY 1 1967
OIL CONSERVATION COMM.
WASHINGTON, D. C.

NEW MEXICO OIL CONSERVATION COMMISSION
WELL LOCATION AND ACREAGE DEDICATION PLAT

Form C-102
Supersedes C-128
Effective 1-1-65

All distances must be from the outer boundaries of the Section.

Operator JACK F. GRIMM		Lease FEDERAL 28		Well No. 3
Unit Letter B	Section 28	Township 14 SOUTH	Range 30 EAST	County CHAVES
Actual Footage Location of Well: 660 feet from the NORTH line and 1980 feet from the EAST line				
Ground Level Elev. 3890.6	Producing Formation	Pool	Dedicated Acreage: Acres	

1. Outline the acreage dedicated to the subject well by colored pencil or hatchure marks on the plat below.
2. If more than one lease is dedicated to the well, outline each and identify the ownership thereof (both as to working interest and royalty).
3. If more than one lease of different ownership is dedicated to the well, have the interests of all owners been consolidated by communitization, unitization, force-pooling, etc?

☐ Yes ☐ No If answer is "yes," type of consolidation _____

If answer is "no," list the owners and tract descriptions which have actually been consolidated. (Use reverse side of this form if necessary.) _____

No allowable will be assigned to the well until all interests have been consolidated (by communitization, unitization, forced-pooling, or otherwise) or until a non-standard unit, eliminating such interests, has been approved by the Commission.

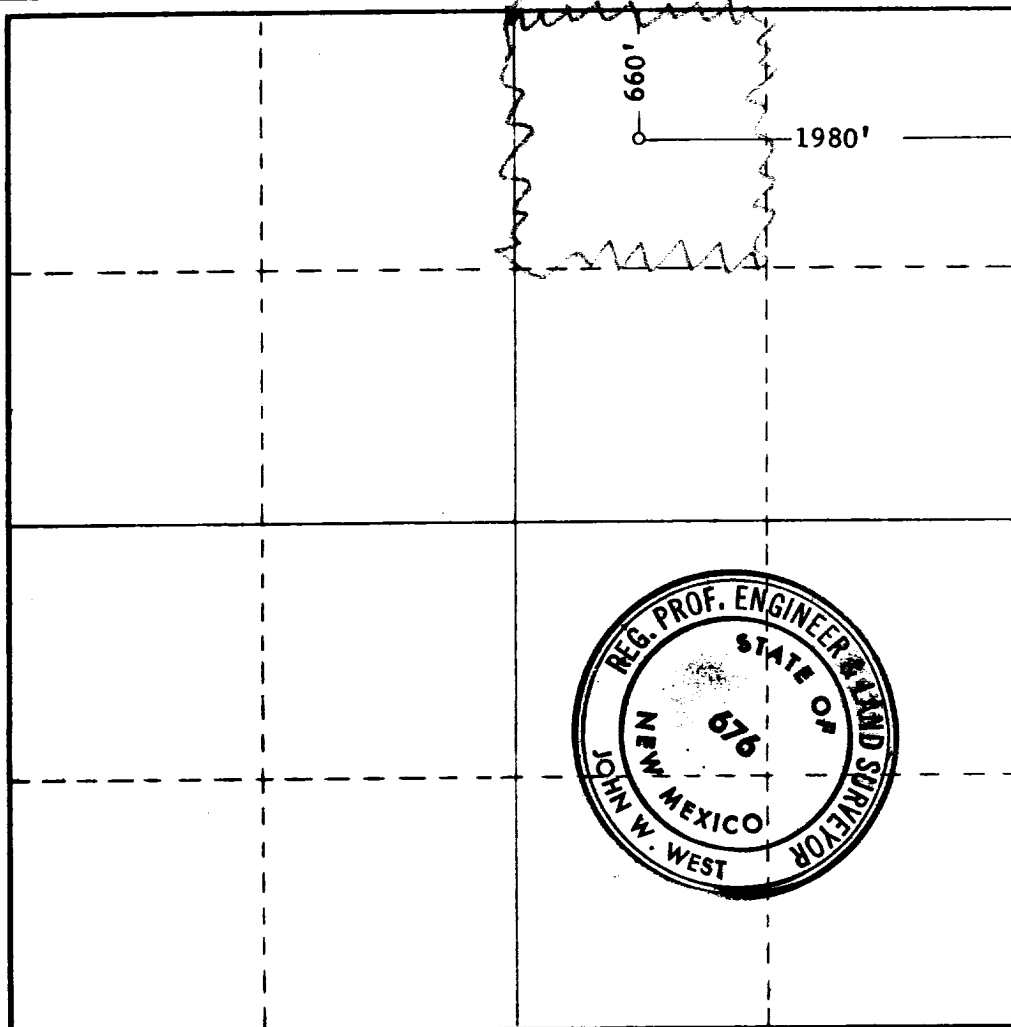

CERTIFICATION

I hereby certify that the information contained herein is true and complete to the best of my knowledge and belief.

Name *Jack F. Grimm*
Position **Operator**

Company **Jack F. Grimm**

Date **March 1, 1971**

RECEIVED
MAR 3 1971

I hereby certify that the well location shown on this plat was located from field notes of actual survey made under U. S. GEOLOGICAL SURVEY ARTESIA NEW MEXICO is true and correct to the best of my knowledge and belief.

Date Surveyed **2-25-1971**

Registered Professional Engineer and/or Land Surveyor

John W. West
Certificate No. **676**

RECEIVED

MAY 1 1971

OIL CONSERVATION COMM.
10330, K. L.