

NO. OF COPIES RECEIVED	
DISTRIBUTION	
SANTA FE	
FILE	
U.S.G.S.	
LAND OFFICE	
OPERATOR	

# NEW MEXICO OIL CONSERVATION COMMISSION

Form C-101  
Revised 1-1-65

5A. Indicate Type of Lease	
STATE <b>3</b>	FEE <input type="checkbox"/>
5. State Oil & Gas Lease No. <b>K 4895</b>	

## APPLICATION FOR PERMIT TO DRILL, DEEPEN, OR PLUG BACK

1a. Type of Work <b>X</b>		7. Unit Agreement Name	
b. Type of Well OIL WELL <input checked="" type="checkbox"/> GAS WELL <input type="checkbox"/> OTHER <input type="checkbox"/>		8. Farm or Lease Name <b>Sheldon</b>	
2. Name of Operator <b>Ray Farr</b>		9. Well No. <b>1</b>	
3. Address of Operator <b>Box 1650 Lubbock, Texas</b>		10. Field and Pool, or Wildcat <b>Wildcat</b>	
4. Location of Well UNIT LETTER <b>P</b> LOCATED <b>660'</b> FEET FROM THE <b>South</b> LINE <b>660'</b> <b>East</b> <b>36</b> <b>14S</b> <b>30E</b>		12. County <b>Chaves</b>	
19. Proposed Depth <b>2750'</b>		19A. Formation <b>2750' Queen</b>	
21. Elevation (Spot, High, DE, RT, etc.) <b>GL 4113.02'</b>		21A. Kind & Status of Bond <b>Blanket Bond</b>	
22. Drilling Contractor <b>Fred Pool</b>		23. Date Work will start <b>4/6/71</b>	

## PROPOSED CASING AND CEMENT PROGRAM

SIZE OF HOLE	SIZE OF CASING	WEIGHT PER FOOT	SETTING DEPTH	SACKS OF CEMENT	EST. TOP
13"	10 3/4"	32LB	Approx 300'	Circulate	
8"	5 1/2"	15 1/2 LB	Approx 2,750'	150 sacks	2,600'

Control head to be used if needed

7-21-71

IN ABOVE SPACE DESCRIBE PROPOSED PROGRAM: IF PROPOSAL IS TO DEEPEN OR PLUG BACK, GIVE DATA ON PRESENT PRODUCTIVE ZONE AND PROPOSED NEW PRODUCTIVE ZONE. GIVE BLOWOUT PREVENTER PROGRAM, IF ANY.

I hereby certify that the information above is true and complete to the best of my knowledge and belief.

Signed *J. S. Walker* Title **General Manager** Date **4/6/71**

(This space for State Use)

APPROVED BY *[Signature]* TITLE **SUPERVISOR DISTRICT** DATE **APR 21 1971**

CONDITIONS OF APPROVAL, IF ANY:

RECEIVED

APR 11 1971

OIL CONSERVATION COMM.  
HOUS. ST. 11

RECEIVED

APR 10 1971

OIL CONSERVATION COMM.  
HOUS. ST. 11

NEW MEXICO OIL CONSERVATION COMMISSION  
WELL LOCATION AND ACREAGE DEDICATION PLAT

Form C-102  
Supersedes C-128  
Effective 1-1-65

All distances must be from the outer boundaries of the Section.

Operator <b>Roy Furr</b>			Lease <b>Sheldon-State</b>		Well No. <b>1</b>
Unit Letter <b>P</b>	Section <b>36</b>	Township <b>14 South</b>	Range <b>30 E</b>	County <b>Chaves</b>	
Actual Portage Location of Well:					
<b>660</b> feet from the <b>South</b> line and		<b>660</b> feet from the <b>East</b> line			
Ground Level Elev. <b>4113.02</b>	Producing Formation <b>Queen Sand</b>	Pool <b>Wildcat</b>	Dedicated Acreage: <b>40</b> Acres		

1. Outline the acreage dedicated to the subject well by colored pencil or hachure marks on the plat below.
2. If more than one lease is dedicated to the well, outline each and identify the ownership thereof (both as to working interest and royalty).
3. If more than one lease of different ownership is dedicated to the well, have the interests of all owners been consolidated by communitization, unitization, force-pooling, etc?

☐ Yes    ☐ No    If answer is "yes," type of consolidation \_\_\_\_\_

If answer is "no," list the owners and tract descriptions which have actually been consolidated. (Use reverse side of this form if necessary.) \_\_\_\_\_

No allowable will be assigned to the well until all interests have been consolidated (by communitization, unitization, forced-pooling, or otherwise) or until a non-standard unit, eliminating such interests, has been approved by the Commission.

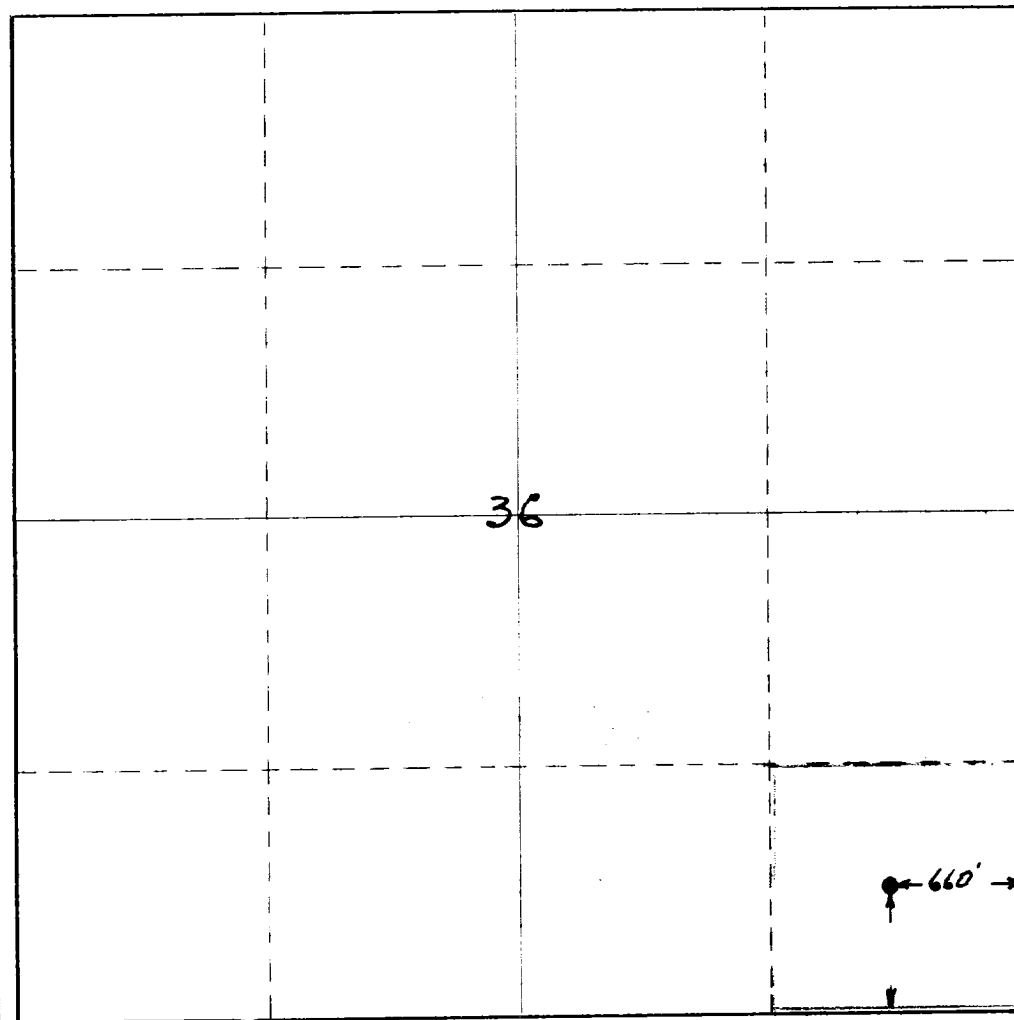

CERTIFICATION

I hereby certify that the information contained herein is true and complete to the best of my knowledge and belief.

Name *J. D. Walker*

Position  
**General Manager**

Company

Date **Roy Furr**

**April 6, 1971**

I hereby certify that the well location shown on this plat was plotted from field notes of actual surveys made by me or under my supervision, and that the same is true and correct to the best of my knowledge and belief.

Date Surveyed **Feb. 27, 1971**

Registered Professional Engineer and/or Land Surveyor

*Charles P. Miller*

Certificate No. **182**

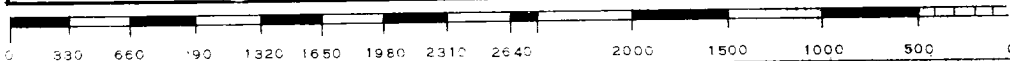

RECEIVED

APR 1 1971

OIL CONSERVATION COMM.  
HOUSTON, TEXAS

RECEIVED

APR 1 1971

OIL CONSERVATION COMM.  
HOUSTON, TEXAS